

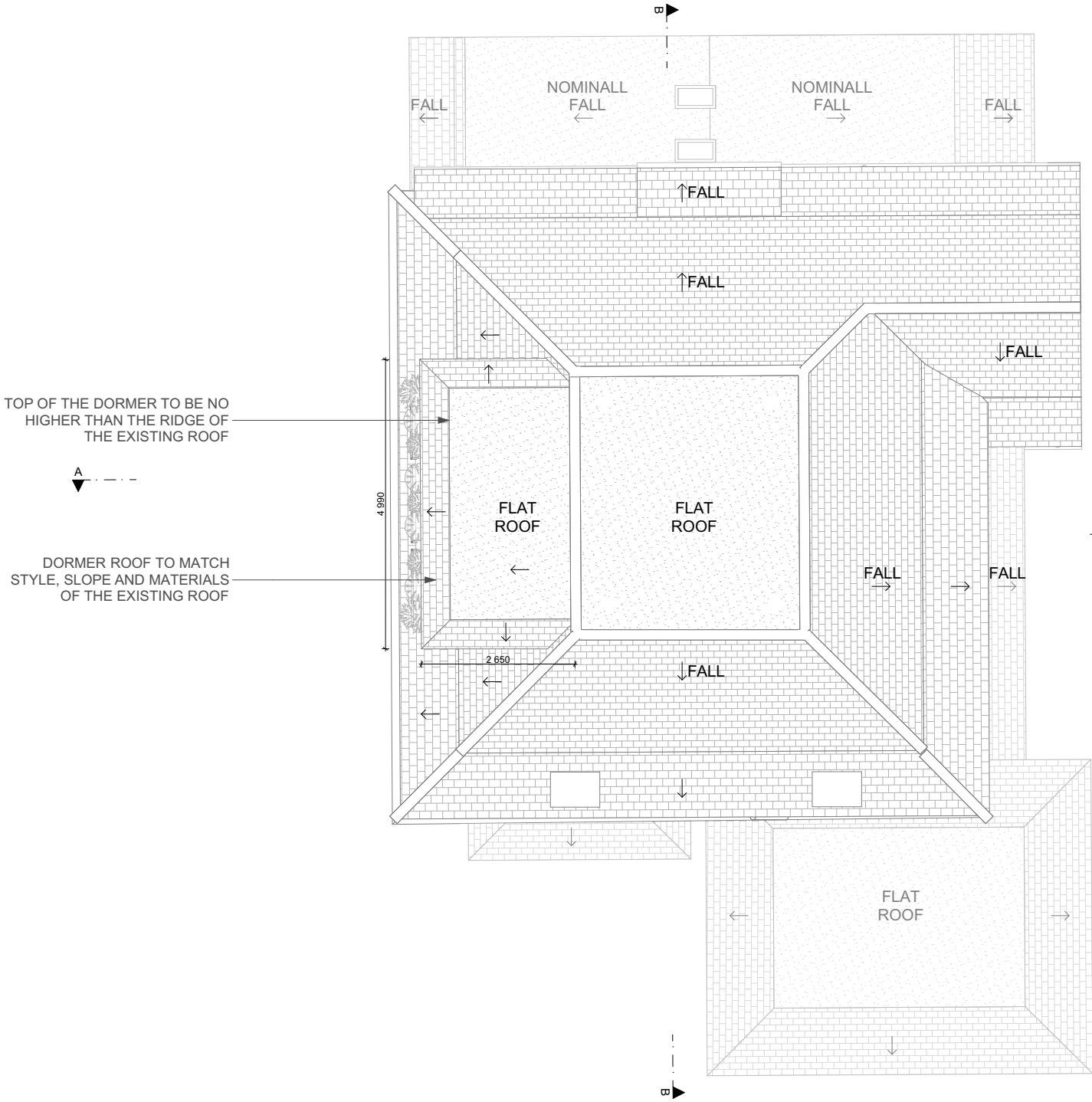

All dimensions to be checked on site. DO NOT SCALE FROM DRAWING. Discrepancies ambiguities and/or omissions between this drawing and information given elsewhere must be reported to the Architect immediately before proceeding.THIS DRAWING IS COPYRIGHT.

Revision	Description	Date
P1	Revised and issued to planning	23/11/07

Calculation of the added volume to demonstrate that the sum of the additions to the roof does not exceed the permitted limit of 50m3	
Approx. Volume [m3]	Part of the roof
11 m³	Proposed dormer



GA (0) 04

Roof Plan as Proposed

1:100

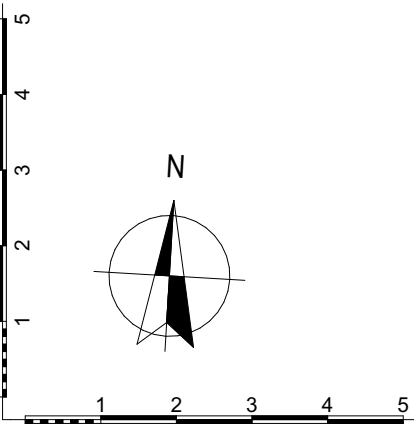

Scale: 1:100 @ A3
Date: November/2023
Drawing Status: Planning
Rev: P1
Drawn By: MS
Drawing Number: GA (0) 04

Project Title:
37 St Martins Approach,
Ruislip HA4 7QH
Drawing Title:
Roof Plan as Proposed

GK Architects Limited | London Office
Niddry Lodge | 51 Holland Street | London W8 7JB
T: 0203 280 3630 E: office@gkarchitects.co.uk
GK Architects Limited | Durham Office
Clavering House | Clavering Place | Newcastle upon Tyne NE1 3NG
T: 0191 666 0196 E: office@gkarchitects.co.uk
RIBA Chartered Practice
www.gkarchitects.co.uk

