

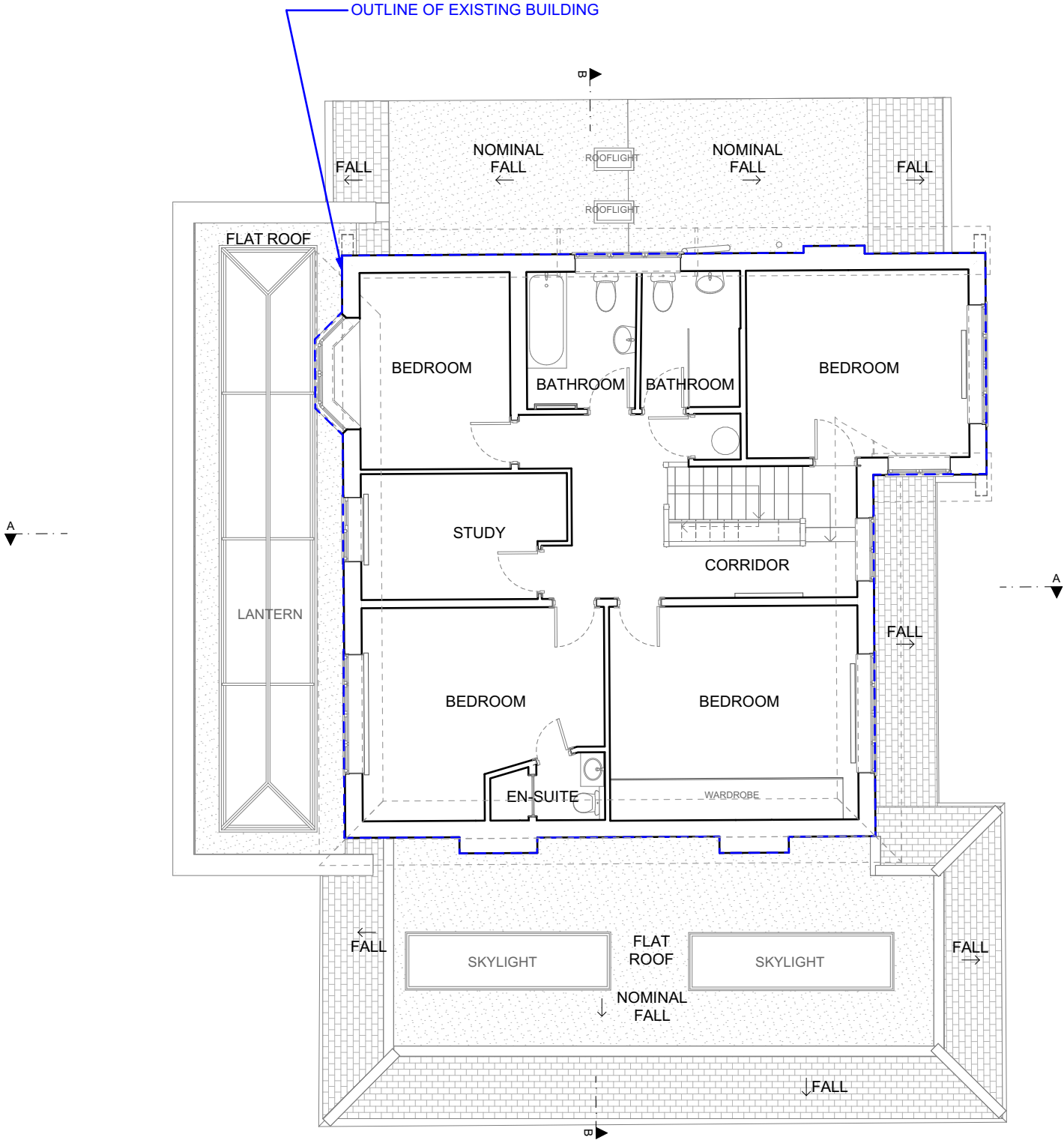

All dimensions to be checked on site. DO NOT SCALE FROM DRAWING. Discrepancies ambiguities and/or omissions between this drawing and information given elsewhere must be reported to the Architect immediately before proceeding. THIS DRAWING IS COPYRIGHT.

Revision	Description	Date



GA (0) 02

First Floor Plan as Proposed

1:100

KEY PLAN:

- EXISTING
- PROPOSED

Scale: 1:100 @ A3
Date: December/2022
Drawing Status: Planning
Rev: MS
Drawing Number: GA (0) 02

Project Title: 37 St Martins Approach, Ruislip HA4 7QH
Drawing Title: First Floor Plan as Proposed

GK Architects Limited | London Office
Niddry Lodge | 51 Holland Street | London W8 7JB
T: 0203 280 3630 E: office@gkarchitects.co.uk
GK Architects Limited | Durham Office
Clavering House | Clavering Place | Newcastle upon Tyne NE1 3NG
T: 0191 666 0196 E: office@gkarchitects.co.uk
RIBA Chartered Practice www.gkarchitects.co.uk

