

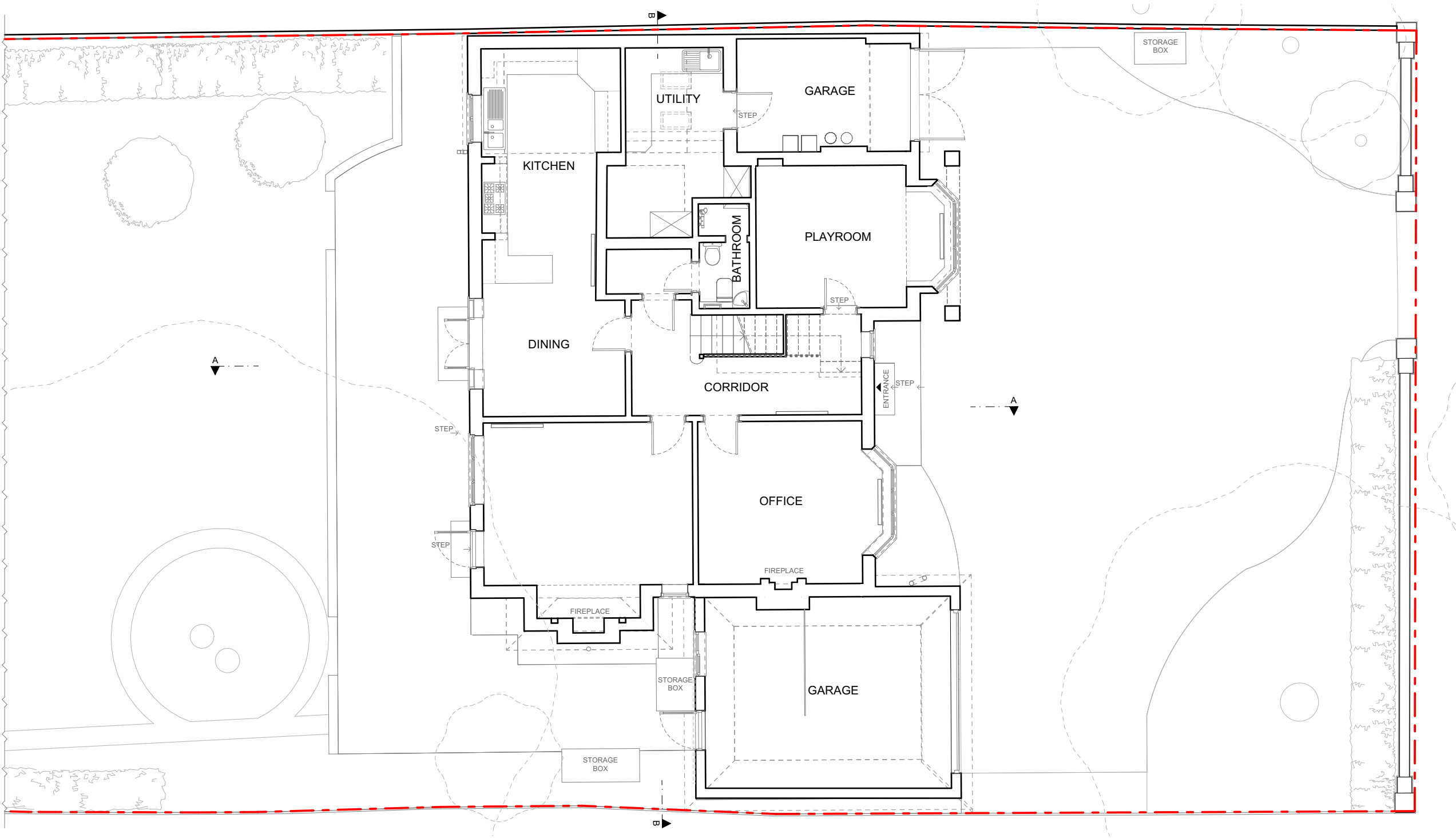

All dimensions to be checked on site. DO NOT SCALE FROM DRAWING. Discrepancies ambiguities and/or omissions between this drawing and information given elsewhere must be reported to the Architect immediately before proceeding. THIS DRAWING IS COPYRIGHT.

Revision	Description	Date



E (0) 01

Ground Floor Plan as Existing

1:100

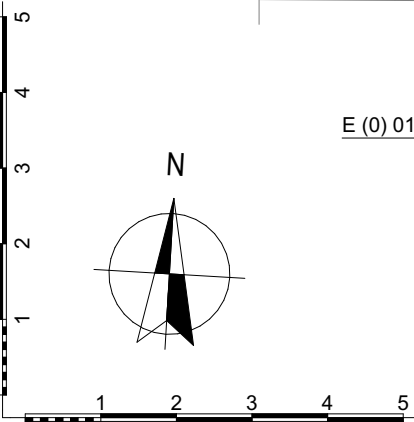

Scale: 1:100 @ A3	Date: December/2022	Drawing Status: Planning	Project Title: 37 St Martins Approach, Ruislip HA4 7QH
Rev:	Drawn By: MS	Drawing Number: E (0) 01	Drawing Title: Ground Floor Plan as Existing

GK Architects Limited | London Office
Niddy Lodge | 51 Holland Street | London W8 7JB
T: 0203 280 3630 E: office@gkarchitects.co.uk

GK Architects Limited | Durham Office
Clavering House | Clavering Place | Newcastle upon Tyne NE1 3NG
T: 0191 666 0196 E: office@gkarchitects.co.uk

RIBA Chartered Practice www.gkarchitects.co.uk

