

TREE CONSTRAINTS PLAN - Shurgard, Uxbridge Road, Hayes

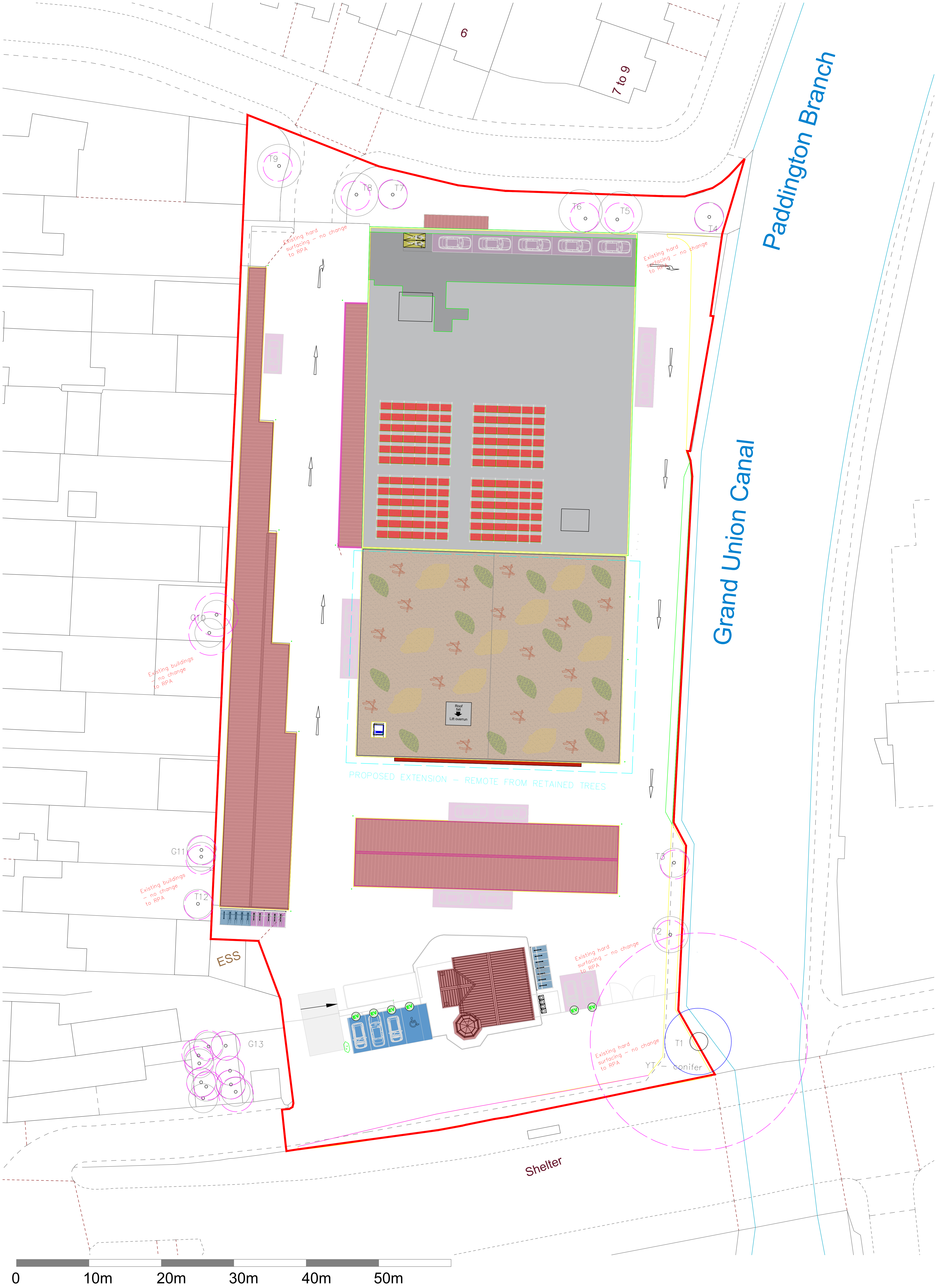

ARBORICULTURAL IMPACT SCHEDULE

Tree number	Species (common/botanical)	Stem (single/multi)	Stem diameter (mm)	Height (nearest >10m)	Crown spread (nearest 1/2m)	Crown clearance (m)	Life stage	SULE	Category	RPA radius (m)	Incursion (structures)	Incursion (landscaping)	Pruning requirements	Impact on tree	Mitigation
T1	Golden weeping willow/Salix x sepulcralis var. chrysozona	SS	1250	15	4.6	2	OM	10-20	B1	15	None	None	None	None	Retain existing hard surfacing as ground protection in accordance with BS 5837:2012
T2	Italian alder/Alnus cordata	SS	100e	14	2	2	EM	20-40	C1	2	None	None	None	None	Retain existing hard surfacing as ground protection in accordance with BS 5837:2012
T3	Sycamore/Acer pseudoplatanus	SS	100e	14	2	2	EM	20-40	C1	2	None	None	None	None	Retain existing hard surfacing as ground protection in accordance with BS 5837:2012
T4	Italian alder/Alnus cordata	SS	100	10	3	2	EM	20-40	C1	2	None	None	None	None	Retain existing hard surfacing as ground protection in accordance with BS 5837:2012
T5	Italian alder/Alnus cordata	SS	120	12	3	2	EM	20-40	C1	2	None	None	None	None	Retain existing hard surfacing as ground protection in accordance with BS 5837:2012
T6	Italian alder/Alnus cordata	SS	120	12	3	2	EM	20-40	C1	2	None	None	None	None	Retain existing hard surfacing as ground protection in accordance with BS 5837:2012
T7	Italian alder/Alnus cordata	SS	120	12	3	2	EM	20-40	C1	2	None	None	None	None	Retain existing hard surfacing as ground protection in accordance with BS 5837:2012
T8	Italian alder/Alnus cordata	MS	120	12	3	2	EM	20-40	C1	2	None	None	None	None	Retain existing hard surfacing as ground protection in accordance with BS 5837:2012
T9	Ash/Fraxinus excelsior	SS	100e	8	3	2	EM	20-40	C1	2	None	None	None	None	Retain existing hard surfacing as ground protection in accordance with BS 5837:2012
G10	Sycamore/Acer pseudoplatanus	SS	Est	15	3	2	M	20-40	C1	3	None	None	None	None	Retain existing hard surfacing as ground protection in accordance with BS 5837:2012
G11	Sycamore/Acer pseudoplatanus	SS	Est	15	3	2	M	20-40	C1	3	None	None	None	None	Retain existing hard surfacing as ground protection in accordance with BS 5837:2012
T12	Sycamore/Acer pseudoplatanus	SS	Est	15	3	2	M	20-40	C1	2	None	None	None	None	Retain existing hard surfacing as ground protection in accordance with BS 5837:2012
T13	Sycamore/Acer pseudoplatanus	MS	ave.200	16	3	1	M	20-40	C1	2.4	None	None	None	None	Retain existing hard surfacing as ground protection in accordance with BS 5837:2012

IMPACT SUMMARY

The proposed extension will not affect the root protection areas (RPA) of retained trees. All trees can be retained without need for pruning.

The existing hard surfacing within the car park and storage yard will remain unchanged - there is no predicted impact on retained trees.

Key

- T1 Stem position and tree number (stem diameter to scale)
  - Canopy spread of tree, colour coded according to BS 5837 category (below)
  - Notional Root Protection Area [RPA] as defined by BS 5837:2012
  - Proposal for extension
  - Site boundary in red
- BS 5837 Tree Quality Categorisation (from BS 5837:2012 Table 1)
- Category U: Trees in such condition that they cannot realistically be retained in their current context for longer than 10 years
  - Category A: Trees of high quality with an estimated life expectancy exceeding 40 years
  - Category B: Trees of moderate quality with an estimated life expectancy of at least 20 years
  - Category C: Trees of low quality with an estimated life expectancy of at least 10 years, or young trees with a stem diameter below 150mm

Client: ROC Planning/Shurgard

Project: Shurgard, Uxbridge Road

Title: TREE CONSTRAINTS PLAN

Date: 22/02/23 Scale: 1: 200 @ A0 (CHECK PRINTER SPEC)

Drawn: MW Checked: PW Client Ref:

Drawing Number: WLA/2107/03/TCP

Rev: B

WRIGHT

Landscape and Arboriculture Ltd  
Alpine Road, Redhill RH1 2HY  
01737 516054 or 07400500578  
office@wrightlandandarb.com  
www.wrightlandandarb.com

