

1 Proposed Front Elevation (Cycle Storage)
Scale 1:50

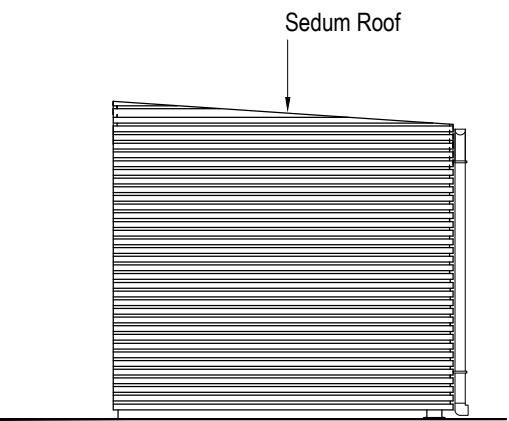

2 Proposed Side Elevation (Cycle Storage)
Scale 1:50

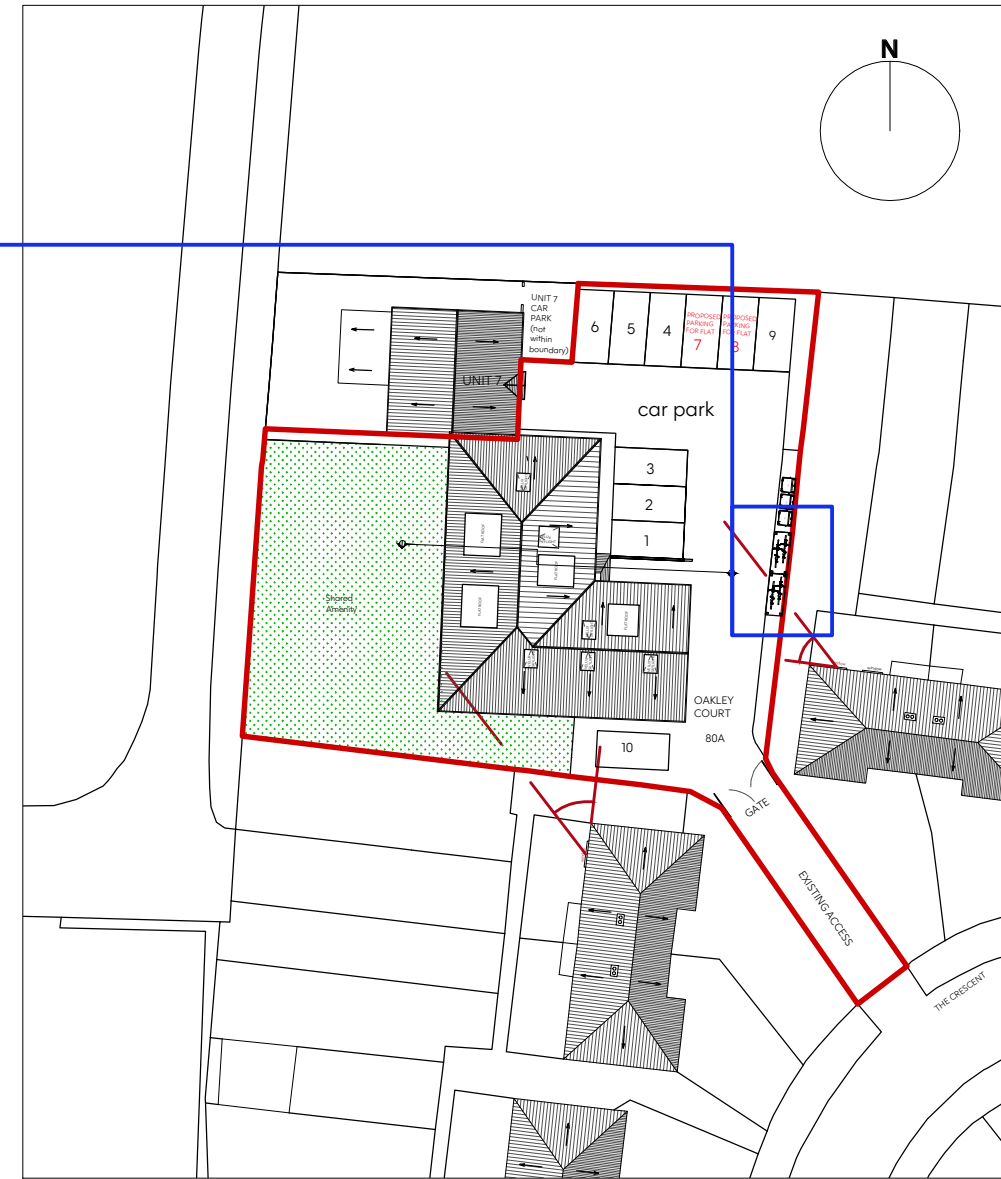

0 Proposed Key Plan
Scale 1:500

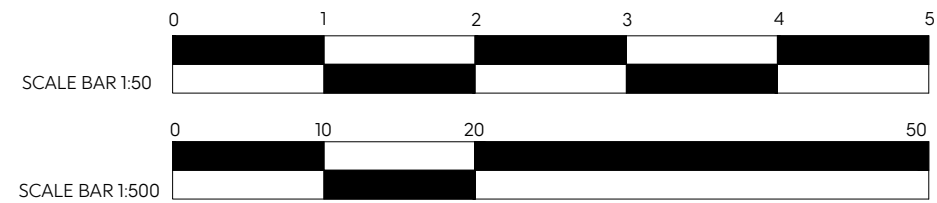

- Notes:
1. Drawing must be used solely for the status indicated only
 2. All dimensions and setting out shall be checked and confirmed and any discrepancies to be reported to the Architect prior to commencement of any work.
 3. This is a CAD Drawing. Under no circumstances shall manual alterations be made. Figured dimensions take preference to scale.
 4. All work and materials to be in accordance with current statutory legislation, relevant codes of practice and British Standards.
 5. Drawing to be read in accordance with relevant consultants and sub-contractors drawings and specifications.
- Disclaimer:
The hard copy accompanying the electronic date is the legal. Copyright is Reserved.

Copyright is Reserved.
© Copying or reproduction of this drawing or any electronic data without the written permission of 'Seesaw Studios' is not permitted. All rights reserved.

Rev:	Description:	Date:
A	Revised proposal & submission	21/06/23

Seesaw Studios

Albert House,
256-260 Old Street, London,
EC1V 9NN, United Kingdom

+44 (0) 20 7254 5671
seesaw-studios.com
info@seesaw-studios.com

Client:
Rouhi Marwan Al Khateeb

Project:
Oakley Court, 80A The Crescent,
Harlington, UB3 5NS

Drawing Title:
Cycle Parking Details

Date:	Drawing Status:
August 2023	Planning
Drawing Number:	Revision
SE 1607 - 11/P1	A
Scale:	Drawn By:
1:50 @ A3	TK