

**Disclaimer**  
 THE HARD COPY ACCOMPANYING THE ELECTRONIC DATA IS THE LEGAL TRANSMISSION OF INFORMATION. THE ELECTRONIC DATA ARE ISSUED ONLY FOR CONVENIENCE OF USE. NO RESPONSIBILITY FOR THE ACCURACY OR FOR ANY CONSEQUENCE RESULTING FROM THE USE OR ALTERATION OF THIS INFORMATION IS ACCEPTED.  
 THIS DRAWING IS SUBJECT TO CHANGE DURING THE DESIGN DEVELOPMENT PROCESS.  
 THIS DRAWING IS SUBJECT TO SURVEY AND STATUTORY APPROVALS. ALL DIMENSIONS ARE INDICATIVE ONLY AND ARE TO BE CONFIRMED ON SITE.  
 Copyright Is Reserved  
 COPYING OR REPRODUCTION OF THIS DRAWING OR ELECTRONIC DATA WITHOUT THE WRITTEN PERMISSION OF STUDIO MCH IS NOT PERMITTED.

**Note:**  
 Drawings based on survey by Ross Laird drawings:  
 3030-01, 3030-02

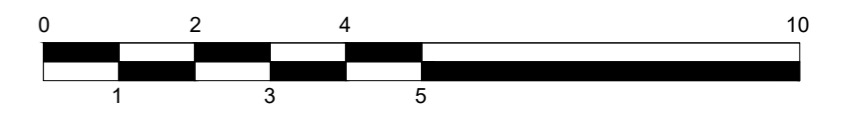
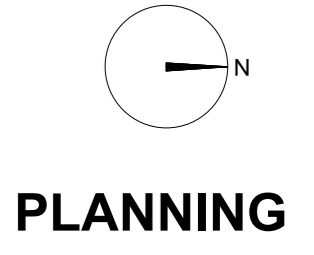
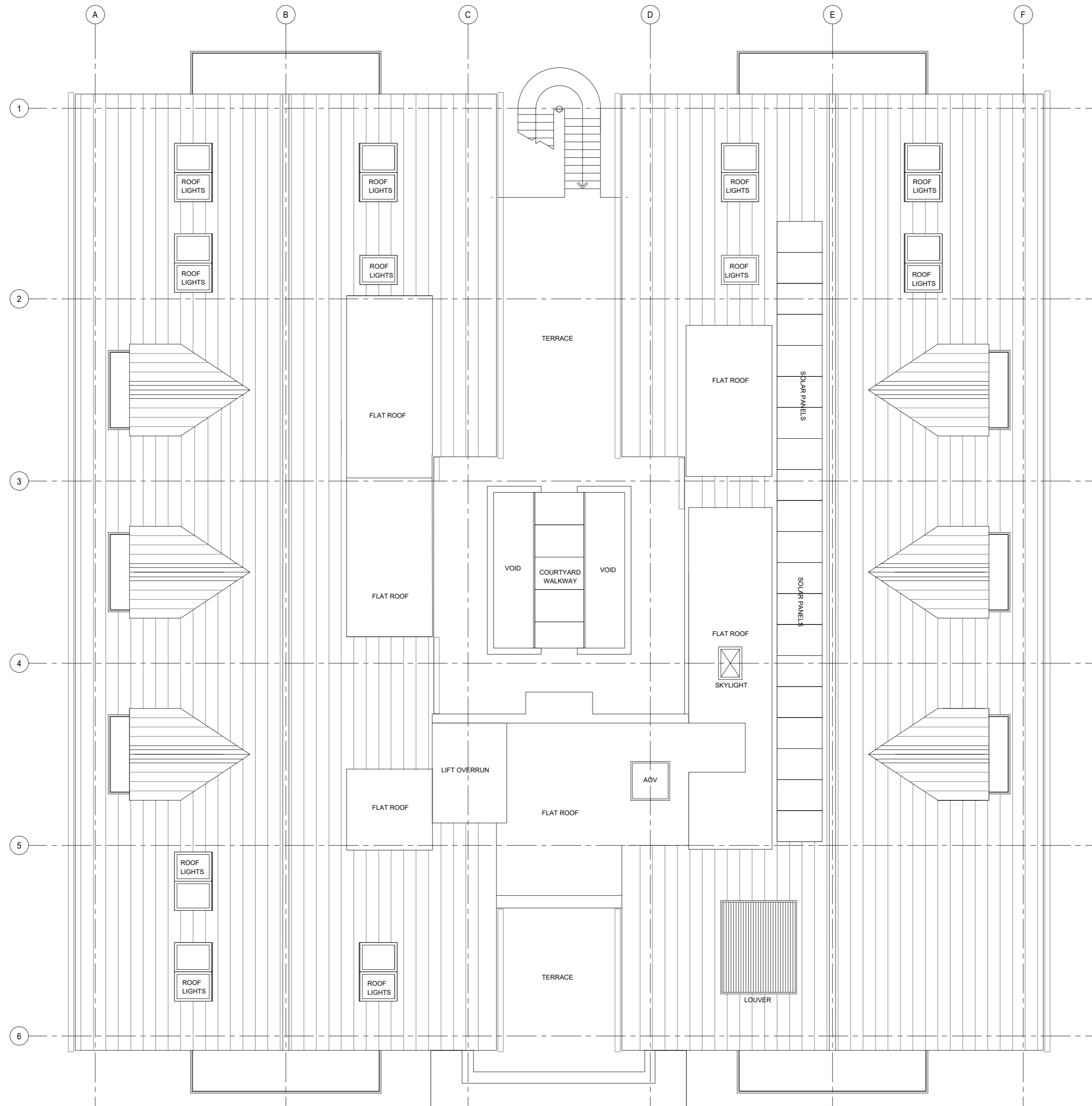

**PROPOSED  
 9 FLATS ROOF PLAN**

**ALLPORT HOUSE**  
 UXBRIDGE, LONDON UB8 2AD

Drawing Title: PROPOSED 9 FLATS ROOF PLAN

Scale: 1:100 @ A2

Date: JANUARY, 2020

Drawing Number: 4D\_1920\_PL\_612.3 C

**4P STUDIO**  
 Bedford House  
 Fulham Green  
 69-79 Fulham High Street  
 London SW6 3JW  
 t 020 7471 8550  
 e mail@architect.uk.com  
 www.4d-studio.co.uk