

Backfill around the sides of modular unit for 100 thickness using coarse sand or 6H selected granular material. Remaining excavated areas to be backfilled with class 6N or 6P granular material in accordance with MCHW volume 1 or similarly approved specification

Pipes connected to the attenuation tank using heavy duty pipe collars (inserted into the permeable membrane) with stainless steel strangle bands for fastening around the pipe

Protection fleece around tank/geomembrane  
- refer to manufacturers details

Impermeable/geomembrane  
- refer to manufacturers details

Aquacell crates. Modules to be interlinked in accordance with manufacturers specification

Air vent

750 minimum

Varies (refer to drainage layout drawing)

MODULAR ATTENUATION TANK DETAILS

LOCKABLE HINGED COVER,  
(CENTRE HINGED)

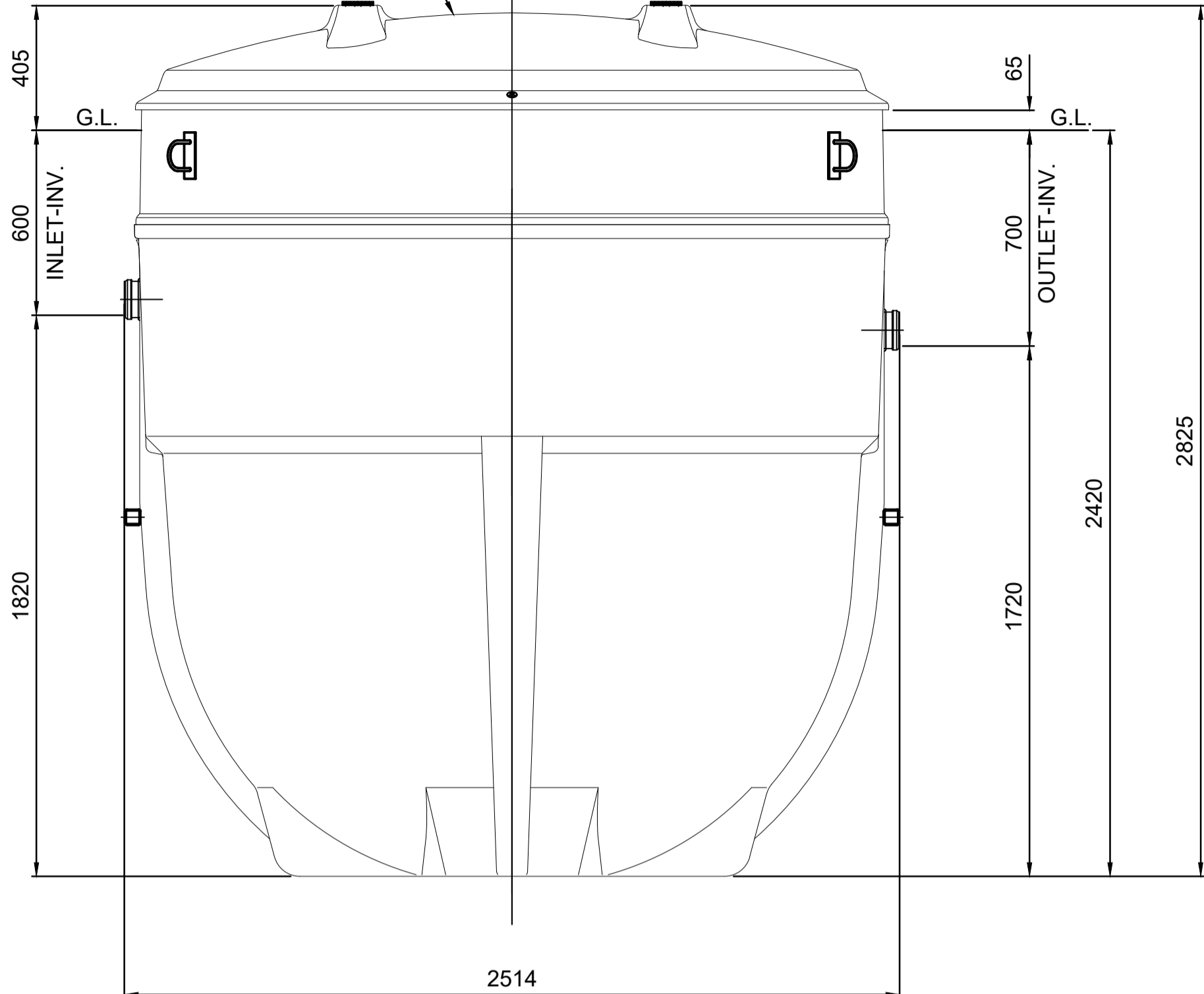

KINGSPAN KLARGESTER BIODISC - MODEL BF

NOTES

1. ALL DRAINAGE TO BE IN ACCORDANCE WITH BUILDING REGULATIONS DOCUMENT H.
2. CONTRACTOR SHALL CHECK THE LEVELS OF ALL EXISTING CONNECTIONS AS EARLY AS POSSIBLE AND REPORT ANY DISCREPANCIES TO THE ENGINEER.
3. WHERE CONNECTIONS TO WATER COURSES ARE REQUIRED WORK SHALL BE IN ACCORDANCE WITH AND INSPECTED BY THE RELEVANT LEAD LOCAL FLOOD AUTHORITY.
4. SHALLOW SEWERS AND SEWERS ADJACENT TO EXISTING AND PROPOSED TREES / DENSE VEGETATION WILL REQUIRE CONCRETE PROTECTION IN ACCORDANCE WITH THE DETAILS. ELSEWHERE PIPEWORK IS TO RECEIVE CLASS S BED AND SURROUND. BEDDING AND SURROUND MATERIAL SHALL MEET THE REQUIREMENTS OF THE PIPE MANUFACTURES RECOMMENDATIONS.
5. ALL UNDER-FLOOR FOUL DRAINS TO BE 1000 UNLESS SHOWN OTHERWISE.
6. SIZES OF RWP CONNECTIONS SHALL BE CHECKED AGAINST THE SPECIALIST RAINWATER GOODS SUPPLIERS INFORMATION.
7. PIPEWORK CONNECTIONS TO MANHOLES ARE TO BE LAID SOFFIT TO SOFFIT.
8. VITRIFIED CLAY PIPES AND FITTINGS FOR GRAVITY SEWERS SHALL HAVE FLEXIBLE MECHANICAL JOINTS. PIPES SHALL COMPLY WITH THE RELEVANT REQUIREMENTS OF BS EN 295-1 AND BS 65 (SURFACE WATER PIPES ONLY). THERMOPLASTIC STRUCTURED WALL SEWER PIPE SHALL COMPLY WITH THE RELEVANT PROVISIONS OF BS EN 13476-1 AND WIS 4-35-01 AND BS EN 13476-2 OR BS EN 13476-3. PIPES SHALL BE BSI KITEMARKED OR HAVE THE EQUIVALENT THIRD PARTY CERTIFICATION EG OSMA DRAIN FOR PIPES <160mmØ OR OSMA ULTRARIB FOR PIPES >160mmØ.
9. ABANDONED SEWERS SHALL BE REMOVED OR GROUTED OVER THE FULL LENGTH AND ABANDONED MANHOLES SHALL BE BROKEN OUT AND BACK FILLED WITH LEAN MIX CONCRETE TO 1.5m BELOW GROUND LEVEL.
10. PIPE TO PIPE CONNECTIONS INCLUDING GULLY CONNECTIONS TO BE PERFORMED T JUNCTIONS.
11. ALL BELOW SLAB RWP's SVP's AND SP's CONNECTED VIA A 'T' SECTION SHALL HAVE AN ACCESSIBLE ABOVE GROUND RODDING ACCESS J.
12. FOR ALL SETTING OUT OF POP UPS, SVP'S AND RWPS, REFER TO M&E / ARCHITECTURAL DRAWINGS.
13. ALL BRANCH CONNECTION IN MANHOLES TO BE SWEEPED IN THE MAIN FLOW DIRECTION.

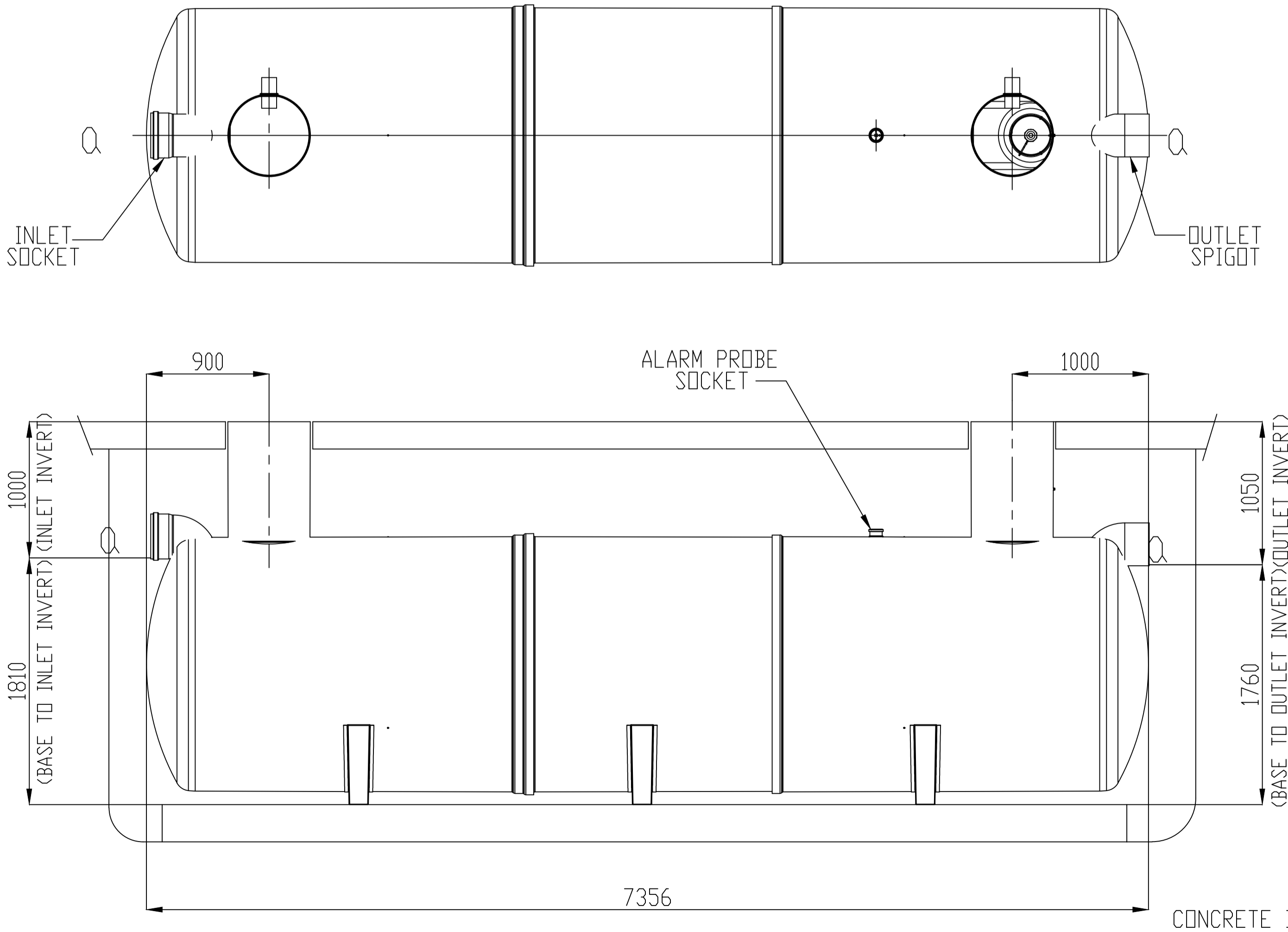

KINGSPAN FULL RETENTION PETROL  
INTERCEPTOR: MODEL NSFA050

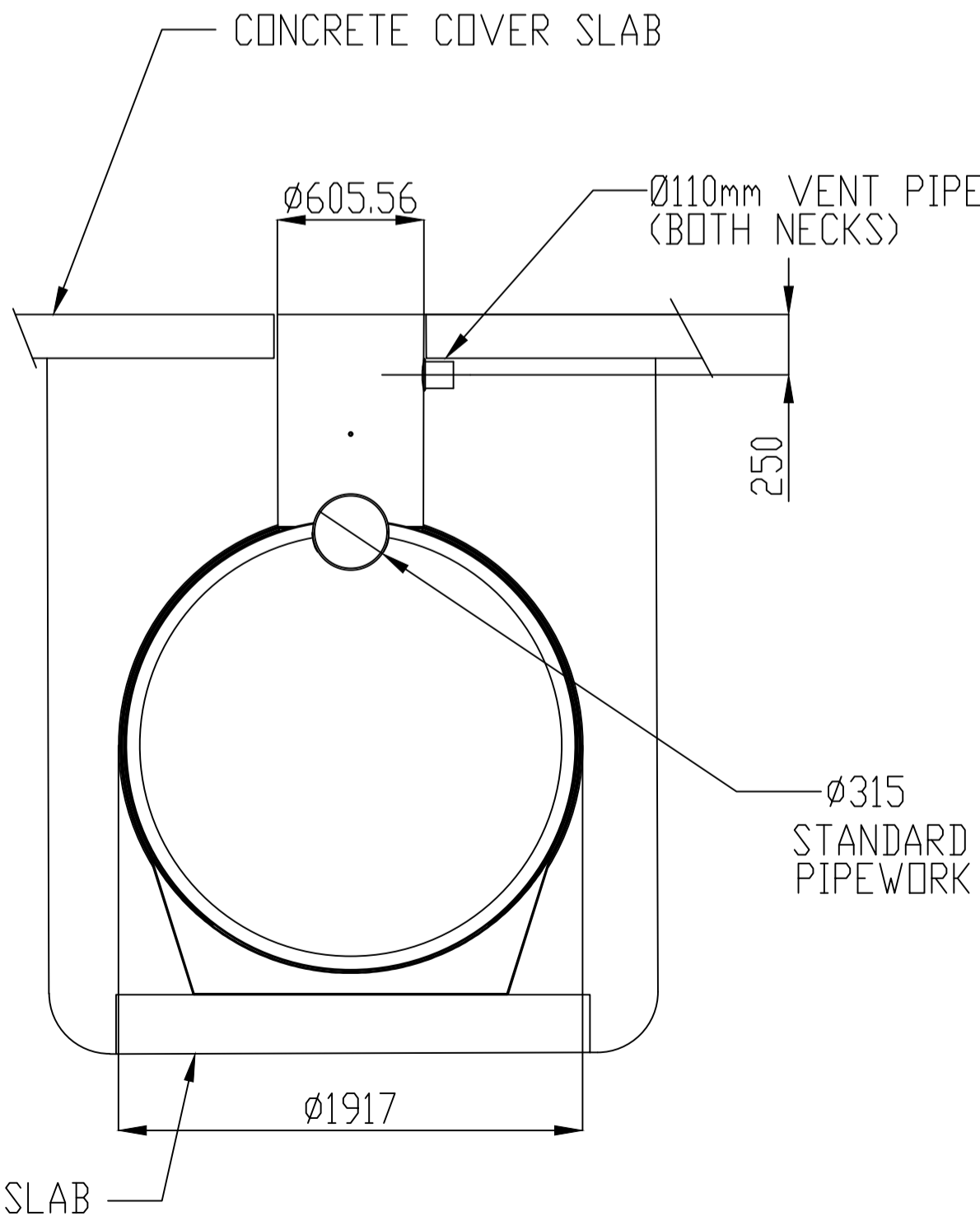

Rev	Date	By	Chkd	Description
A01	16/05/24	AR	GW	PRELIMINARY ISSUE

Status: INFORMATION

Client: BERRITE LIMITED

Project: BERRITE WORKS, WEST DRAYTON

Drawing: DRAINAGE DETAILS  
SHEET 3

MORGAN STRUCTURAL LIMITED  
The Old Brewery-Pill-Bristol-BS20 0DH  
T: 01275 217171  
E: Enquiries@MorganStructural.co.uk  
W: www.MorganStructural.co.uk  
Morgan Structural Limited - Registered office -  
The Old Brewery-Pill-Bristol-BS20 0DH  
Company Registered in England and Wales No. 8146644

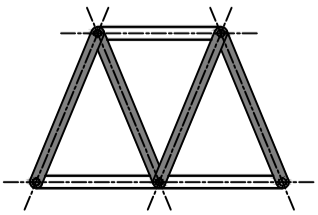

Scale: NTS Date: 05/24 CAD: AR CAD Chk: GW Suitability: BP  
MSL Job No.: 22034 Rev: A01

Drg no. CIV-113