

EXISTING GROUND FLOOR PLAN
SCALE 1/100

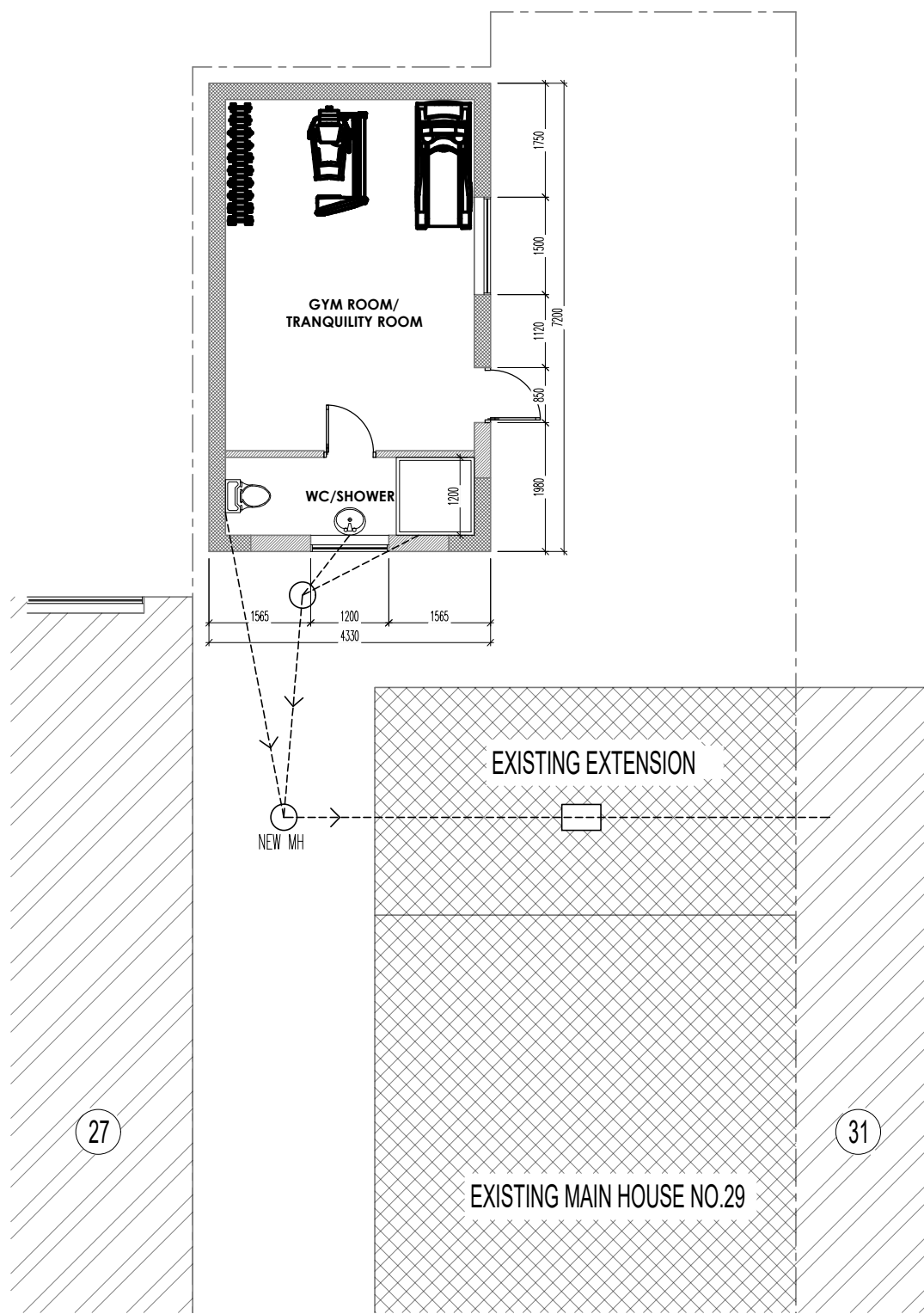

PROPOSED GROUND FLOOR PLAN
SCALE 1/100



DRAWING:
GROUND FLOOR PLAN

PROJECT ADDRESS:
**29 RICHARDS CLOSE
HARLINGTON HAYES
UB3 5EA**

CLIENT NAME:
MRS. RAKSHA GREWAL

PROJECT:
**PROPOSED GARAGE CONVERSION TO A GYM & FITNESS ROOM
ANCILLARY & ENJOYMENT OF MAIN HOUSE**

DATE:
04.04.2023

PURPOSE OF ISSUE:
PLANNING

SCALE:
1:100@A3

DRAWING NUMBER:
2312/PL/01

REVISION:

NOTES:
THIS DRAWING IS THE SUBJECT OF COPYRIGHT
AND DESIGN RIGHTS AND SHALL NOT BE
REPRODUCED, LOANED, COPIED OR SUBMITTED
TO ANY OTHER PARTY.

Registered LABC Partner with
SLOUGH BOROUGH COUNCIL



Architecture | Planning

9 MACKENZIE STREET
SLOUGH
BERKSHIRE
SL1 1XQ
TEL: 01753 709770
MOB: 0774 8716893
www.sa.associates

