

1 EXISTING SITE PLAN

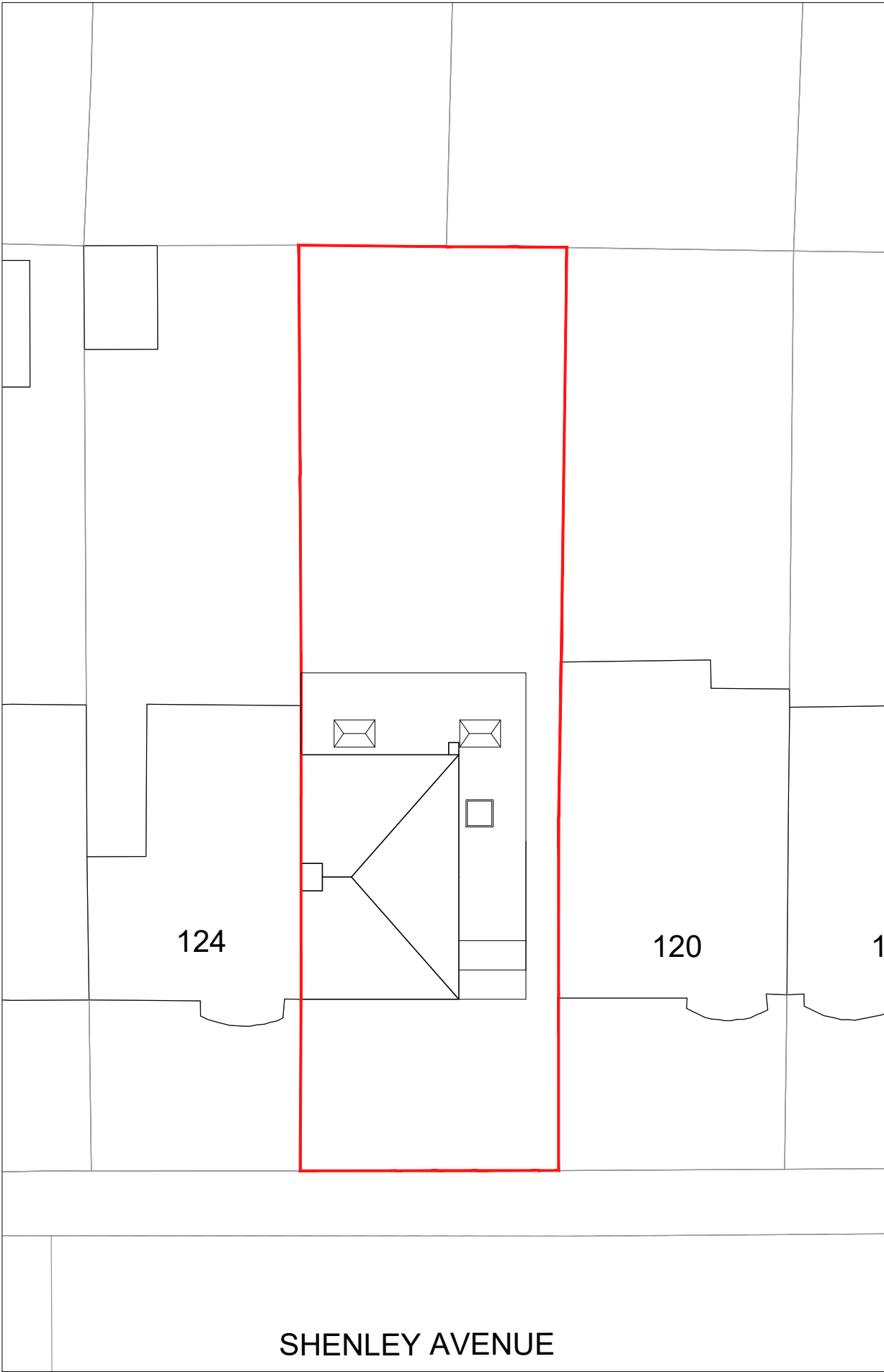

2 PROPOSED SITE PLAN

REVISION:



BANYAN TREE
ARCHITECTS
E: INFO@BANYANTREEARCHITECTS.COM
T: 07980 765732

PROJECT:	122 SHENLEY AVENUE, RUISLIP, HA4 6BY
DRAWING:	CN_002_EXISTING AND PROPOSED SITE PLAN
SCALE:	1:200@A3
DATE:	29/12/23
REVISION:	-
STATUS:	PLANNING



0m2m4m6m8m

All dimensions to be checked on site prior to construction.

All drawings to be read in conjunction with structural engineer's drawings.