

REAR ELEVATION

SIDE ELEVATION

SIDE ELEVATION

FRONT ELEVATION

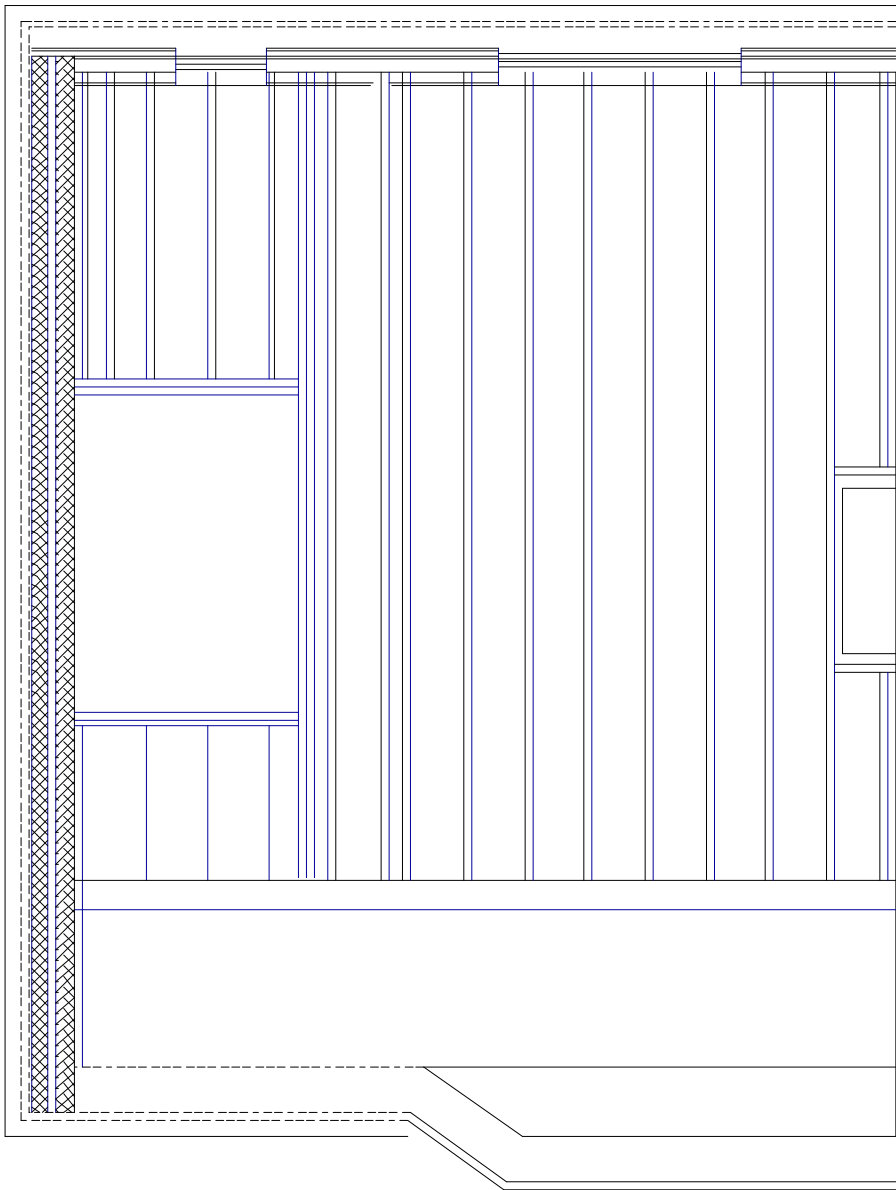

JOIST LAYOUT

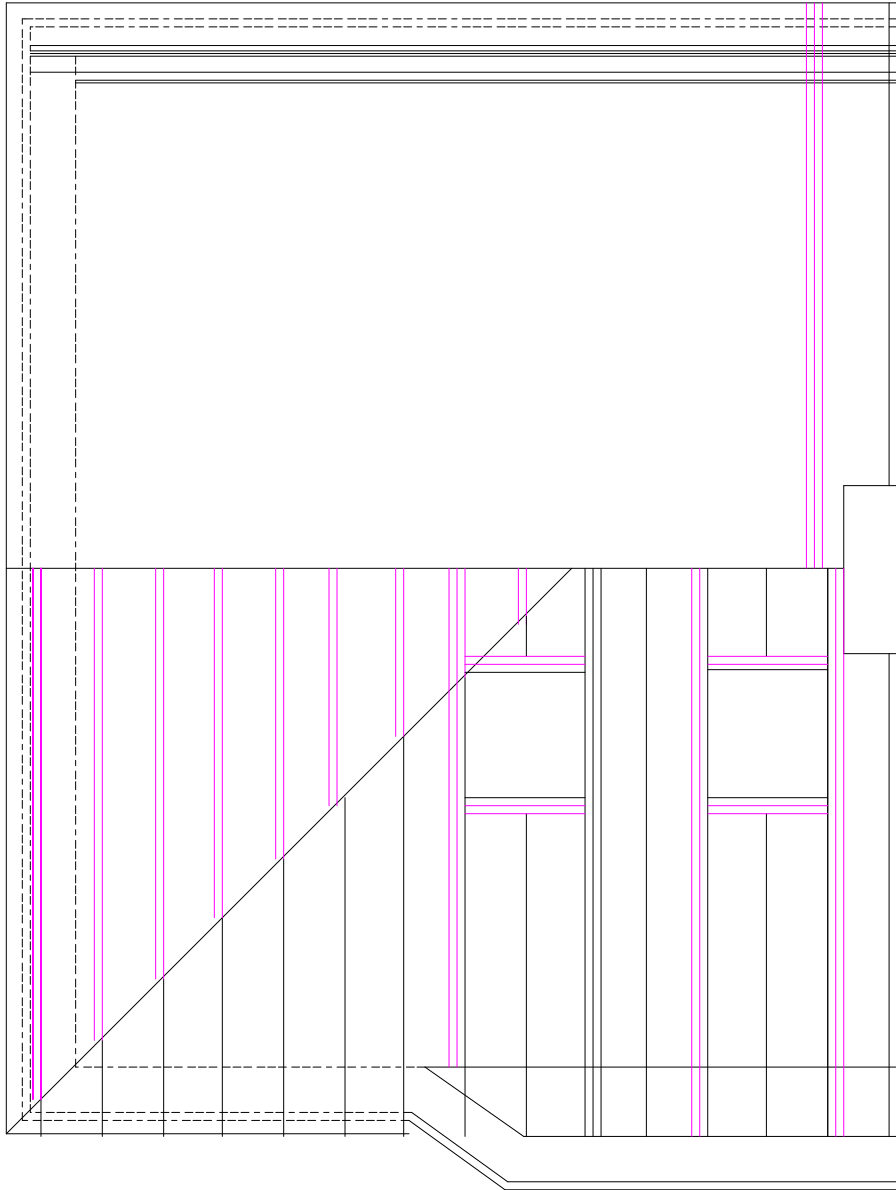

RAFTER LAYOUT

Hip to Gable
 $(7.479 \times 3.739 \times 3.218)/6 = 15\text{m}^3$

Dormer
 $4.88\text{m}^2 \times 5.29\text{m} = 25.82\text{m}^3$

TOTAL VOLUME ADDED = 40.82m3

48 DELLFIELD CRESCENT
COWLEY

PLAN	Elevations
PROJECT	Loft Conversion
<div>General Notes: 1. All dimensions to be checked on site prior to construction any discrepancies should be reported to the highford design 2. All drawings are indicative of architect's visual requirements only and show design intent only As this is a conceptual design stage, it is recommended that you consult with your structural engineer for further details Copyright: Highford Design Ltd This drawing should not be used to calculate areas for the purpose of valuations. All dimensions to be checked on site by contractor and each dimension to be their responsibility</div>	

DWG No

02

Rev: -

Date: April 2021

Project: 48 Dellfield Crescent, Cowley

Scale: 1:50 @ A1

Checked: AW

Drawing Title: Elevations

Status: Planning

Job No: 326

Highford
Design and Build Limited
27 Bellamy Close, Ickenham, Middlesex UB10 8SJ
email: info@highforddesign.co.uk - web: www.highforddesign.co.uk
telephone: 01845 622575 - mobile: 07557 340205