

241054 – NEXT, Unit 2, Ruislip Retail Park 190325

Accessibility Statement

This note accompanies the planning application for the following developments:

43510/APP/2024/3336 :

“Installation of an internal mezzanine floor for retail purposes Use Class E(a) including the use of an ancillary cafe and back of house storage space.”

43510/APP/2024/3337 :

‘Refurbishment of the existing retail unit (Unit 2) to provide a new shop front, new fire exit door and for the use of the retail unit to be within Class E(a) with an ancillary café and back of house storage space.’

Due to the floorspace created, the application is considered to be major development and therefore an Accessibility Statement has been requested to accompany the application in line with Hillingdon Validation Requirements.

Accessibility Statement

The Transport Statement submitted with the application provides the following section on Accessibility to the site at Section 4.

4.31 For those that are disabled users, there is considerable help available both in the physical transport infrastructure as described previously, but also financially with a pass for free / low-cost travel within Greater London, and in the rest of England under the English National Concessionary Travel Scheme.

4.32 Those having a Disabled Person's Freedom Pass, can travel for free at any time on TfL services. On National Rail services in London, holders of this pass can travel free after 9:30 weekdays, and any time on weekends and public holidays.

4.33 As previously discussed, the highway network around the site includes facilities for disabled users, including visually impaired users, as signal-controlled crossing points, dropped kerbs and tactile paving.

Internally the retail unit provides level access from the car park and there are existing DDA parking spaces directly outside the door. The submitted plans show a DDA compliant lift is proposed to be installed to provide access to the mezzanine. An extract from the floor plans showing the lift is provided below.

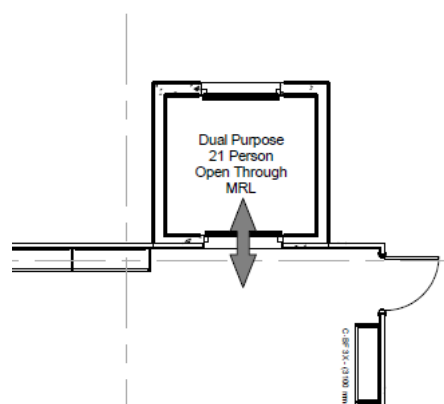

Conclusion

The applications propose the installation of an internal mezzanine and alterations to the shopfront and sales of clothing from the existing retail unit, the scheme is therefore compliant with the requirements of the Disability Discrimination Act.

