

DMP File No.  
E:\CAD\DMF\DWGS\

1. MECHANICAL NOTES
1. PROVIDE ALL NEW POT & COLD PIPework IN BLACK PIPE
2. BLOCK A PIPework SIZES TO BE ADDED TO EXISTING POT & COLD PIPework TO BE REMOVED
3. AN REPAIRING COLD WATER PIPework TO BE FITTED
4. HIGH PRESSURE BALL VALVES TO BE FITTED ON ALL EXISTING W.C. URINAL FLUSHING SYSTEMS
5. EXISTING WARM WATER TO BE FITTED TO ALL HOT WATER PIPework OFF EXISTING CONTRACTORS TO TAKE ALL EXISTING WARM WATER PIPework ON SITE & COLD WATER PIPework ON SITE & TO ELIMINATE DEAD LEGS
6. FIT A LINE SIZE HENZICOT THERMAL BALANCE & STERILISING VALVE WITH A 1/2" NPT TO BE FITTED TO EVERY SECONDARY HOT WATER SERVICE RETURN BRANCH.

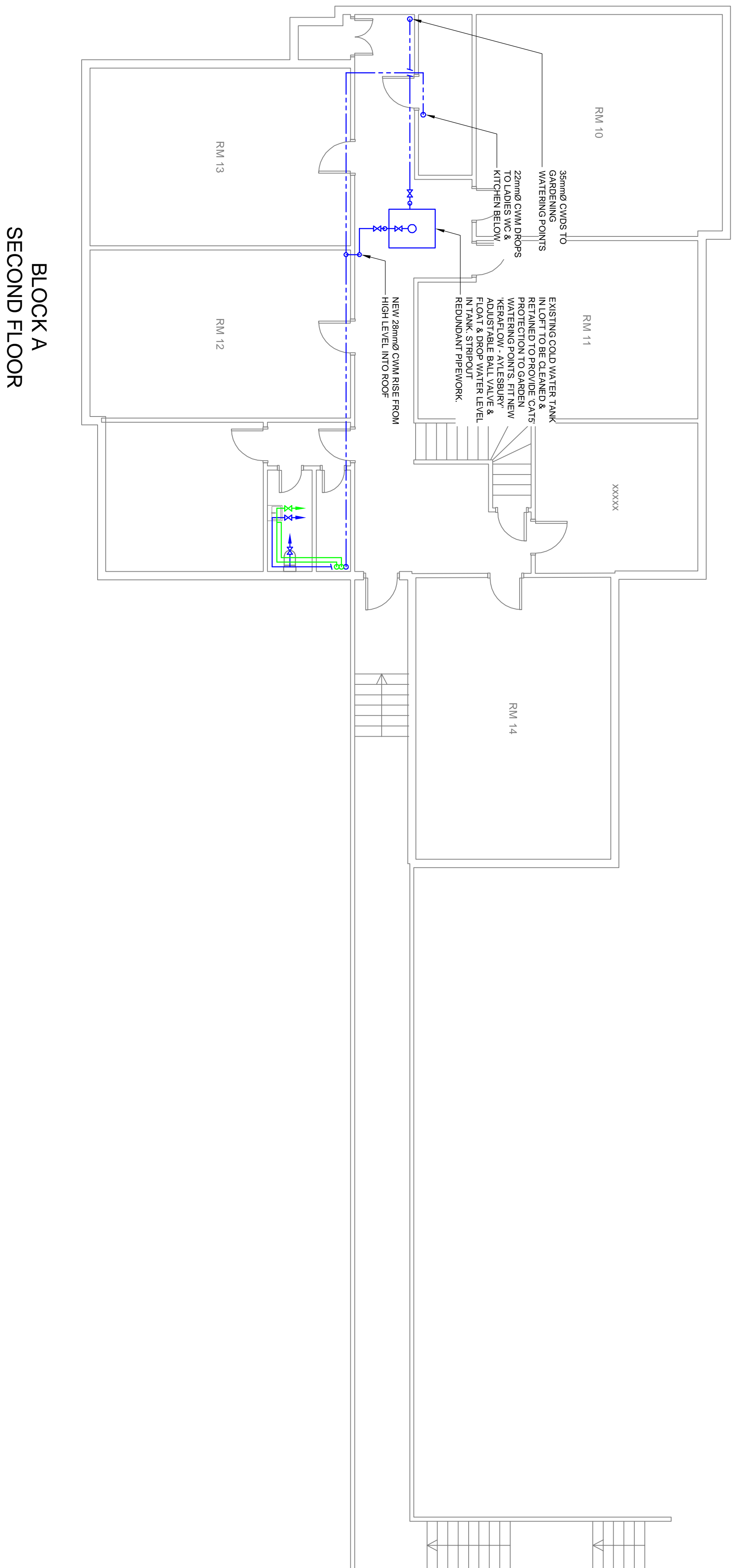

P	30.09.22	ISSUED FOR COMMENT
REV	DATE	DESCRIPTION



8 Holgate Court, Western Road,  
Romford, Essex, RM1 3JS  
Tel: 01708 729070 [www.davidmiles.co.uk](http://www.davidmiles.co.uk)

project  
BISHOPHALT SCHOOL

title  
BLOCK A - SECOND FLOOR  
PROPOSED DOMESTIC SERVICES  
LAYOUT

scale	date	
1:100@A1	SEPT 2022	
drawn	checked	rev
SGK	CF	P

7722-MDS-405

PRELIMINARY

**DO NOT SCALE FROM THIS DRAWING**