

Note: This Drawing is for planning purpose and should not be used for construction.
All dimensions should be confirmed on site and any deviation should be reported back to designer.

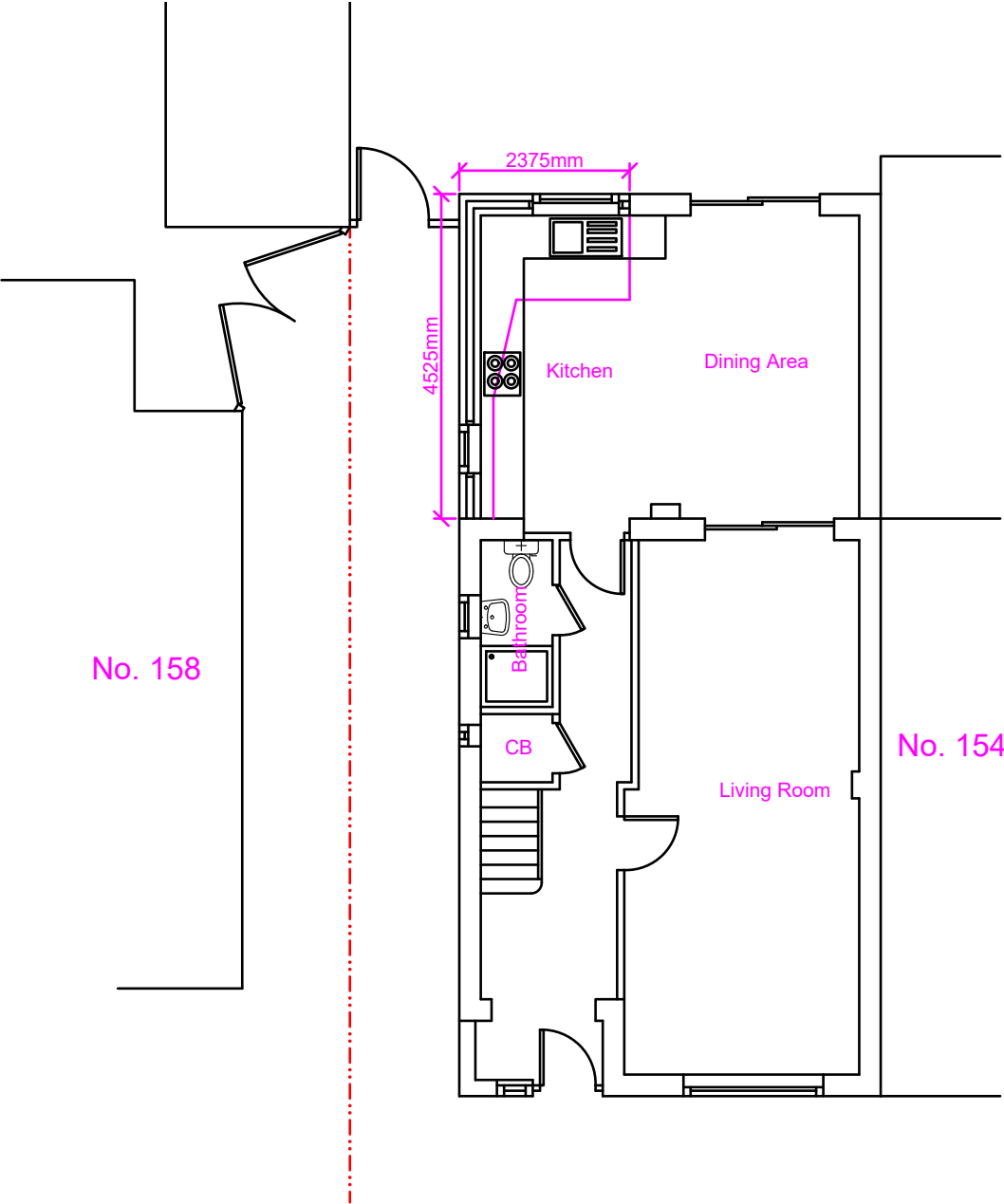

Proposed Ground Floor

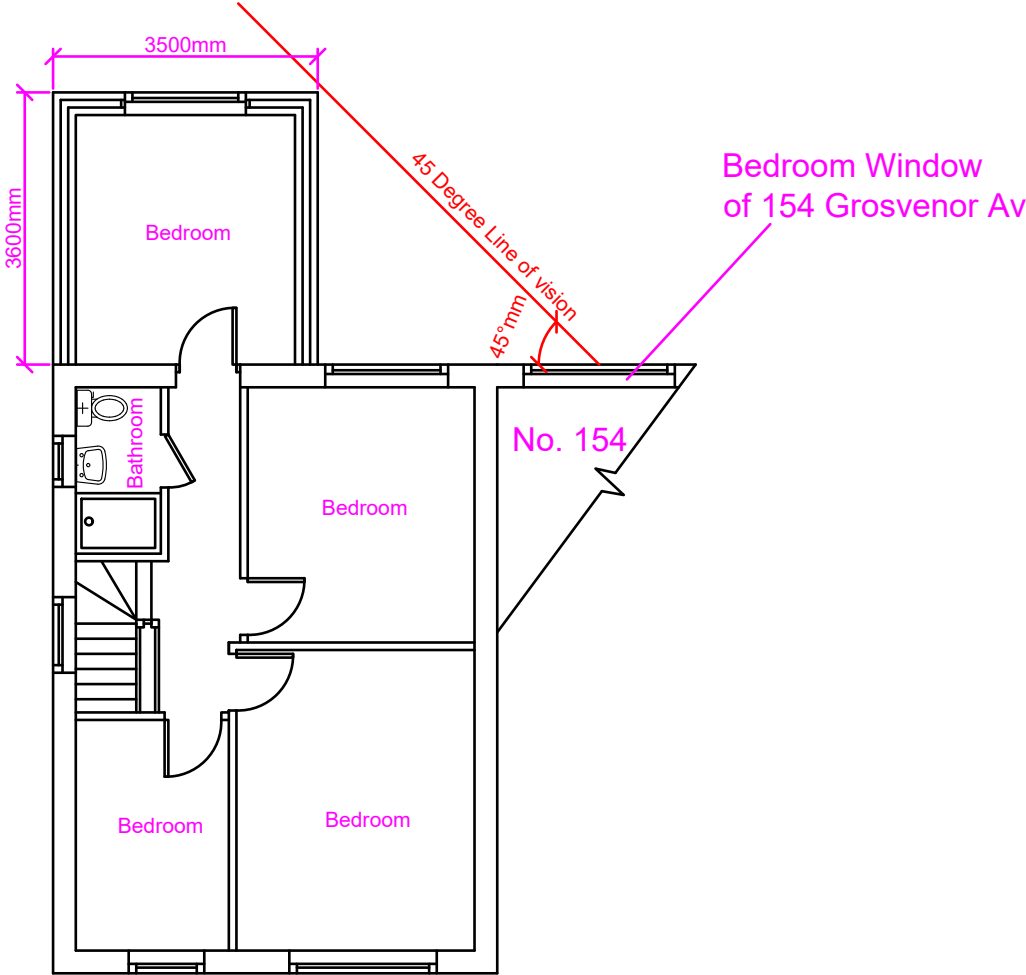

Proposed First Floor

Proposed Development:

Part single storey rear extension and part first floor rear extension

Site Address:

156 Grosvenor Avenue
Hayes
UB4 8NW

Revisions:

Rev	Date	Description
A	28/03/2023	

Drawing Description:

Proposed Floor Layout

Drawing No:

ART/2023/FFRE156GA/PL

Scale: 1:100
Paper Size: A3
Sheet No: 2 of 5



ART CONSULTANTS (UK) LTD
113 LONG LANE
STANWELL
TW19 7AL
M:07960071377
E: ARTCONSULTANTSUK@GMAIL.COM