

LEGEND

- AREA TO BE DEVELOPED DURING PHASE 2
- SEWER WAYLEAVE
- EMERGENCY ROUTE
- ELECTRICAL UNIT CLEARANCE AREA
- RETAINED TREES
- EXTENT OF PHOTOVOLTAIC CANOPY
- EXTENT OF ROOT PROTECTION AREAS
- EXISTING BOUNDARY FENCE

SITE APPLICATION BOUNDARY - PHASE 1

	AREA (sqm)	AREA (Hectare)	AREA (Acre)
PHASE 1 APPLICATION BOUNDARY	7021.10	0.702	1.73

SITE ACCOMMODATION

CAR PARKING	SPACES
PUBLIC FLEXI COMMERCIAL ELECTRIC VEHICLE STANDARD BAYS (SUBJECT TO NETWORK CAPACITY AVAILABILITY)	16
CONTRACTED FLEXI COMMERCIAL ELECTRIC VEHICLE STANDARD BAYS (SUBJECT TO NETWORK CAPACITY AVAILABILITY)	38
ACCESSIBLE ELECTRIC VEHICLE PARKING BAYS	2
FOOD & BEVERAGE STANDARD PARKING BAYS	4
FOOD & BEVERAGE ACCESSIBLE PARKING BAYS	2
FOOD & BEVERAGE ENLARGED PARKING BAYS	4
TOTAL	66

OPERATIONAL BAYS

OPERATIONAL BAYS	SPACES
HIGH GOODS VEHICLE WASTE/ DELIVERY BAY	1
DISTRIBUTION NETWORK OPERATOR MAINTENANCE BAYS	2
DRIVE THRU WAITING BAYS	2

AREA SCHEDULE

AREA SCHEDULE	AREA (m ²)
FOOD & BEVERAGE UNIT (1 NO.)	195
STAFF WELFARE UNIT (1 NO.)	16
CUSTOMER WELFARE UNIT (1 NO.)	30.5
ELECTRICAL UNIT AREA (1 NO.)	343

Architects are to be notified of any discrepancies. Contractors must check all dimensions on site. This drawing is subject to copyright laws and is for use on this project only. This drawing is to be used solely for the information as titled only. For other information refer to the latest revision of any cross referenced drawings. To be read in conjunction with relevant design standards/protocols

This is a colour drawing. In order to ensure any subsequent reproduction is viewed correctly it should be printed in full colour.

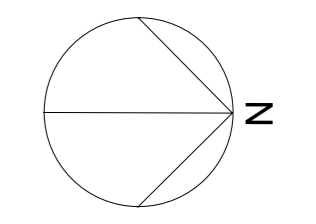
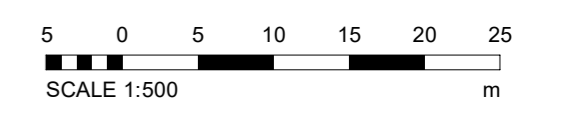

BLUE LINE DENOTES EXISTING BOUNDARY FENCE AS PER TOPOGRAPHICAL SURVEY. REFER TO - 35225 Topographical Survey (December 2024).

BINS AREA. REFER TO REFUSE MANAGEMENT STRATEGY FOR FURTHER INFORMATION.

INDICATIVE LOCATION OF 9.05m HIGH TOTEM SIGNAGE UNDER SEPARATE APPLICATION. COLOUR AND MATERIAL TBC.

PROPOSED KNEE RAIL FENCE REFER TO DRAWING 7935-SMR-00-ZZ-DR-A-2006.

PROPOSED REMOVAL/RELOCATION OF EXISTING TREES IN GREEN DASHED LINE. REFER TO - 35225 Topographical Survey (December 2024)

FOOD & BEVERAGE UNIT. DESIGN SUBJECT TO OCCUPIER SPEC TBC.

2NO. LONG STAY CYCLE PARKING SECURE LOCKERS

5NO. SHEFFIELD STANDS FOR CUSTOMER PARKING & E-BIKE BATTERY CHARGING UNIT.

DROPPED KERBS AND TACTILE PAVING.

INDICATIVE LOCATION OF BARRIERLESS ANPR.

INDICATIVE LOCATION OF WAYFINDING SIGNAGE UNDER A SEPARATE SIGNAGE APPLICATION.

ACCESS JUNCTION AS PER S278 WORKS. DRWG. REFERENCE: 0001 Rev P6 - FOR CONSTRUCTION BY MAYER BROWN.

PROPOSED KNEE RAIL FENCE. REFER TO DRAWING 7935-SMR-00-ZZ-DR-A-2006.

EXISTING FENCE TO BE REMOVED AND NEW FENCE TO BE ERECTED TO PERIMETER. REFER TO DRAWING 7935-SMR-00-ZZ-DR-A-2006.

PHASE 1 SMOKING SHELTER REFER TO DRAWING 7935-SMR-00-ZZ-DR-A-2008.

CYCLE SHELTER REFER TO DRAWING 7935-SMR-00-ZZ-DR-A-2008.

MAGENTA DENOTES TREE ROOT PROTECTION AREA

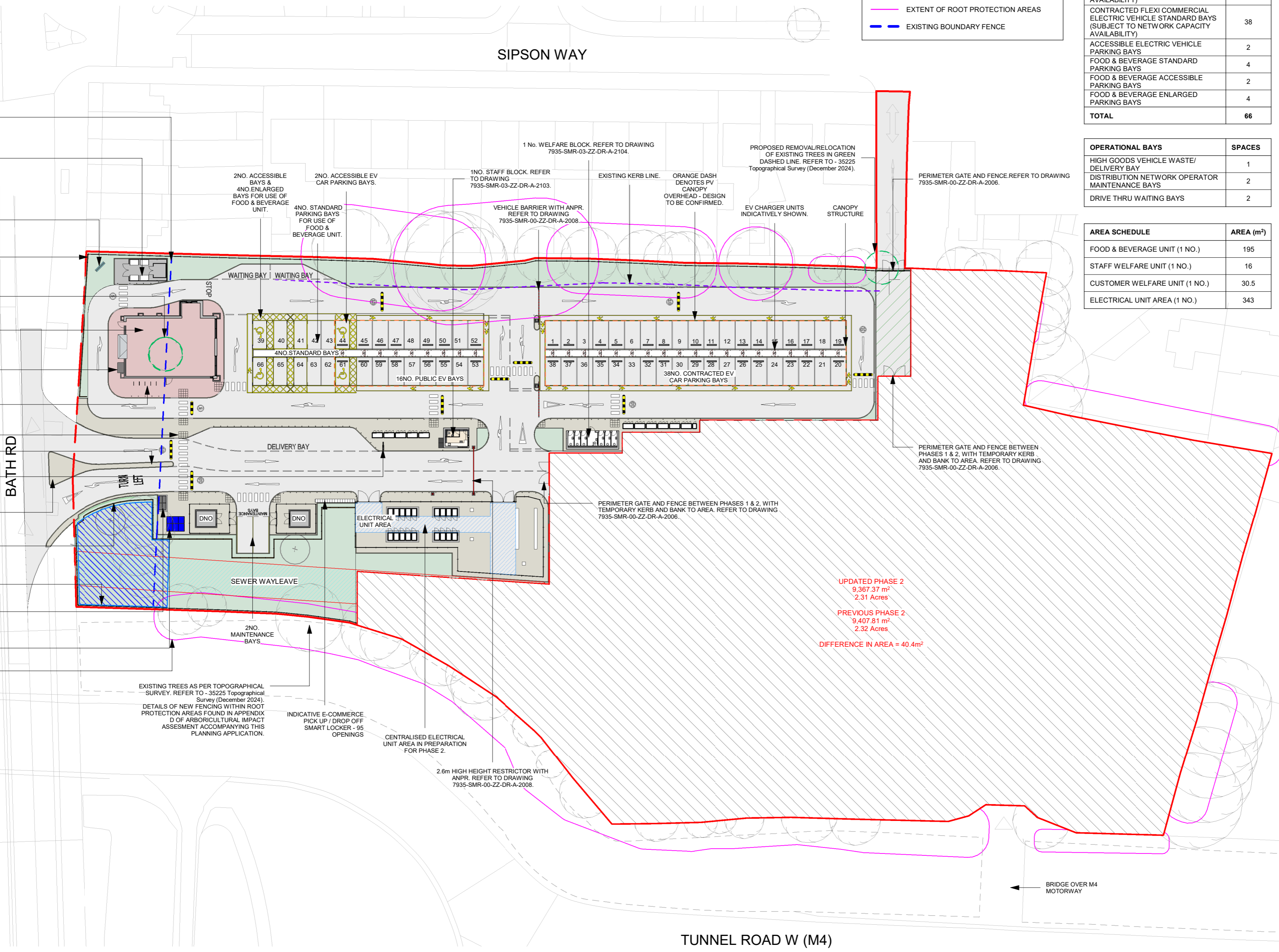

P17	AMENDMENTS AS PER LYSARA EMAIL 19.01.26	20.01.26	AH	JC
P16	ADDITIONAL ENLARGED BAYS ADDED AS PER LPA COMMENTS	19.01.26	AH	JC
P15	MINOR AMENDMENTS	13.11.25	AH	CV
P14	POWER UNITS INTRODUCED AND OTHER AMENDMENTS AS PER DTM 23.10.25	06.11.25	AH	CV
P13	MINOR AMENDMENTS	14.10.25	AH	JC
P12	WELFARE BLOCK REINTRODUCED TO PHASE 1.	08.10.25	AH	JC
P11	MINOR AMENDMENTS.	08.09.25	JC	CV
P10	MINOR AMENDMENT TO BOUNDARY TREATMENTS & PLANNING.	29.08.25	AH	CV
P9	MINOR AMENDMENT TO ELECTRICAL UNIT AREA.	19.08.25	JC	CV
P8	PLANNING ISSUE IN LINE WITH DESIGN FREEZE 22.07.25.	30.07.25	JC	CV
P7	PLANNING ISSUE.	25.06.25	JC	CV
P6	F&B UNIT UPDATED. SOLAR CANOPY COLUMN POSITIONS INCLUDED IN PHASE 2. EV CHARGERS INCLUDED, AND OTHER MINOR AMENDMENTS.	06.06.25	AH	JC
P5	UPDATED IN LINE WITH DESIGN FREEZE 02.	23.05.25	JC	JM
P4	SUBSTATION LAYOUT UPDATED. TRUCK PARKING POSITION REVISED. CYCLE PARKING AMENDED	25.03.25	TH	CV
P3	DRAWING UPDATED	10.03.25	TH	CV
P2	NOTES UPDATED	14.02.25	TH	CV
P1	FIRST ISSUE.	13.02.25	TH	CV
Rev	Description	Date	Drn	Ckd

UPDATED PHASE 2
9,367.37 m²
2.31 Acres

PREVIOUS PHASE 2
9,407.81 m²
2.32 Acres

DIFFERENCE IN AREA = 40.4m²

SMR
SMALLEY MARSEY RISPIN

ARCHITECTS

The Exchange Station Parade Harrogate HG1 1TS
01423 707 757 admin@smrarchitects.co.uk

Project
HEATHROW FLIGHTPATH CAR PARK, UB7 0DU

Client
LYSARA

Drawing Title
PROPOSED SITE PLAN - PHASE 1.

Proj Ref	Origin	Zone	Level	Type	Role	Num	Status	Rev
7935 - SMR - 00 - ZZ - DR - A - 2003 - S3 - P17								
SMR Job Ref	Sheet	Scale	Drawn					
7935-00-2003	A2	1 : 500	AH					

TUNNEL ROAD W (M4)