

COPYRIGHT RESERVED  
DO NOT SCALE FROM THIS DRAWING

**Tree Survey Drawing Key**

- Root Protection Area m2
- Tree Canopy Extent
- Stem Location / Calculated dpc
- Category BS 5837 Category
- Tree Number

See Tamla Trees, Tree Survey for Individual Tree Details

**KEY**

Please refer to Tamla Trees report for details

- Category A - Trees of high quality
- Category B - moderate quality
- Category C - low quality
- Category U - Dead, Dying or Defect trees with <10 years retention value

- RPA - root protection area as defined by Table 2 BS 5837:2012
- Proposed removal - to facilitate Development
- Location of protective fencing - Scaffold Frame Fence
- Location of protective fencing - BS 5837 Herras Fence (or similar)
- Site hoarding
- Canopy cut back to boundary in accordance with BS3998
- Proposed hardstanding

**TREE PROTECTION AREA**

If you require access contact Site Manager

THESE TREES ARE PROTECTED BY PLANNING CONDITIONS AND/OR IS THE SUBJECT OF A TREE PRESERVATION ORDER

GROUND COMPACTON KILLS TREE ROOTS - BREACHING A TPO IS A CRIMINAL OFFENCE - HELP RETAIN HEALTHY TREES BY RESPECTING TREE FENCING

in collaboration with Tamla Trees Ltd. 10/10/2023

- Warning signs to be located every 5m and to be minimum A3 in size (i.e. 42cm x 29.7cm)
- To be checked and replaced as necessary.

Deviations from the advised tree protection compromises tree roots and should be avoided. The purpose of tree protection measures should be briefed to all on site staff.

**Tree Protection Specification**

**Fencing to be installed prior to any on site activity (demolition or construction)**

- Scaffold frame should be spaced at a maximum interval of 3 m and driven securely into the ground.
- Welded mesh panels should be securely fixed.
- Care should be exercised when locating the vertical poles to avoid underground services and, structural tree roots.
- Where the fencing is to be erected on retained hard surfacing or it is otherwise unfeasible to use ground pins, e.g. due to the presence of underground services, the stabilizer struts should be mounted on a block tray.
- Fencing should not be moved without prior approval.

**NOTE #** Tree positions indicatively mapped due to lack of detailed topographical plan

REV	AMENDMENTS	DRAWN DATE	AUTH'D
005288	1.250 @ A1	18/11/2023	

**Tree Protection Plan (TPP)**

005288 TPP\_04 D

Tel: 01252 811 233  
Email: info@tamlatrees.com  
Web: www.tamlatrees.com

**Tamla Trees**  
consulting arborists

**PROJECT**  
Terminals 2-3 Heathrow Heathrow Flightpath, West Drayton UB7 0DU

**CLIENT**  
Aprose Real Estate Investment

**TITLE**  
Tree Protection Plan (TPP)

**DATE**  
18/11/2023

**SCALE**  
1:250 @ A1

**REVISIONS**  
005288 TPP\_04 D

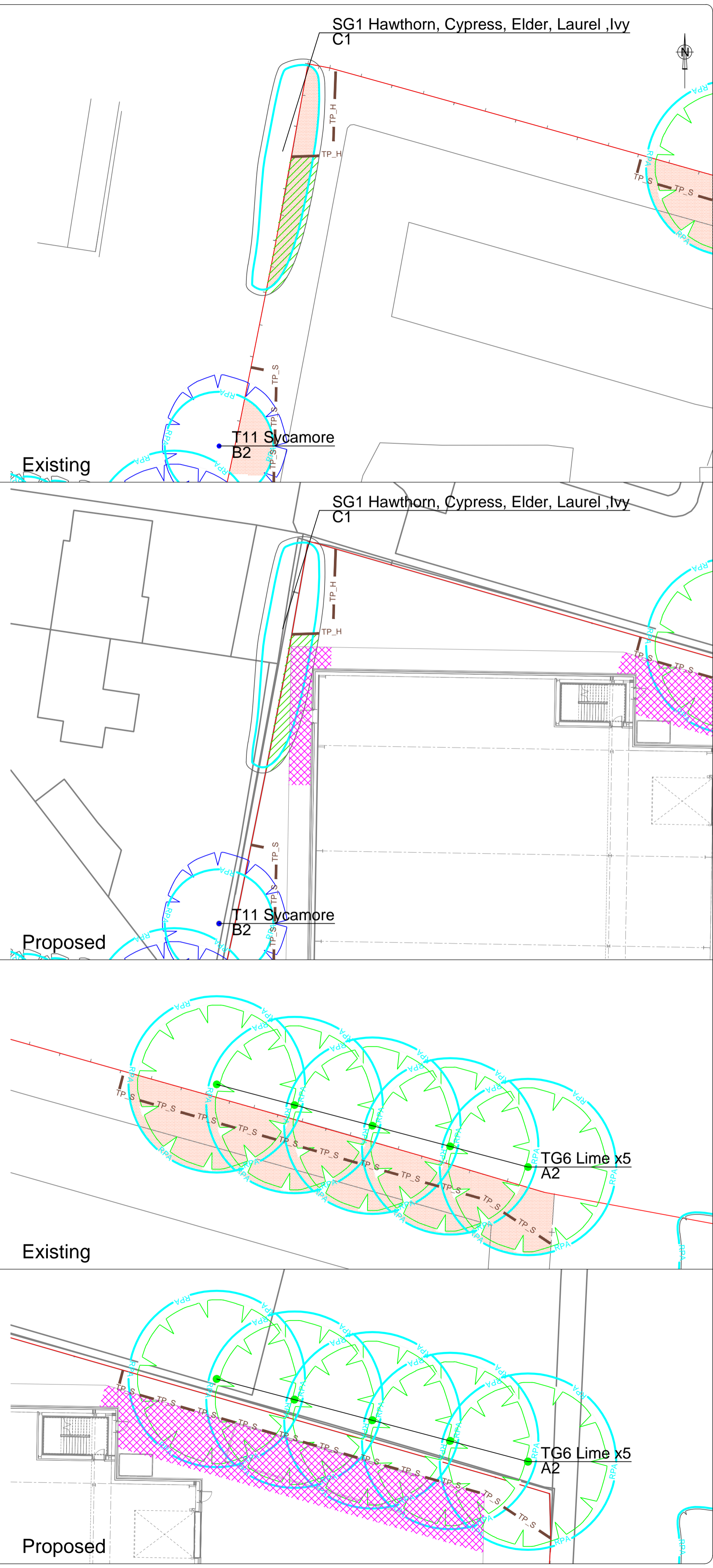
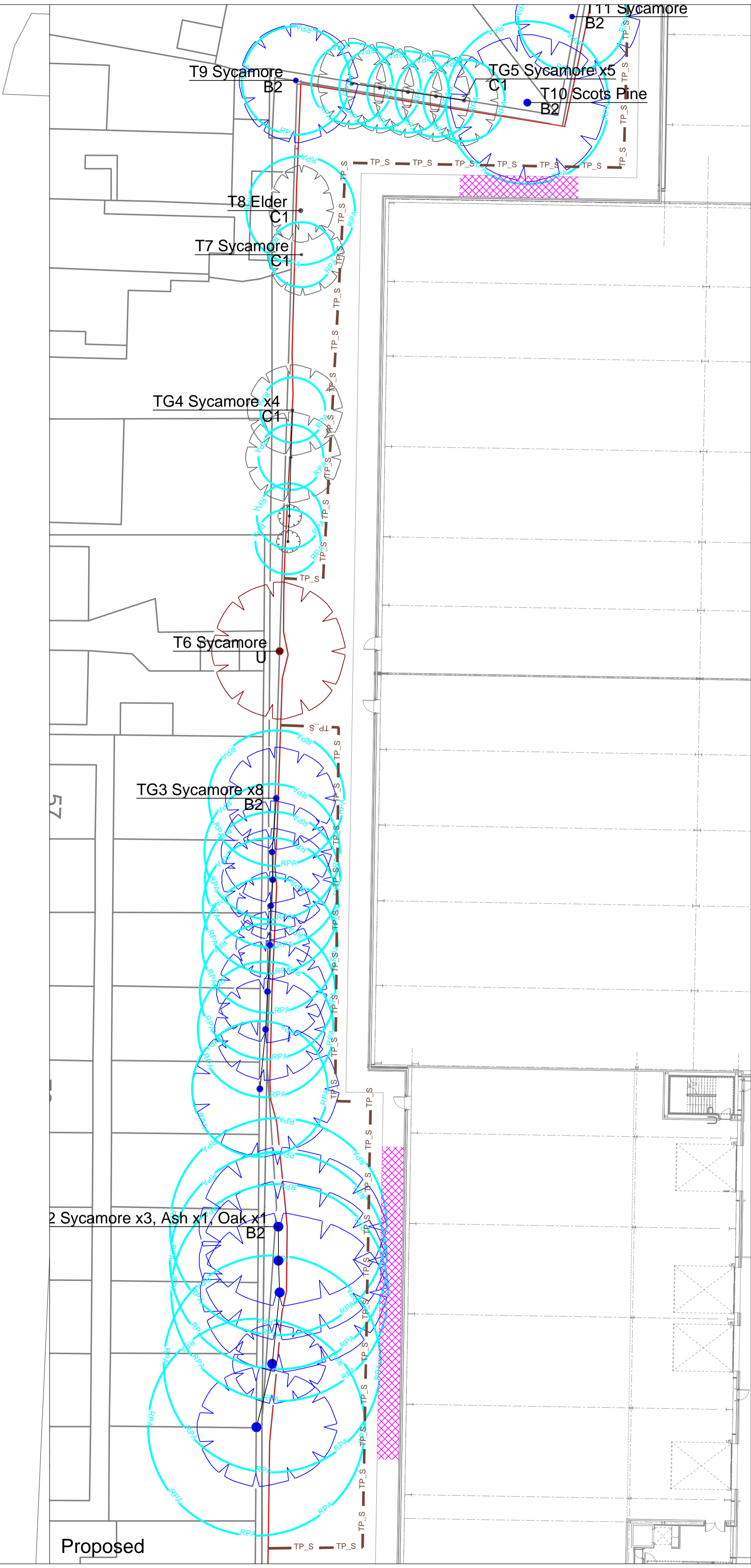
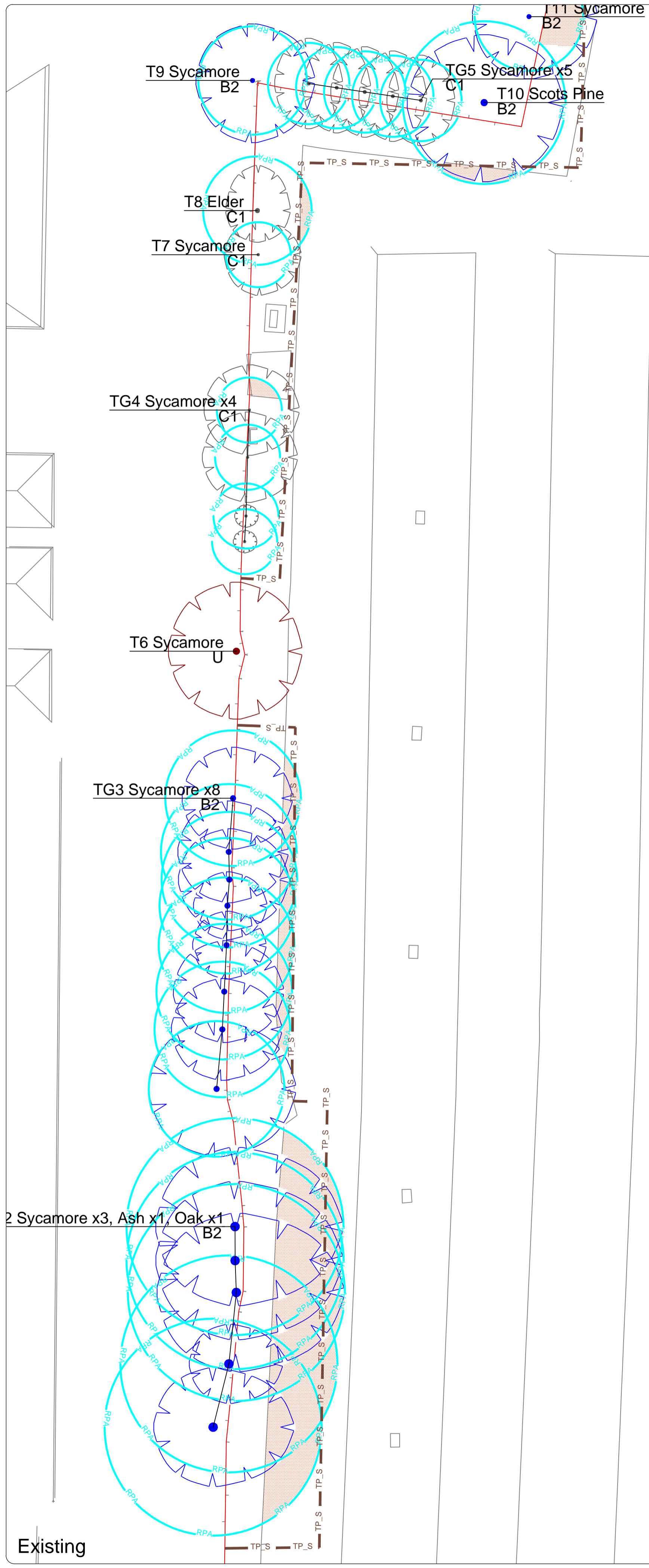

**COPYRIGHT RESERVED**  
DO NOT SCALE FROM THIS DRAWING

**Tree Survey Drawing Key**

- Root Protection Area m2
- Tree Canopy Extent
- Stem Location / Calculated Slope
- Category BS 5837 Category
- Tree Number
- See Tamla Trees, Tree Survey for Individual Tree Details

**KEY**

Please refer to Tamla Trees report for details

- Category A - Trees of high quality
- Category B - moderate quality
- Category C - low quality
- Category U - Dead, Dying or Defect trees with <10 years retention value

- RPA - root protection area as defined by Table 2 BS 5837:2012
- Proposed removal - to facilitate Development
- Location of protective fencing - Scaffold Frame Fence
- Location of protective fencing - BS 5837 Hedges Fence (or similar)
- Site hoarding
- Canopy cut back to boundary in accordance with BS3998
- Existing hardstanding / gravel within RPA
- Proposed hardstanding

**NOTE #** Tree positions indicatively mapped due to lack of detailed topographical plan

**REV** AMENDMENTS **DRAWN DATE** AUTH'D

**PROJECT**  
Terminals 2-3 Heathrow  
Heathrow Flightpath,  
West Drayton UB7 0DU

**CLIENT**  
Apirose Real Estate  
Investment

**TITLE**  
Tree Protection Plan (TPP)

**NO** 035288 **DATE** 15/05/2011 **SCALE** A1 **REVISED** 035288\_TPP\_06 **BY** D

**TEL** 01252 811 233  
**EMAIL** info@tamlatrees.com  
**WEB** www.tamlatrees.com

**Tamla Trees**  
consulting arborists