

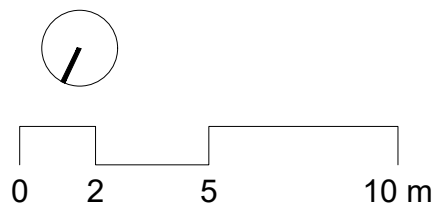

TUDOR CENTRE GROUND FLOOR PLAN  
GROSS INT AREA = 323.8 m sq

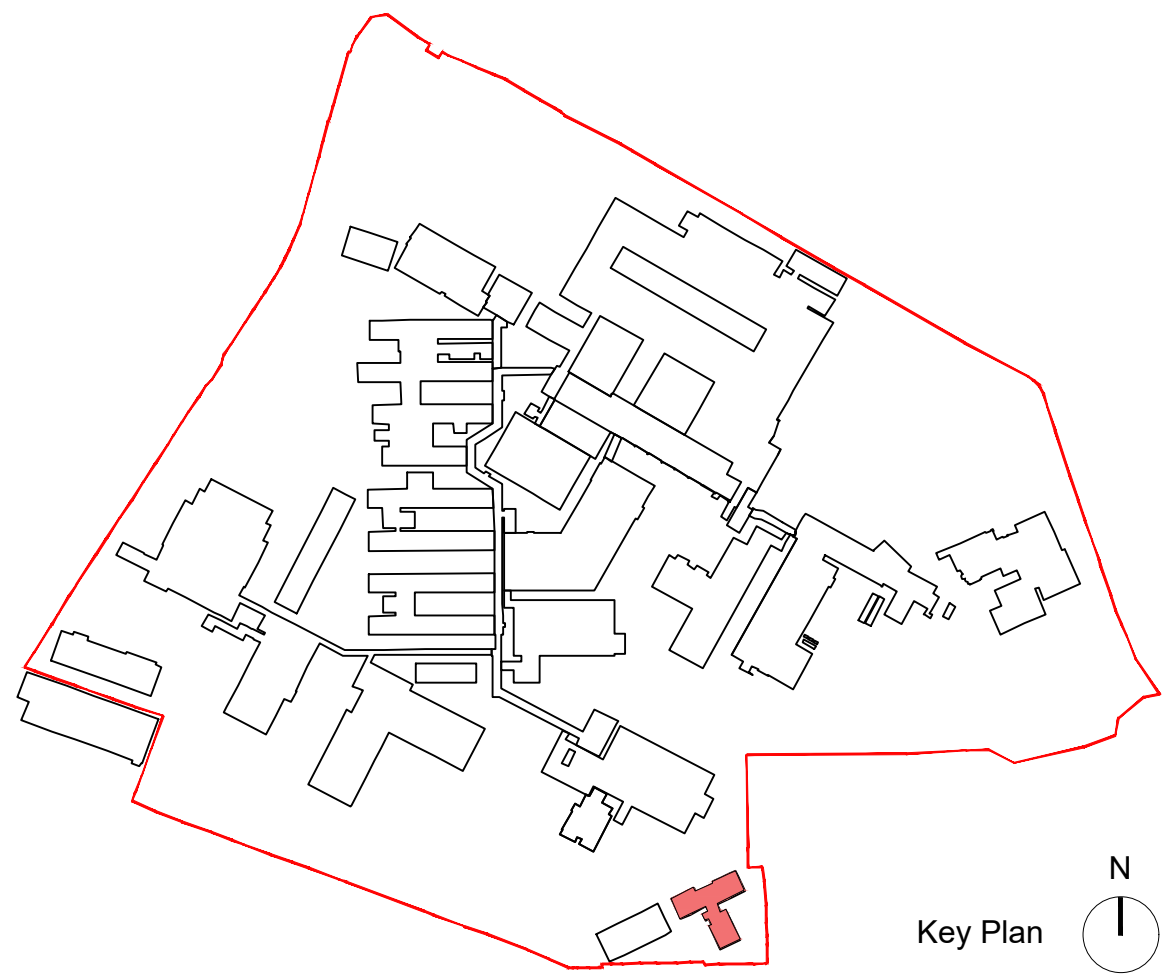

TUDOR CENTRE FIRST FLOOR PLAN  
GROSS INT AREA = 317.5 m sq



Notes:

- This drawing is copyright.
- Do not scale dimensions from this drawing.
- This drawing is to be read in conjunction with all other relevant drawings.
- All discrepancies on this drawing are to be reported to the architect.
- Do not modify any element of this drawing.
- Use drawing only for purpose(s) issued.

North Sign / Key Plan

The following external model files are included within this drawing:

P01	21.03.22	First Issue	AB	TB
Rev	Date	Revision Notes	Dn	Rv

Client / Contractor



Project  
Hillingdon Hospital Redevelopment

Drawing Title  
EXISTING HOSPITAL PLANS - TUDOR CENTRE

Job Number 126649	Drawing Originated Date 14/03/2022	PAS 1192 Status Code S2
Scale@A1 1:200	Purpose FOR PLANNING	

Drawing Number THHR_01-IBI-WS-ZZ-DR-A-251322	Revision P01
---	-----------------

NOTE:  
The content of this drawing has been provided by The Hillingdon Hospitals NHS Foundation Trust, therefore IBI Group is not responsible for the accuracy of the content.