

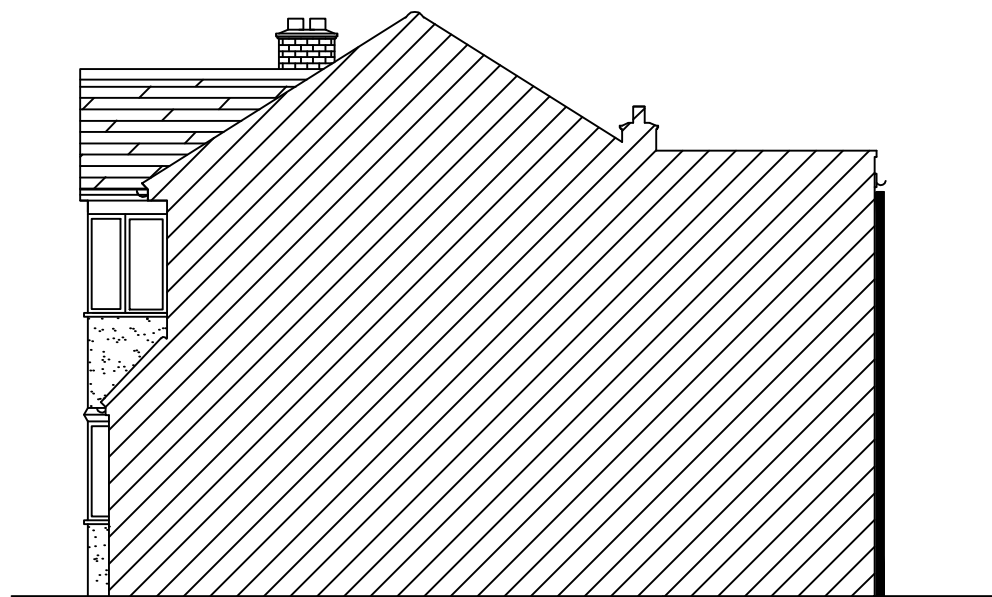

EXISTING FRONT ELEVATION



EXISTING REAR ELEVATION



EXISTING SIDE ELEVATION



EXISTING SIDE ELEVATION

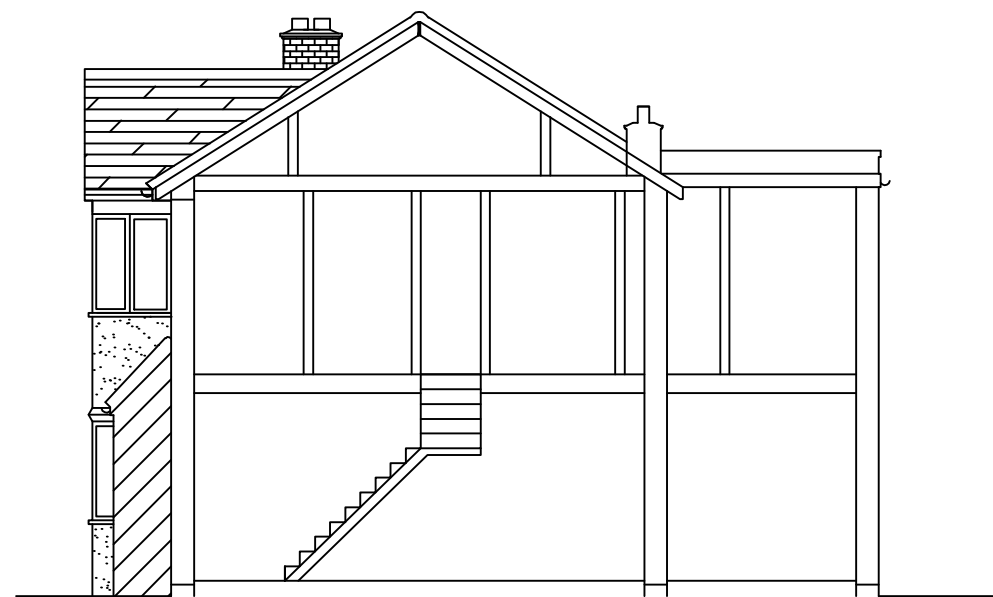

EXISTING SECTION

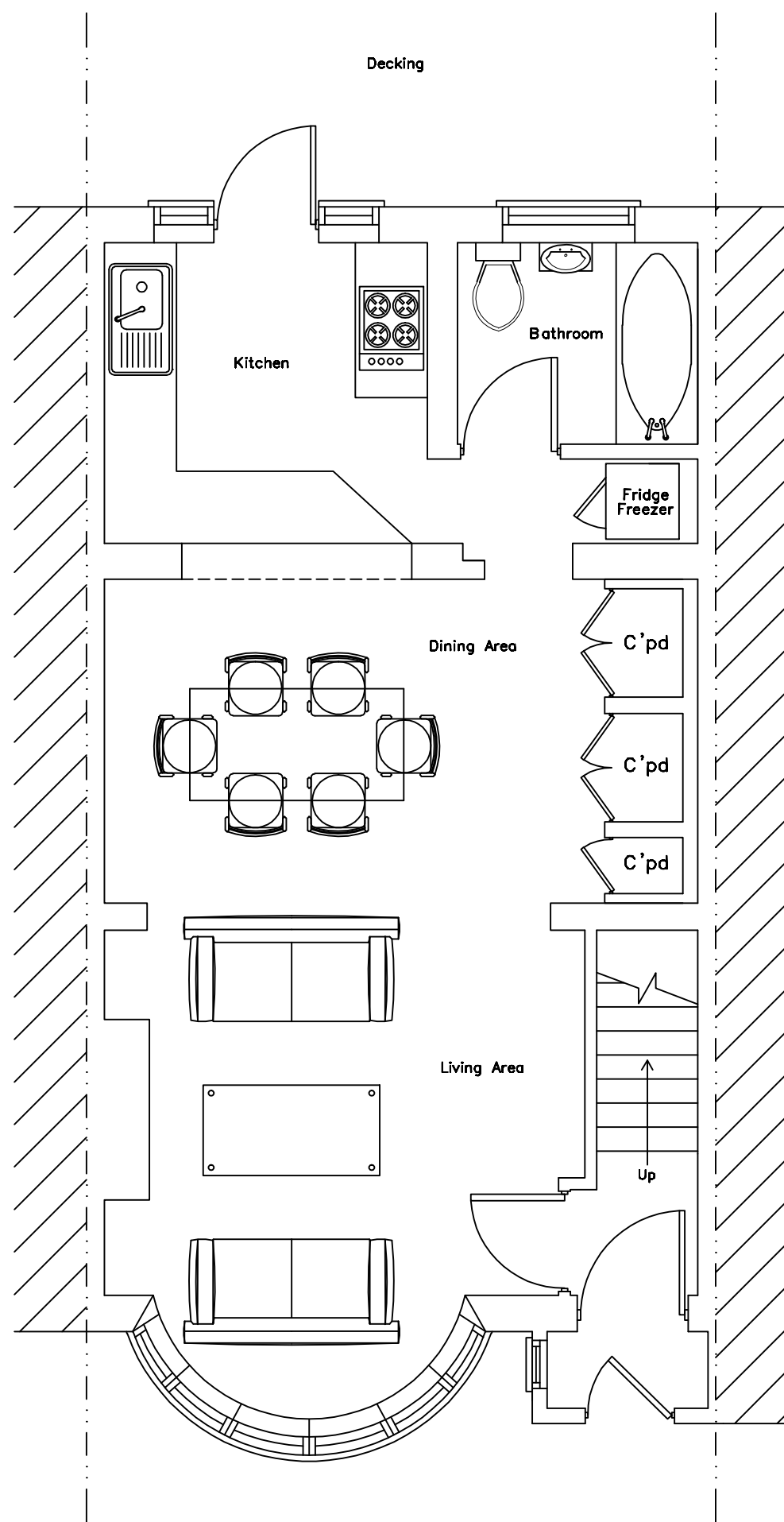

EXISTING GROUND FLOOR PLAN

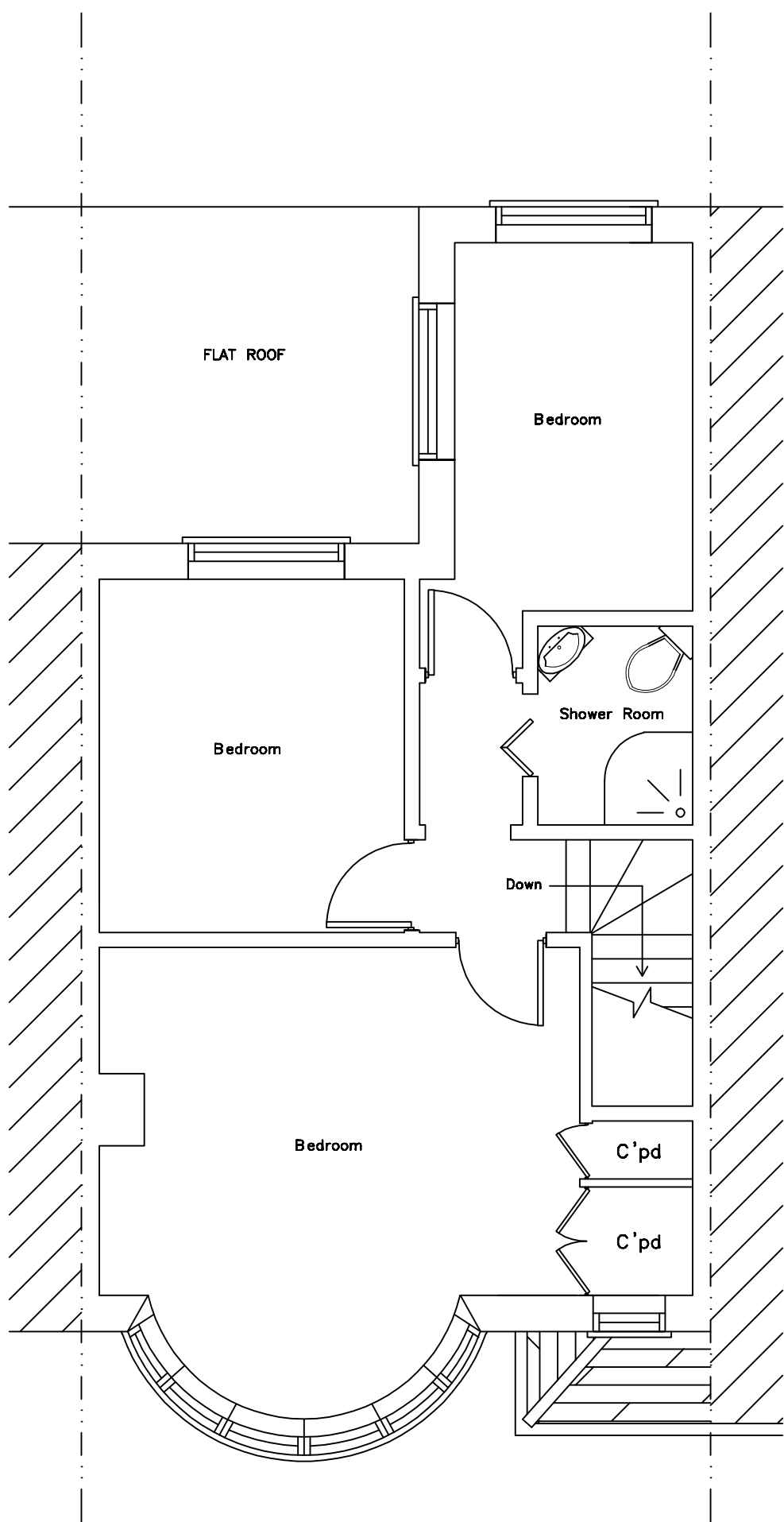

EXISTING FIRST FLOOR PLAN

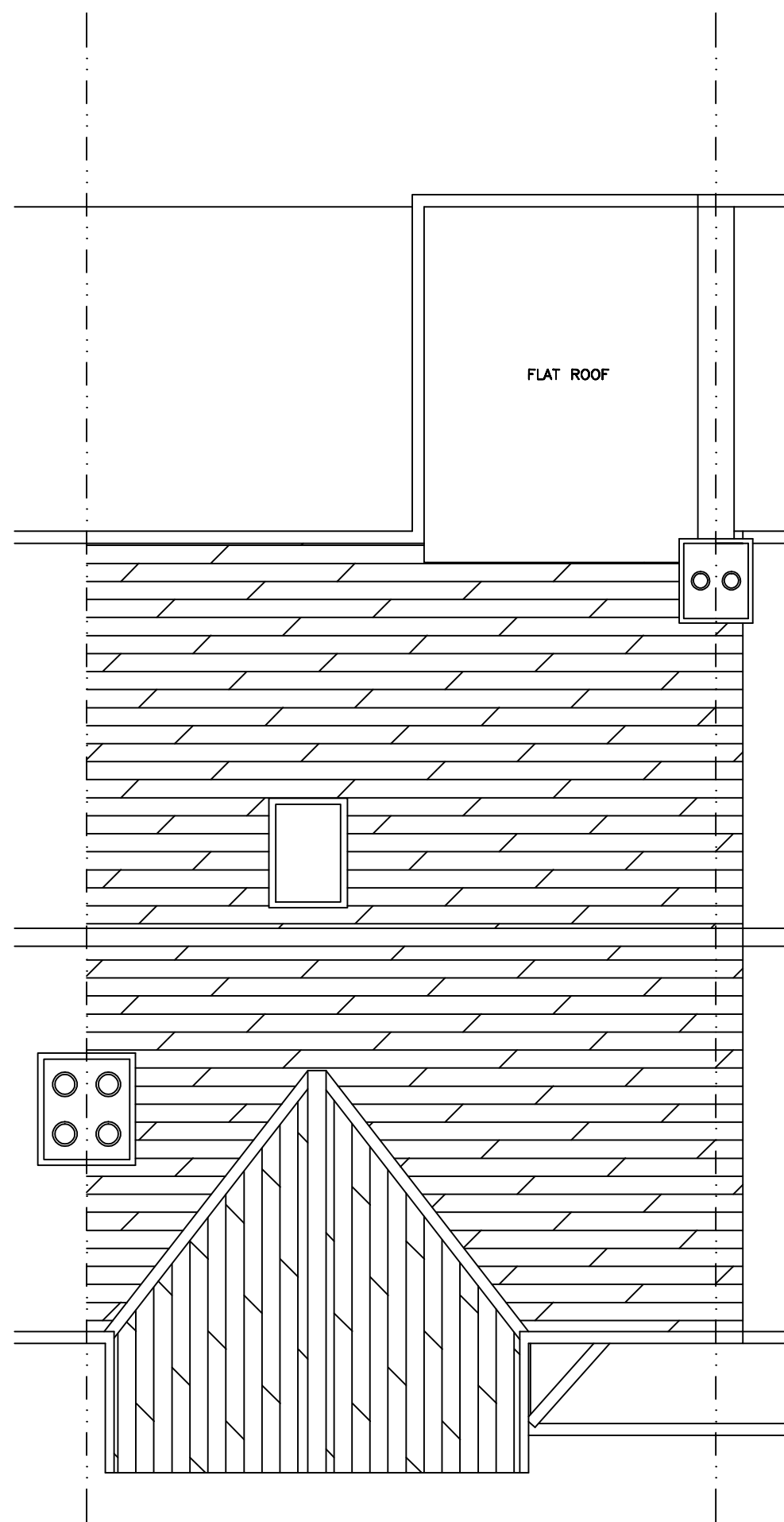

EXISTING ROOF PLAN

- Materials to match existing
- Doors to match existing
- Windows to match existing

SCALE 1:50

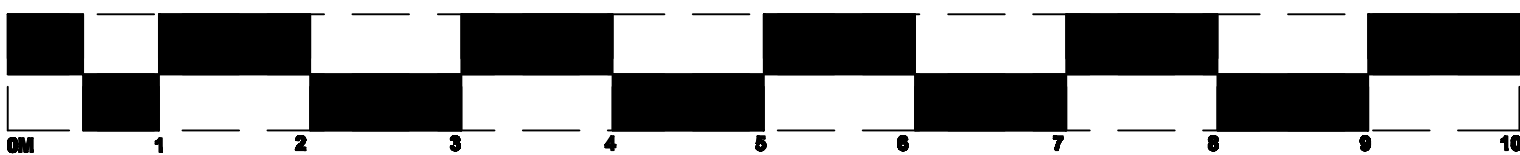

SCALE 1:100

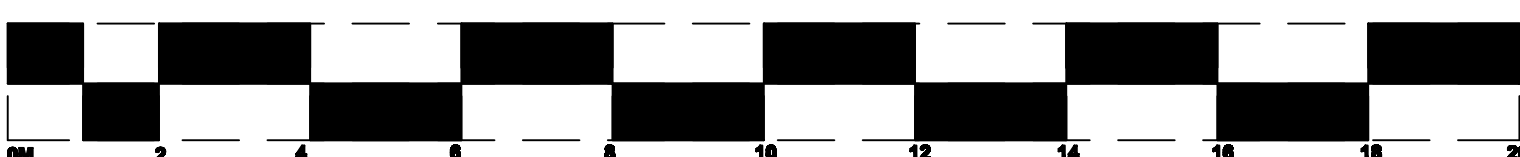

NOTES

- NECESSARY NOTICES ON RELEVANT ADJOINING OWNERS IN RESPECT OF WORKS ON THE PARTY WALL(S) ARE THE OWNERS RESPONSIBILITY. THE APPOINTMENT OF A PARTY WALL SURVEYOR IS ADVISED.
- ALL DIMENSIONS ARE TO BE CHECKED ON SITE BEFORE ORDERING MATERIALS OR COMMENCING WORK.
- IN CASE OF DISCREPANCIES IN DRAWINGS OR DETAILS REFER TO DRAWINGMAN FOR CLARIFICATION BEFORE CREATING WORKS COMMENCE.
- UNILATERAL DECISIONS BY CLIENT OR CONTRACTOR WILL NOT BE ACCEPTED. DRAWINGMAN DOES NOT ACCEPT RESPONSIBILITY FOR ADDITIONAL COSTS OR ADDITIONAL MATERIALS ETC. AS A RESULT OF UNILATERAL DECISIONS.
- FOR ANY INFORMATION NOT COVERED BY THESE DRAWINGS REFER TO DRAWINGMAN FOR CLARIFICATION.
- THE CONTRACTOR MUST ENSURE THAT THE WORK IS BEING CARRIED OUT TO THE LATEST REVISIONS OF ALL WORKING DRAWINGS BEFORE WORKS COMMENCE.
- IT IS THE CONTRACTORS RESPONSIBILITY TO INFORM THE LOCAL AUTHORITY BEFORE WORK COMMENCES ON SITE AND AT ALL PRESCRIBED STAGES OF WORK THAT THE PROJECT SURVEYOR MAY REQUIRE.
- IF WORK COMMENCES ON SITE BEFORE FULL PLANS APPROVAL HAS BEEN GIVEN THE DRAWINGMAN ACCEPTS NO RESPONSIBILITY FOR ANY ADDITIONAL WORK OR MATERIALS THAT THE PROJECT SURVEYOR MAY REQUIRE.
- THIS DRAWING AND ALL COPIES PRODUCED REMAIN THE COPYRIGHT AND PROPERTY OF THE DRAWINGMAN. IT MAY ONLY BE REPRODUCED BY THE DRAWINGMAN AND ALL COPIES MUST BE RETURNED TO THE DRAWINGMAN IF DEMAND.
- BY USING THIS DRAWING THE USER AND HIS EMPLOYEES SIGNIFY THEIR AGREEMENT OF THE ABOVE TERMS AND CONDITIONS.
- THIS DRAWING AND OTHERS IN RESPECT TO THIS PROPERTY WILL FORM PART OF THE CONTRACT DOCUMENTATION AND ARE TO BE READ IN CONJUNCTION WITH THE SPECIFICATION ACCOMPANYING THESE DRAWINGS.

