

100mm thk MOT Type 1 aggregate laid and compacted in two layers of 50mm

Detail A - Footpath

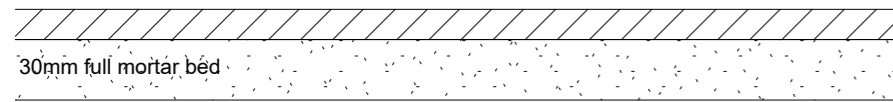

100mm thk MOT Type 1 aggregate laid and compacted in two layers of 50mm

Detail C - Disabled Markings

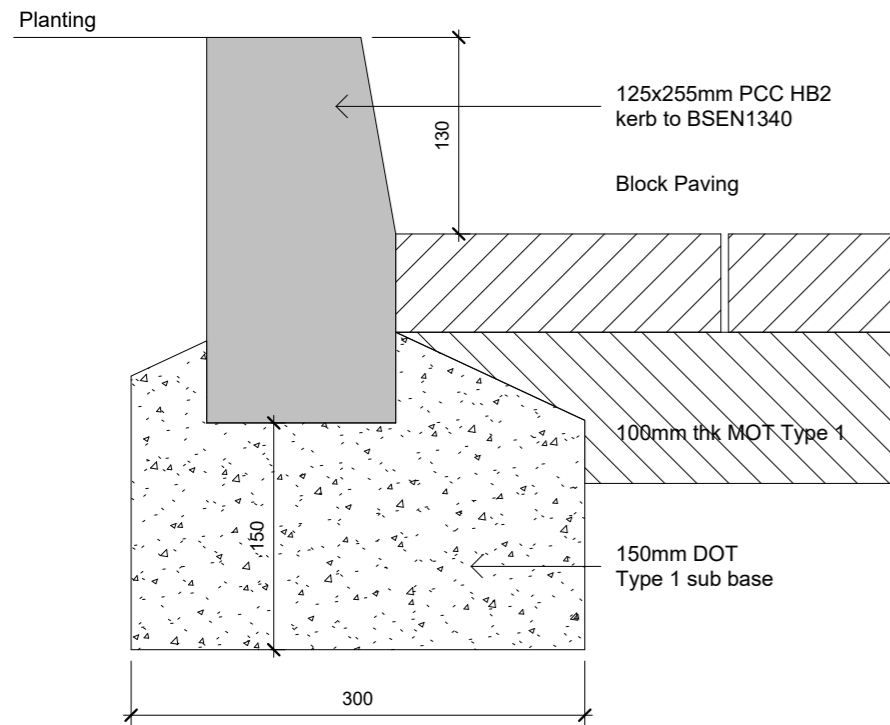

Detail E - Full Height Kerb

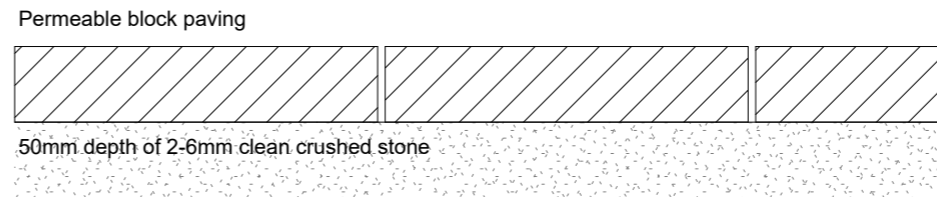

Detail B - Parking

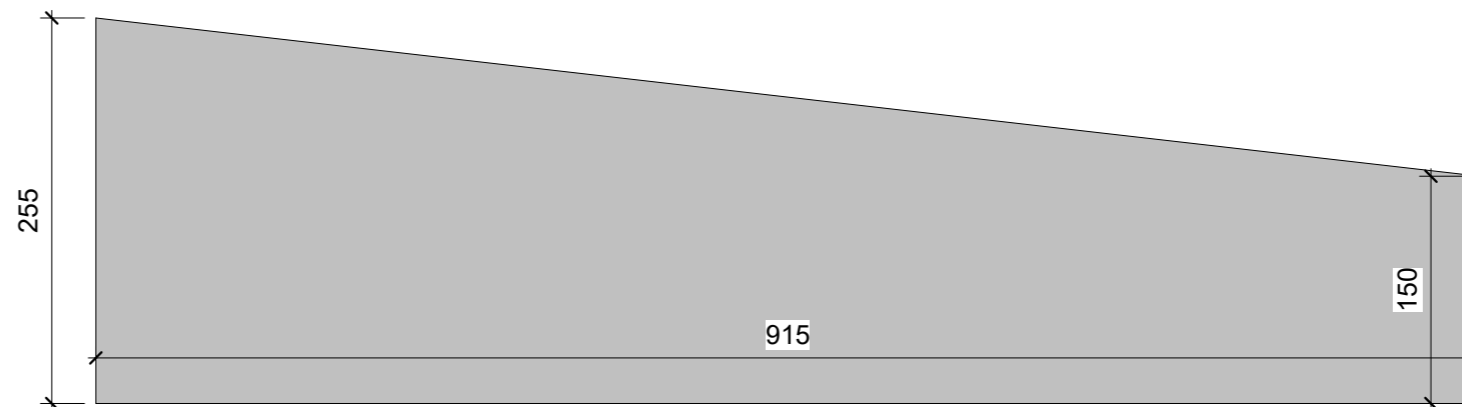

Detail D - Transition Kerb

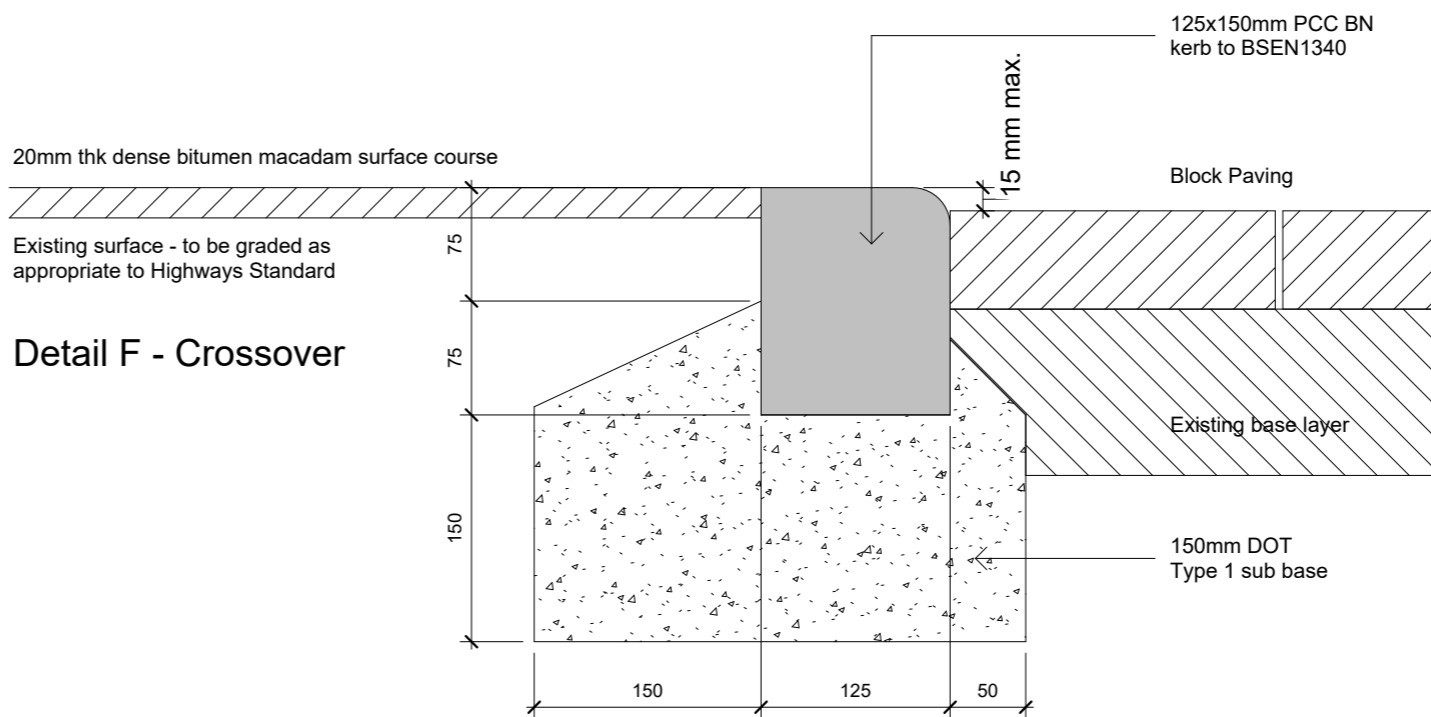

Detail F - Crossover

Detail G - Dropped Kerb

All dimensions and levels to be checked on site by contractor prior to preparation of shop drawings and commencement of work on site.

DO NOT SCALE FROM THIS DRAWING. IF IN DOUBT ASK.

This drawing and the copyrights and patents therein are the property of ALLEN CONSTRUCTION CONSULTANCY LTD and may not be used or reproduced without prior consent.

This drawing is to be read in conjunction with all relevant Consultant's and/or specialist's drawings and documents. Any discrepancies or variations are to be notified to ALLEN CONSTRUCTION CONSULTANCY LTD before the affected work commences.

General Notes:

1. Details A-C to be by Marshalls or equal approved and installed as per manufacturers recommendations.
2. Details D, E, F, G (public highway) to match existing and installed as per highways standard.
3. Detail F existing kerb to be carefully removed and relocated as per drawing.
4. Finished areas to be made good.
5. For detail B area plan refer to drainage layout drawing 6703-ACC-00-XX-DR-A-0005. For Hard Landscaping layouts refer to drawing 6703-ACC-00-XX-DR-A-0008.

| | | | |
|-----|--------------|----------|-----------|
| T0 | Tender Issue | 17/06/24 | AJH |
| Rev | Description | Date | Issued by |



Highlands House, Highlands Road, Shirley, Solihull, B90 4ND

Tel: +44 (0)121 765 2900
Email: info@allen.uk.com

Client



Proposed Replacement Dwellings at 2 Vernon Drive, Harefield, Uxbridge, UB9 6EG

Detail - Paving & Kerbs

| | |
|-------------|-------------------------|
| Project No. | 6703 |
| Date | 28/03/24 |
| Drawn by | AJH |
| Checked by | PQ |
| Dwg | 6703-ACC-00-XX-DR-A-520 |
| Scale@A3 | 1 : 5 |
| Rev. | T0 |