

| | | | | |
|---|----------------------|----------|-----|-----|
| A | Updated to comments. | 25.06.25 | EAB | JW1 |
| B | Updated to comments. | 02.07.25 | EAB | JW1 |

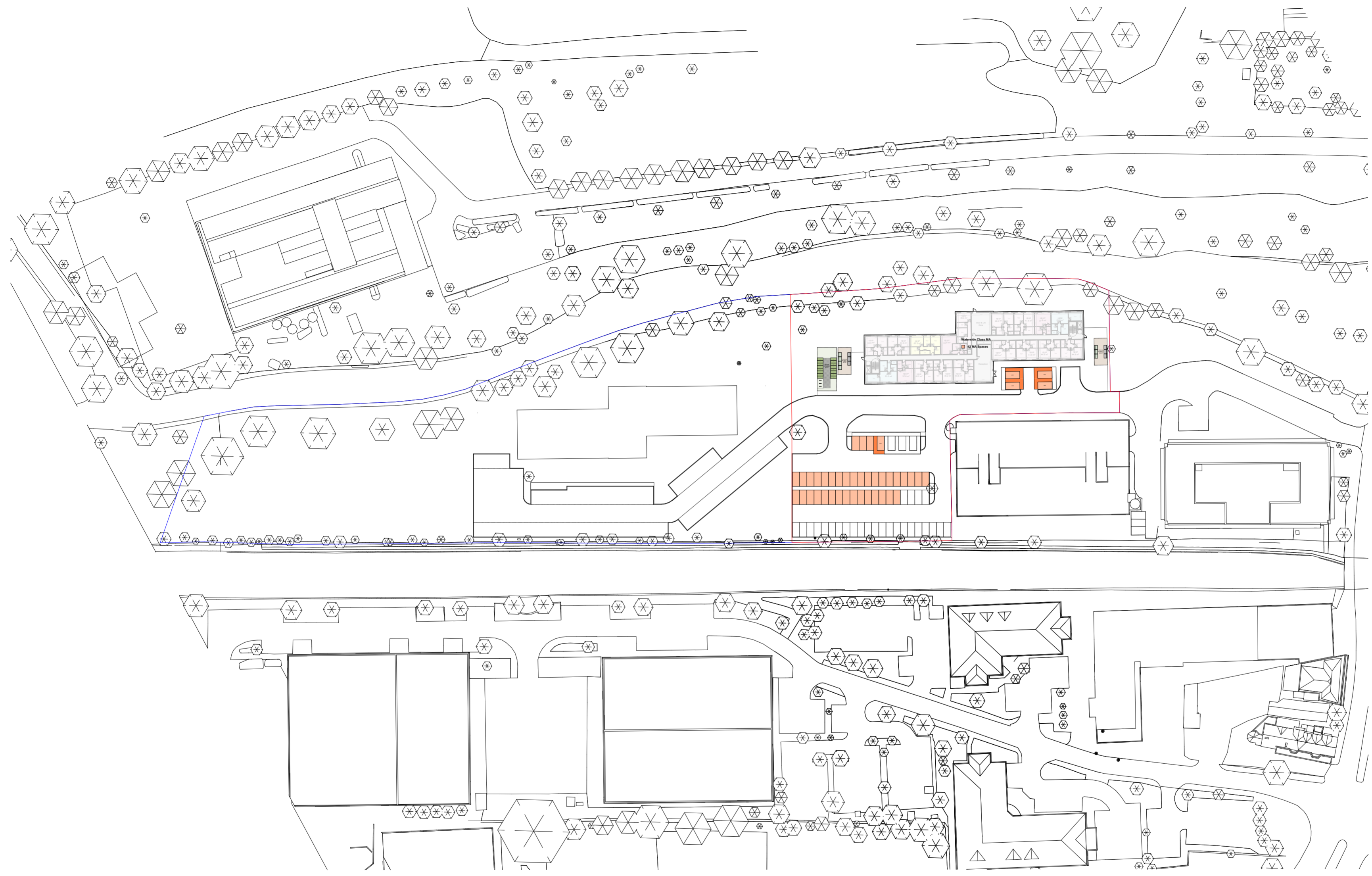

- Key:**
- Application Site Boundary Line
 - Ownership Boundary Line
 - 1B1P (1B1P* = Studio)
 - 1B2P
 - 2B3P
 - 2B4P

PLEASE NOTE: All drawing information is indicative and subject to further design development & detail design. Position and extent of all utilities (overground & underground), easements, topographical features & trees to be confirmed and subject to further surveys. Exact site boundary position TBC through land registry plan and further on site investigations. Layout design is drawn for feasibility & discussion purposes only and has been based on PDF survey information that is subject to a full measured building survey.

This sketch is indicative only and based on incomplete survey information. Core areas are assumed to contain vertical circulation but remain unverified. The proposal is subject to full measured, structural, and M&E surveys, and is for feasibility/discussion purposes only.

- Further design development will be required to address:
- A compliant fire strategy, including means of escape, protected lobbies, evacuation lift requirements, and fire-rated construction;
 - Acoustic and thermal performance in line with Building Regulations, including potential enhancements between residential uses;
 - Ventilation to habitable spaces and shared areas per Approved Document F, plus assessment of overheating risk (Part O);
 - Structural capacity of the existing building to support residential conversion and associated loadings;
 - Natural light provision and daylight/sunlight performance in accordance with BRE guidance;
 - Services coordination, including drainage, vertical risers, and ventilation routes;
 - Access and inclusivity, including potential lift upgrades and Part M compliance;
 - Waste and cycle storage arrangements;
 - Assessment of hazardous materials (e.g., asbestos) within the existing fabric.
- All elements remain subject to detailed technical input, further surveys, and compliance with current planning and building regulations.



Project: Riverview & Waterside House, Uxbridge
 rg+p proj. reference: 103-268

Status: Feasibility

Client: Highgrass Ltd

Package: / Permitted Development - Class MA

Sheet Title: Proposed Site Plan - Class MA (Waterside House)

Scale: 1:1.76, 1:1000@A2

Date: 04.07.2025

Drawn by: EAB
 Checked by: JW1

Drawing reference: 103-268_(SK)022

London | Birmingham | Leicester
 0203 327 0381 | 0121 309 0071 | 0116 204 5800
 rg-p.co.uk · design@rg-p.co.uk

Notes:
 All designs should be constructed in strict accordance with building regulations. In addition any materials, components and fixings in/on connected to a façade should be non-combustible if the top storey of the building is above 11m.
 All dimensions to be checked on site. Do not scale off this drawing for construction purposes. This drawing is the copyright of the Architect, and not to be reproduced without their permission. Ordnance Survey map information reproduced with permission of HMSO Crown Copyright reserved. rg+p Ltd. Trading as rg+p

Waterside House Accommodation Schedule - Class MA

| Level | Storey Height (m) | 1B1P | | 1B2P | | 2B3P | | 2B4P | | Refuse & Cycle | Total Units | Total Beds | GIA (m ²) | NSA (m ²) | NSA/GIA | |
|--------------|-------------------|-------------------|---------------------|-------------------|-------------------|-------------------|-------------------|------------------|----------------|-------------------|-------------------|------------|-----------------------|-----------------------|---------------------|-----|
| | | 40m ² | NSA | 50m ² | NSA | 61m ² | NSA | 70m ² | NSA | | | | | | | |
| GF | 15 | 678m ² | 2 | 107m ² | 1 | 62m ² | 0 | m ² | | 171m ² | 18 | 19 | 1,202m ² | 847m ² | 70% | |
| 01 | 15 | 678m ² | 2 | 107m ² | 2 | 129m ² | 0 | m ² | | | 19 | 21 | 1,202m ² | 914m ² | 76% | |
| 02 | 15 | 678m ² | 2 | 107m ² | 2 | 129m ² | 0 | m ² | | | 19 | 21 | 1,202m ² | 914m ² | 76% | |
| Total | 0.00 | 45 | 2,034m ² | 6 | 321m ² | 5 | 321m ² | 0 | m ² | | 171m ² | 56 | 61 | 3,606m ² | 2,675m ² | 74% |
| Mix | | | 80.4% | | 10.7% | | 8.9% | | 0.0% | | | | | | | |

| | |
|--------------------------|----|
| Total Units | 56 |
| Total Cycle Spaces | 70 |
| Total Car Parking Spaces | 42 |

