

USE FIGURED DIMENSIONS ONLY. DO NOT SCALE FROM THIS DRAWING EXCEPT FOR PLANNING PURPOSES. ALL DIMENSIONS MUST BE CHECKED ON SITE. ANY INCONSISTENCIES MUST BE REPORTED BACK TO THE ARCHITECT. THIS DRAWING AND ANY DESIGNS INDICATED THEREON ARE THE COPYRIGHT OF BROOKS / MURRAY ARCHITECTS. ALL RIGHTS ARE RESERVED. NO PART OF THIS WORK MAY BE PRODUCED WITHOUT PRIOR PERMISSION IN WRITING FROM BROOKS / MURRAY ARCHITECTS. PLANNING STAGE DRAWINGS SHOULD NOT BE USED FOR CONSTRUCTION.

REV.	AMENDMENT	BY:	DATE
A	Car Parking Allocation Revised Issued for planning	CM	01.09.21
B	Car Parking Allocation Revised	CF	30.05.22

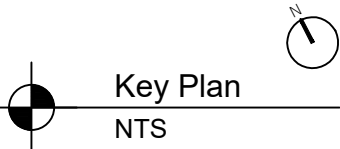
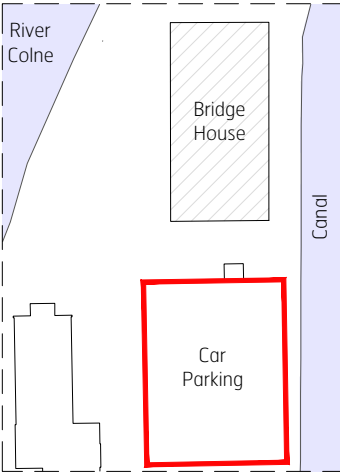

The following 17 car parking spaces will be allocated to the 25 unit upward extension permission ref 40050/APP/2018/1737: 8-9, 31-38. This includes three disabled spaces and four electrical charging points (two passive and two active).

The remaining spaces will be allocated to the prior approval planning permission ref:40050/APP/2019/1865

Brooks Murray Architects
The Arts Building, Morris Place, N4 3JG
+44 (0)2077399955 architects@brooksmurray.com

brooks murray

CLIENT:
Xone Kontrol

JOB:
Bridge House
Uxbridge
UB8 1HS

DRAWING TITLE:
Parking Allocation Plan
Internal Car Parking - Ground Floor

SCALE:
1:200 @ A3

DATE:
MAY 2022

STATUS:
PLANNING

DRAWING NUMBER:	REV:	ISSUED BY:
1253.01 - 1001	B	CF

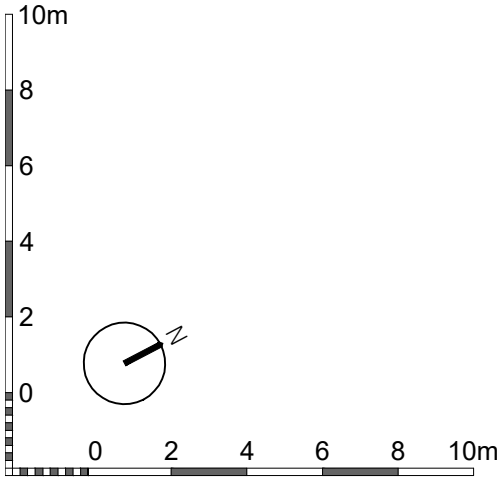
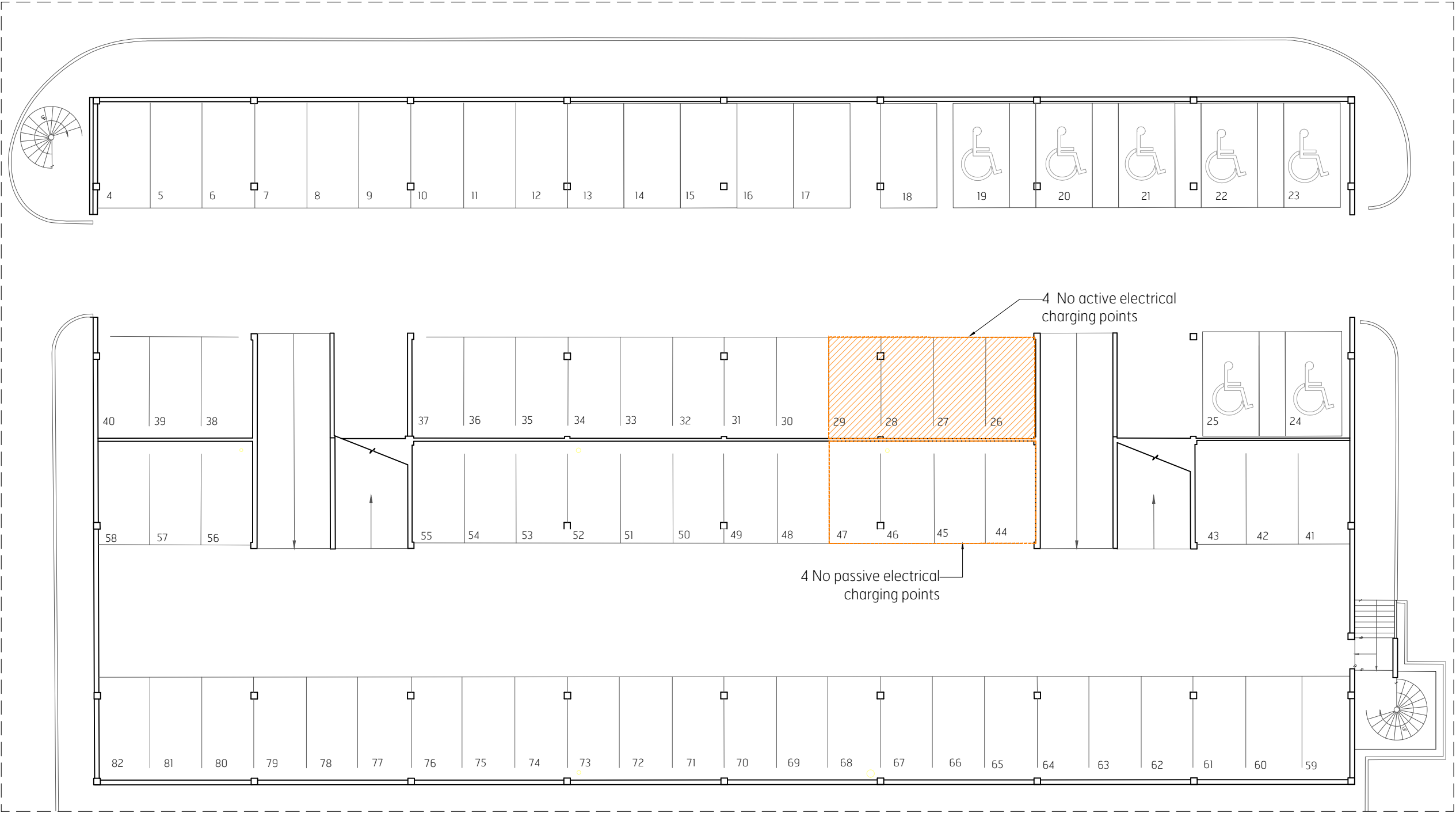

Parking Allocation Plan
Internal Car Parking - GF