

general notes:
Do Not Scale. All dimensions and conditions are to be checked on site prior to preparing drawings or commencing any work.

This drawing is the property of Cre8:Portfolio and protected by the Copyright, Designs and Patents Act, 1988

- Site:
- 1) Site Area - 369sqm
 - 2) Main Building Foot print 101sqm

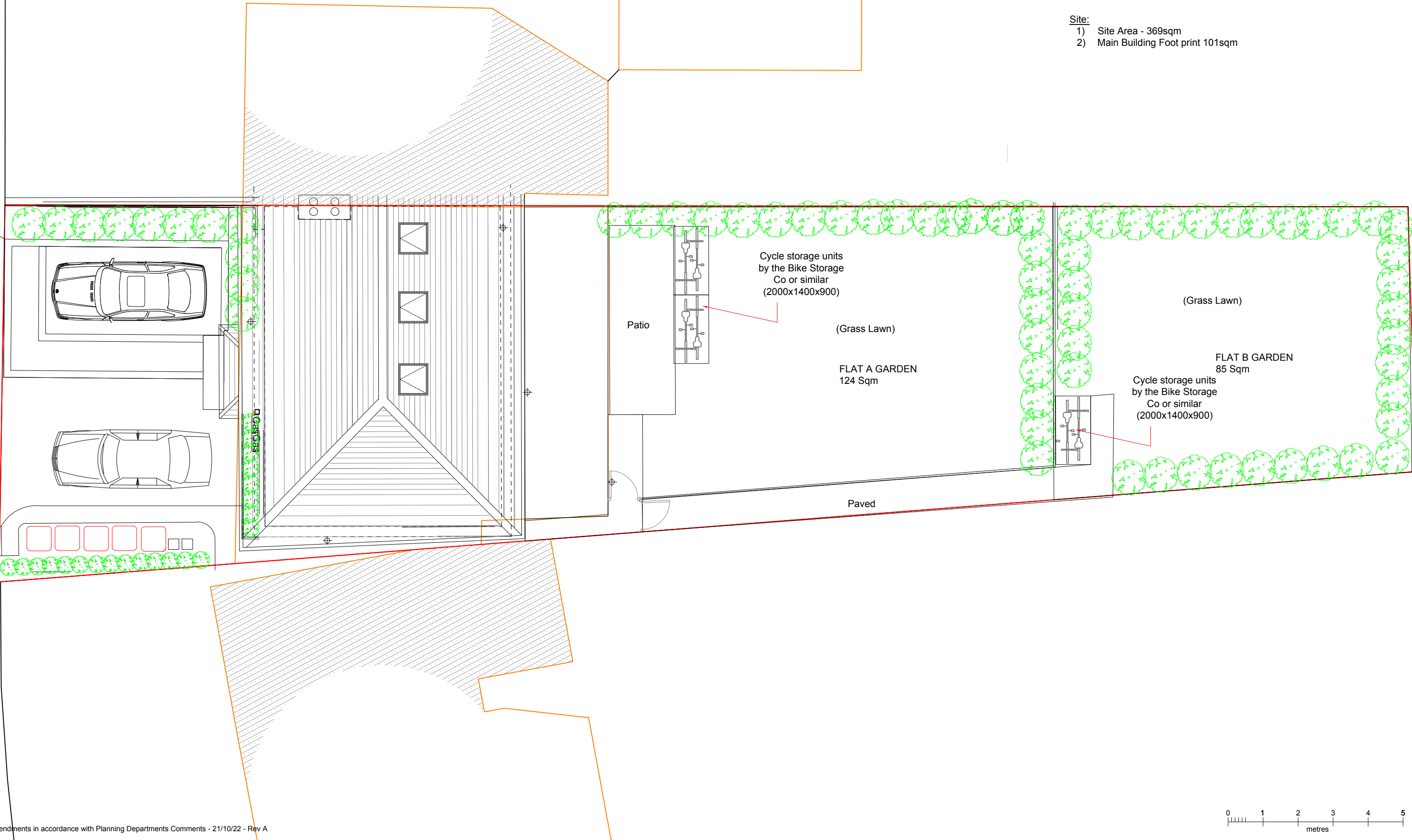

Amendments in accordance with Planning Departments Comments - 21/10/22 - Rev A

<div>Cre8:Portfolio</div> <div>ARCHITECTURE . INTERIOR DESIGN . PROJECT MANAGEMENT</div> <div>63 Twyford Road Harrow, HA2 0SH</div> <div>gocreate@cre8portfolio.com</div> <div>M: +447855596063</div> <div>www: cre8portfolio.com</div>	NOTE: Do not scale off drawings.. Read in conjunction with associated information. All dimensions are to be checked on site by the Contractor prior to commencement of works on site, discrepancies shall be referred to the Architect for clarifications in the event of discrepancies following site check measurements. Supply of the drawing in digital form is for convenience only and no reliance may be placed on any data in digital form. All data must be checked against hard copy. This drawing is issued for Statutory Application and Design Intent only and not for construction unless stated. All Materials, Methods of Storage, and installation shall be in accordance with the current British Standards, Approved Codes of Practice,Manufacturer's recommendations and other recognised certification.		Site Address 56 DALE DRIVE HAYES UB4 8AU	Project Title Semi Detached Seven bed House conversion to form two flats	Drawing Sheet PROPOSED SITE PLAN		Project number 020522	Drawing number PLA-305	Purpose Full Planning Application	
					Drawn by AO	Checked by AO	Scale 1/100@A3	Revision A	Date May 2022	