

COPYRIGHT RESERVED
DO NOT SCALE FROM THIS DRAWING

DRAWING LOCATION PLAN

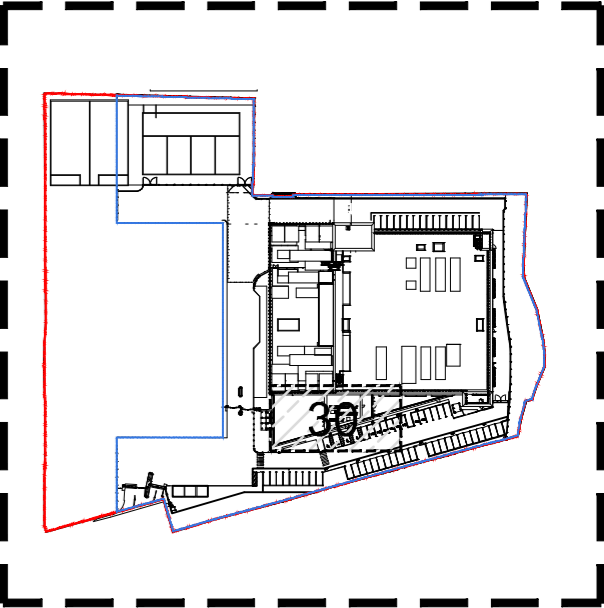

- NOTES:**
- Accessible water point required to allow maintenance operatives to easily service the landscaped areas.
 - All lighting to be connected to a single circuit with one on/off switch and controlled timer.
 - All levels given are to top of paving.
 - Support structure specification & working drawings to be provided by RAAFT.
 - To be read in accordance with BCA drawing 'DCS20109 - BCA - DC - 01 - LP - DR - L - 10208 - Roof Terrace Sections', 'DCS20109 - BCA - DC - 01 - LP - DR - L - 10209 - Roof Terrace Planter Specification', 'DCS20109 - BCA - DC - 01 - LP - DR - L - 10210 - Roof Terrace Details Sheet'.

KEY

Surfacing



PORCELAIN PAVING
RAAFT ATRIA Porcelain Pavers. Size: 300x1200x20mm. Colour: Como Brown. Code: 914111. Wind uplift resistant. To be installed in accordance with manufacturers specification. Supplied by RAAFT or similar approved. Where additional support is required, struts & structural panels to be used.

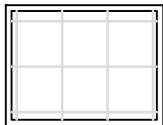

PORCELAIN PAVING
RAAFT Atria+ Porcelain Paving Slabs. Size: 600x600x20mm. Colour: Asti Taupe. Code: 9147014. Wind uplift Resistant. To be installed in accordance with manufacturers specification. Supplied by RAAFT or similar approved.

Support Structure

ADJUCSTABLE METAL PEDESTALS
RAAFT Adjustable metal pedestal (varying sizes to tackle drainage fall)
To be installed in accordance with manufacturers specification. Supplied by RAAFT or similar approved.

ALUMINIUM JOISTS
RAAFT Aluminium Joists. Size: 30mm x bespoke lengths. Code: 301015. To be installed in accordance with manufacturers specification. Supplied by RAAFT or similar approved.

JOIST BRACING STRUTS
RAAFT aluminium Bracing Strut. Size: 30x600mm
To be installed in accordance with manufacturers specification. Supplied by RAAFT or similar approved.

FLOOR STRUCTURE PANELS
RAAFT Floor Structure Panel. Size: 540x540x28mm
Material: Steel. To be installed in accordance with manufacturers specification. Supplied by RAAFT or similar approved.

Mechanical & Electrical

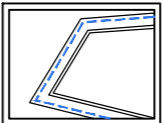

RECESSED STRIP LED LIGHTING
Lighting type & fixings to M&E engineers specification.
All lighting to be connected to a single circuit with one on/off switch and controlled timer.

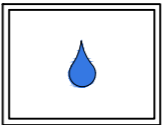

WATER POINT LOCATION
Accessible water point required to allow maintenance operatives to easily service the landscaped areas. To engineers specification.

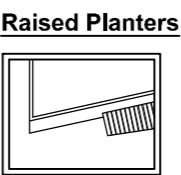

BESPOKE RAISED STEEL PLANTERS
RAAFT Prism & Straight Planterline Planter wall systems with Integrated Lighting & Cantilevered benches. Sizes: Bespoke. Colour: RAL 7043 - Traffic Grey B. Material: Stainless Steel. Finish: Powdercoated. To be installed in accordance with manufacturers specification. Supplied by RAAFT or similar approved.

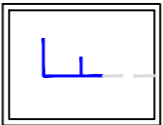

SECTION LINES
Refer to BCA drawing 'DCS20109 - BCA - DC - 01 - LP - DR - L - 10208 - Roof Terrace Sections'.

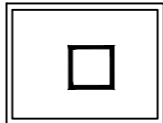

TIMBER SLATTED LITTER BIN
ARC8 FT SINGLE SIDED Litter Bin
Size: 530x550x1040mm. Capacity 110L.
Steel, Powdercoated to RAL 7043 - Traffic Grey B.
Ground fixed. Installed in line with manufacturers specification.

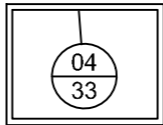

DETAIL MARKER
Refer to BCA drawing 'DCS20109 - BCA - DC - 01 - LP - DR - L - 10210 - 'Roof Terrace Details Sheet'.

REV	DESCRIPTION	BY	CKD	DATE
<div><div>BCA</div><div>BARRY CHINN</div><div>associates</div><div>Landscape Architects</div></div>				
CLIENT COLT DATA CENTRE SERVICES				
PROJECT COLT L4				
DRAWING TITLE ROOF TERRACE HARDWORKS PLAN				
CONTRACT NUMBER: 2179/21		DATE: 09-07-22		
DRAWING STATUS: PLANNING		CAD REFERENCE: 10207		
DRAWN BY: HC		CHECKED BY: MB		
SCALE: 1:100		ORIGINAL SHEET: A2		
PROJECT	ORIGINATOR	VOLUME	LEVEL	TYPE
DCS20109 - BCA - DC - 01 - LP - DR - L - 10207	S4	-		
Barry Chinn Associates Ltd, Herbury Road, Doppers Bridge, Southam, Warwickshire, CV47 2SZ Tel: +44 (0)1926 614031 Email: gini@bca-landscape.com Website: www.bca-landscape.com				