

© This drawing is copyright.  
It is sent to you in confidence and must not be reproduced or disclosed to third parties without our prior permission.

Do not scale from this drawing, other than for Local Authority Planning purposes.

This drawing is to be read in conjunction with all relevant consultants, specialist manufacturers drawings and specifications.

Any discrepancies in dimensions or details on or between these drawings should be drawn to our attention.

All dimensions are in millimetres unless noted otherwise.

Any surveyed information incorporated within this drawing cannot be guaranteed as accurate unless confirmed by fixed dimension.

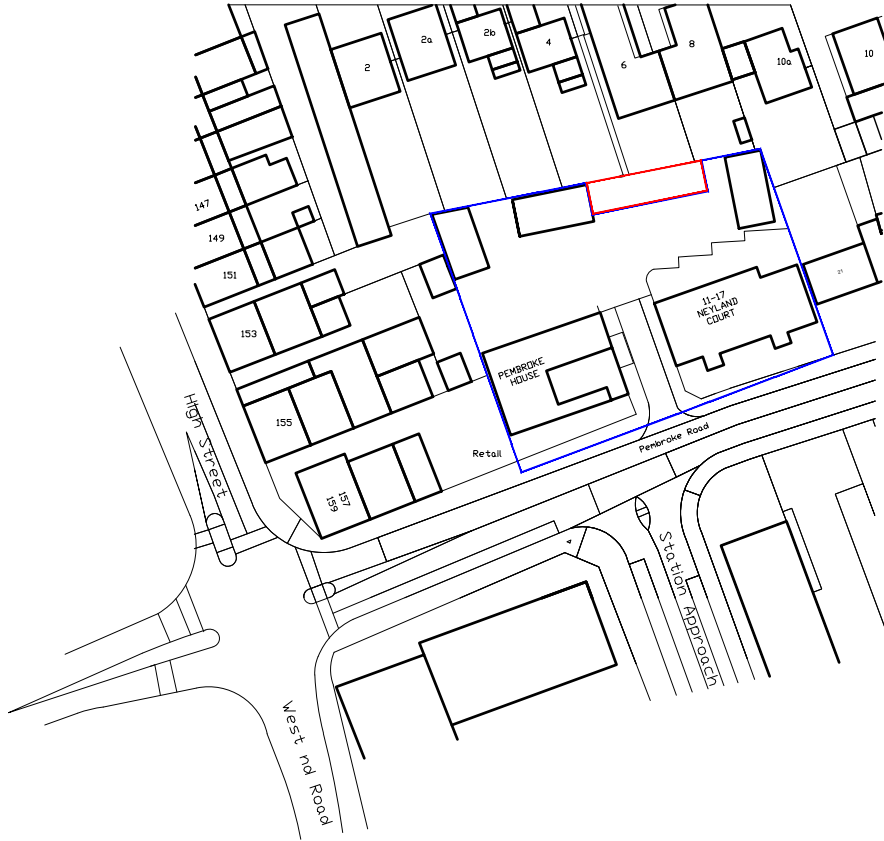

UKMap Copyright. The GeoInformation Group 2016 Licence No. LANDMLON100003121118

REV	DATE	DESCRIPTION	INITIAL	CHECKED
PLANNING				

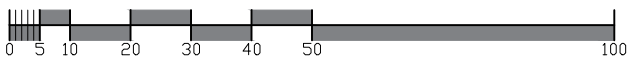
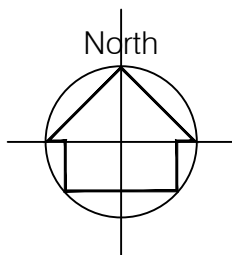

harding rose architects

CLIENT

ANSLIP UK LTD

PROJECT

Neyland Court, 11-17 Pembroke Road, Ruislip, HA4 8NQ

TITLE

Location Plan

SCALE

1:1250@A4

DATE

20.04.22

DRAWN

AC

PROJECT NO.

15.530

L.301