

Plan of Title

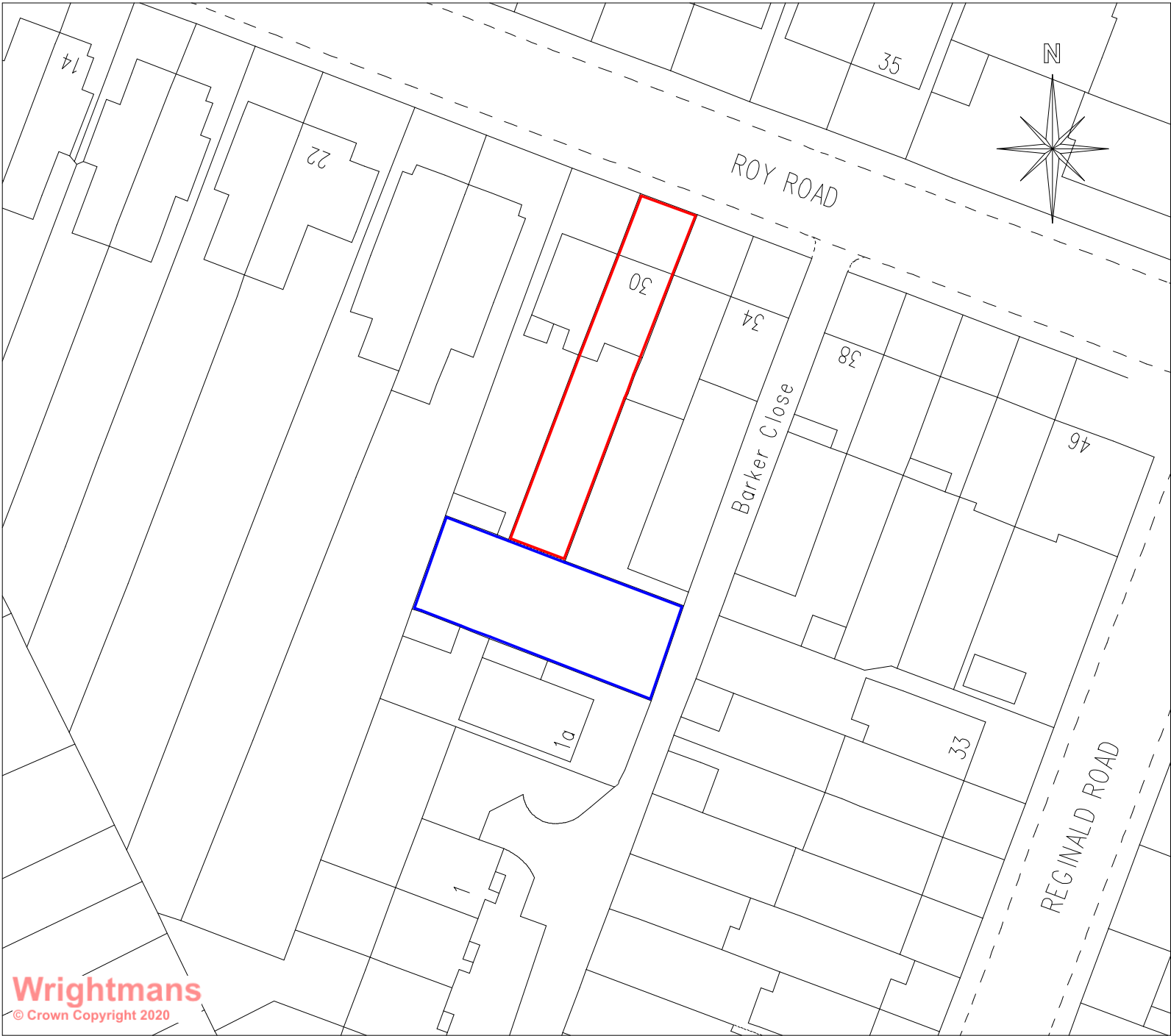

Land at
30 Roy Road
Northwood
Middlesex HA6 1EH

Scale 1:500

NOTE

The area edged red on the Plan indicates land removed from Title No. NGL24087 for the property known as 30 Roy Road, Northwood, Middlesex HA6 1EH as referred to in the Transfer.

The area edged blue on the Plan indicates land retained by Title No. NGL24087.

Wrightmans

Land Registry Compliant Plans

Winsor & Newton Building
Whitefriars Avenue, Harrow, Middlesex HA3 5RN
DX 42570 BUSHEY

t: 0844 800 1228
info@wrightmansplans.co.uk - www.wrightmansplans.co.uk

DRAWING TITLE
Plan of Title for land at
30 Roy Road
Northwood
Middlesex HA6 1EH



DRAWING NUMBER	REV
WP7342-C	
Additional copies of these Plans are available on request. We do not recommend submitting anything other than our original plans to the Land Registry as most reproductions will be rejected due to distortion and scaling inaccuracy.	SIZE
	A3

SCALE	DATE	DRAWN BY	APPROVED
1:500	07/01/2021	B.K.	E.G.