

Plan of Title

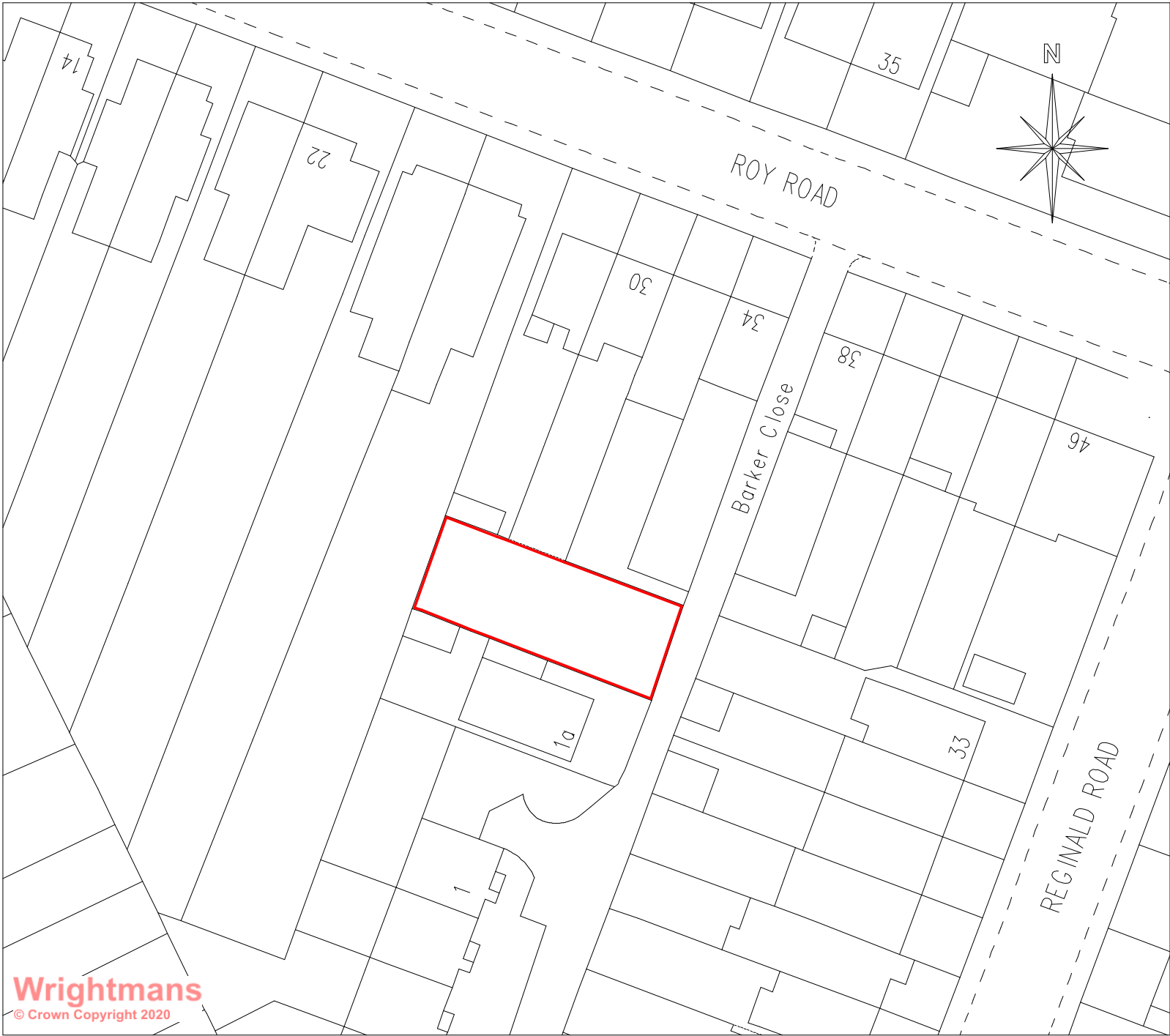

Land at the rear of  
30 Roy Road  
Northwood  
Middlesex HA6 1EH

Scale 1:500

NOTE

The area edged red on the Plan indicates land retained by Title No. NGL24087 for the land at the rear of 30 Roy Road, Northwood, Middlesex HA6 1EH.



Land Registry Compliant Plans

Winsor & Newton Building  
Whitefriars Avenue, Harrow, Middlesex HA3 5RN  
DX 80408 WEALDSTONE

t: 0844 800 1228  
info@wrightmansplans.co.uk - www.wrightmansplans.co.uk

DRAWING TITLE  
Plan of Title for land at the rear of  
30 Roy Road  
Northwood  
Middlesex HA6 1EH

DRAWING NUMBER WP7342-B	REV
<small>Additional copies of these Plans are available on request. We do not recommend submitting anything other than our original plans to the Land Registry as most reproductions will be rejected due to distortion and scaling inaccuracy.</small>	SIZE A3

SCALE 1:500	DATE 25/09/2020	DRAWN BY B.K.	APPROVED E.G.
----------------	--------------------	------------------	------------------

