

copyright Portakabin Limited 2017

This drawing is the property of Portakabin Limited.

It must not be copied or reproduced or divulged to anyone without written permission.

Do not scale off this drawing.

All discrepancies to be reported to Portakabin Limited.

Rev:	Date:	Description:	By:	Chk:
------	-------	--------------	-----	------

Foundation Notes.

Minimum height of foundation bases above ground level to be 50mm.

All bases to finish on same level (float finish of + or - 3mm)

The minimum base area required is 600mm x 600mm (for siting purposes) Foundations designed and constructed by others to suit site conditions and accept the loads shown. All to be subject to building control approval.

Load per leg = 36kN (76kN for two storey)

The loads are based on a building with 3 kN/m^2 floor loading, 0.75 kN/m^2 imposed roof loading and a basic wind speed of 50 m/s .

Double stacked jackleg units must be bolted to the foundations.

All *Lodastrut* legs should be fully retracted onto the safety stops with the leg pins fitted through the outer legs and secured by pulling the chain tight and locating it on the hook on the side of the leg.

Standard Colours.

External; Walls - Silk Grey nearest BS ref 10 A 05

Doors: - Golden Amber nearest BS ref 08 E 51

Roof fascia and trims - Blue Grey nearest BS ref 18 B 29

Legs - Blue Grey - BS 4800 18 B 29

Key.

O Opening window

F Fixed window

rwp Rain water pipe

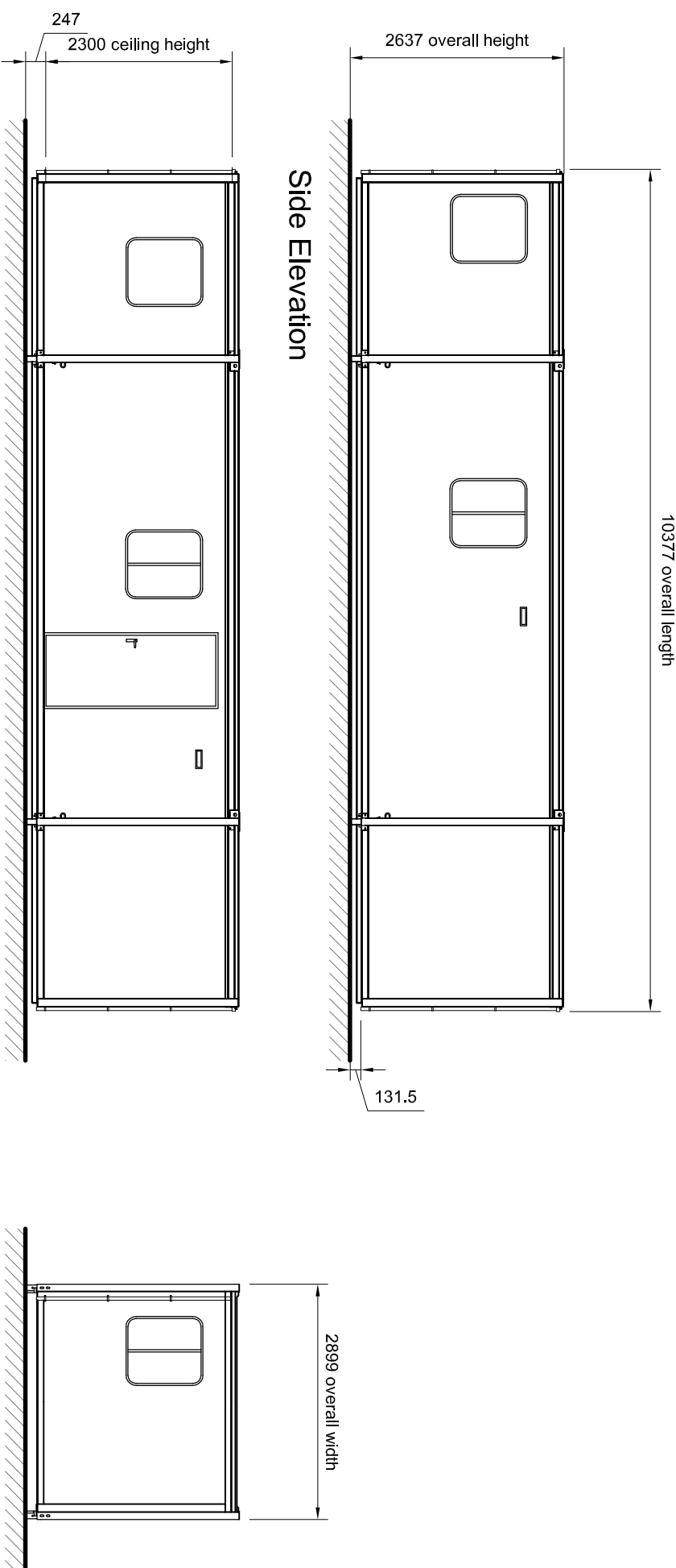

Side Elevation

End Elevations

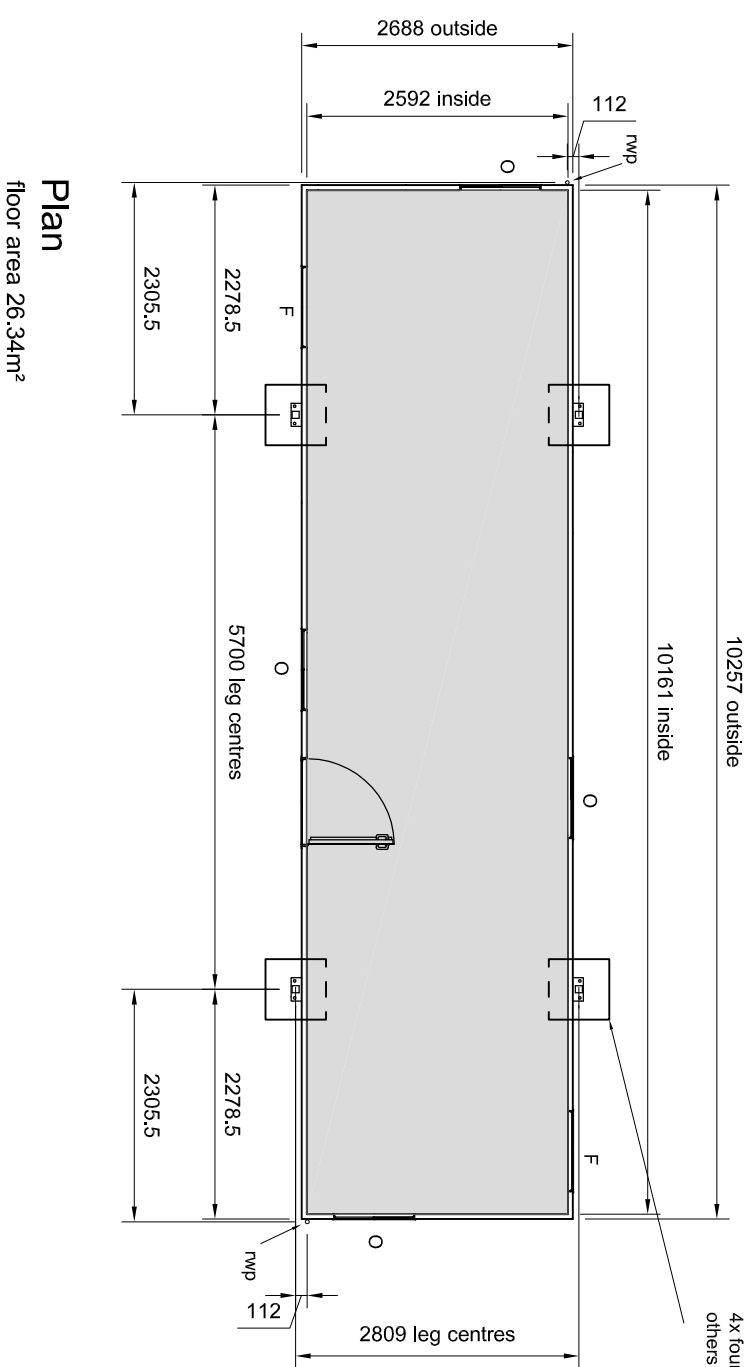

4x foundation pads by
others at leg base plates

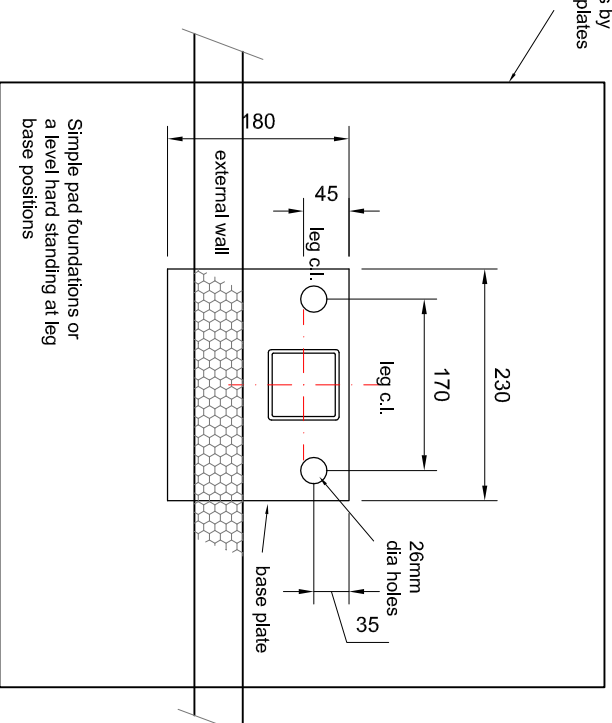

Simple pad foundations or a level hard standing at leg base positions

Leg Baseplate Detail

Plan view

Plan

floor area 26.34m²

Pacemaker 7 PK341

Portakabin®

Portakabin (Refurbished) Limited
Cattoss Lane Brandesburton
Driffield YO25 8ES

+44 (0)845 287 5962

portakabin.co.uk

Status:	Purpose Of Issue: As Built					
AB						
Client:						
Portakabin Refurbished Ltd						
Project:						
Portakabin Building Pacemaker Series 7						
Title:						
Specification Drawing PK341						
Sale @ AS:	Date:	Drawn By:	Checked By:			
1 to 75	2017	PG	SN			
Project Number:						
PK341 Series 7						
Originator:	Zone:	Level:	Type:	Discipline:	Number:	Rev:
PKR	00	GF	DR	A	01	0