

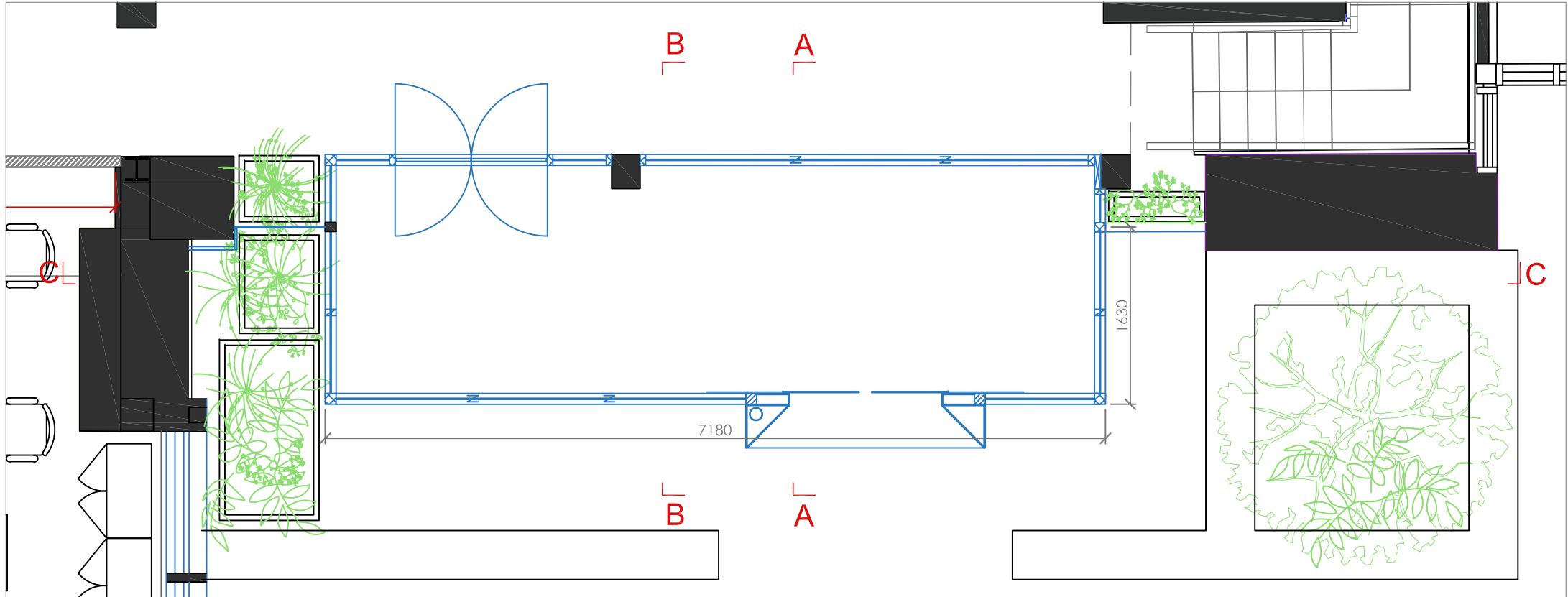

Proposed External Elevation



Proposed Internal Elevation



Plan
1:50

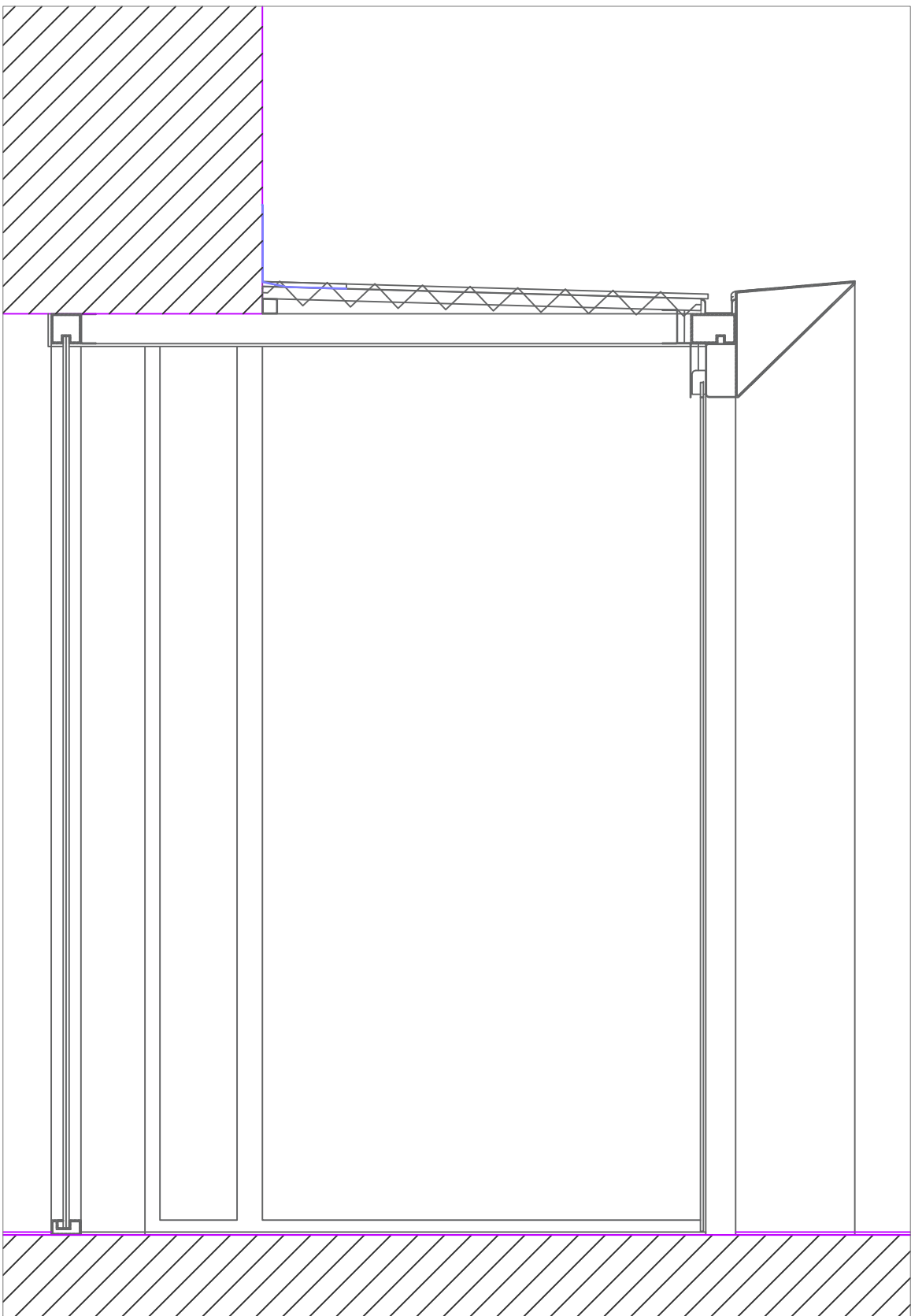

Section AA
1:20

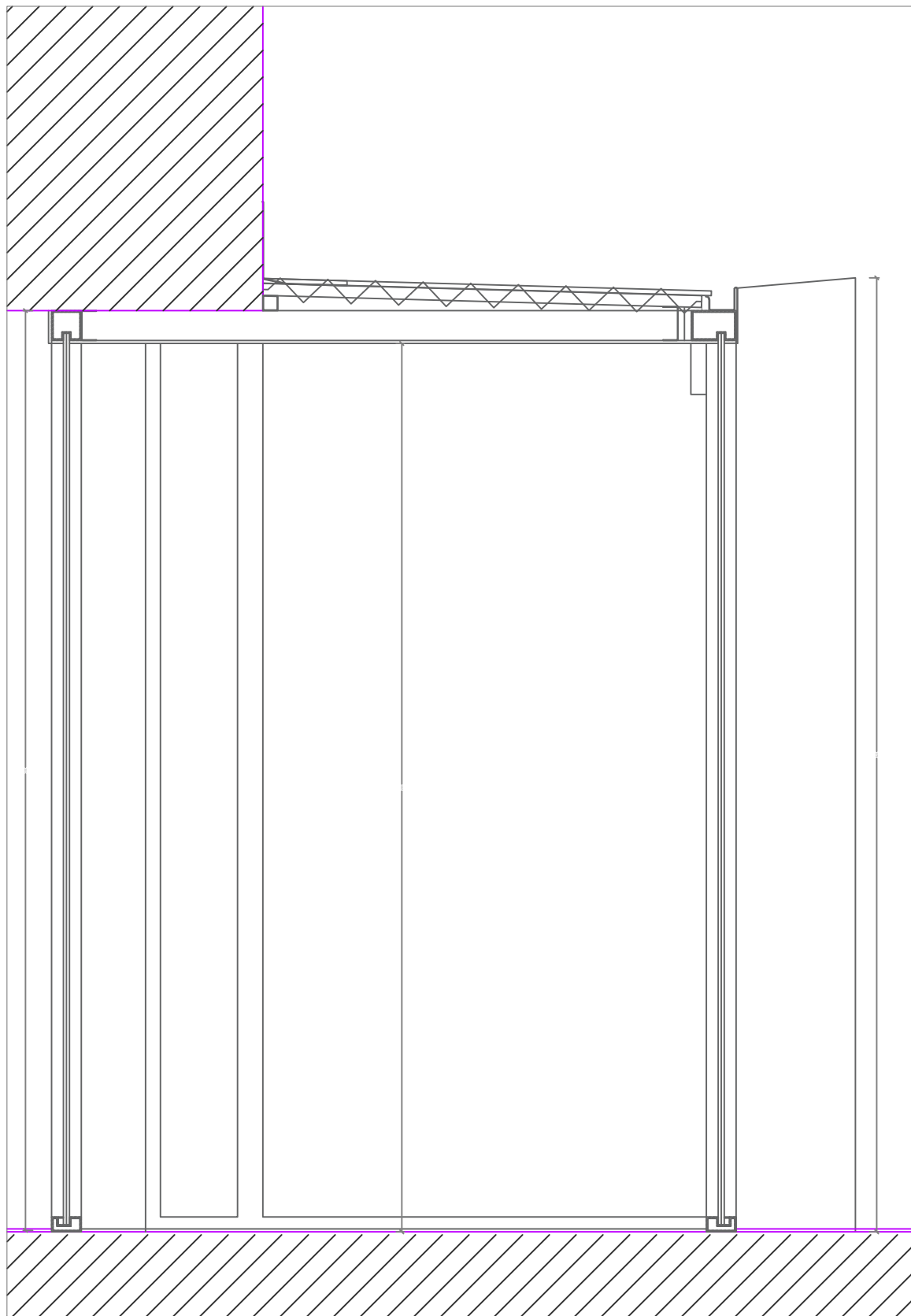

Section BB
1:20

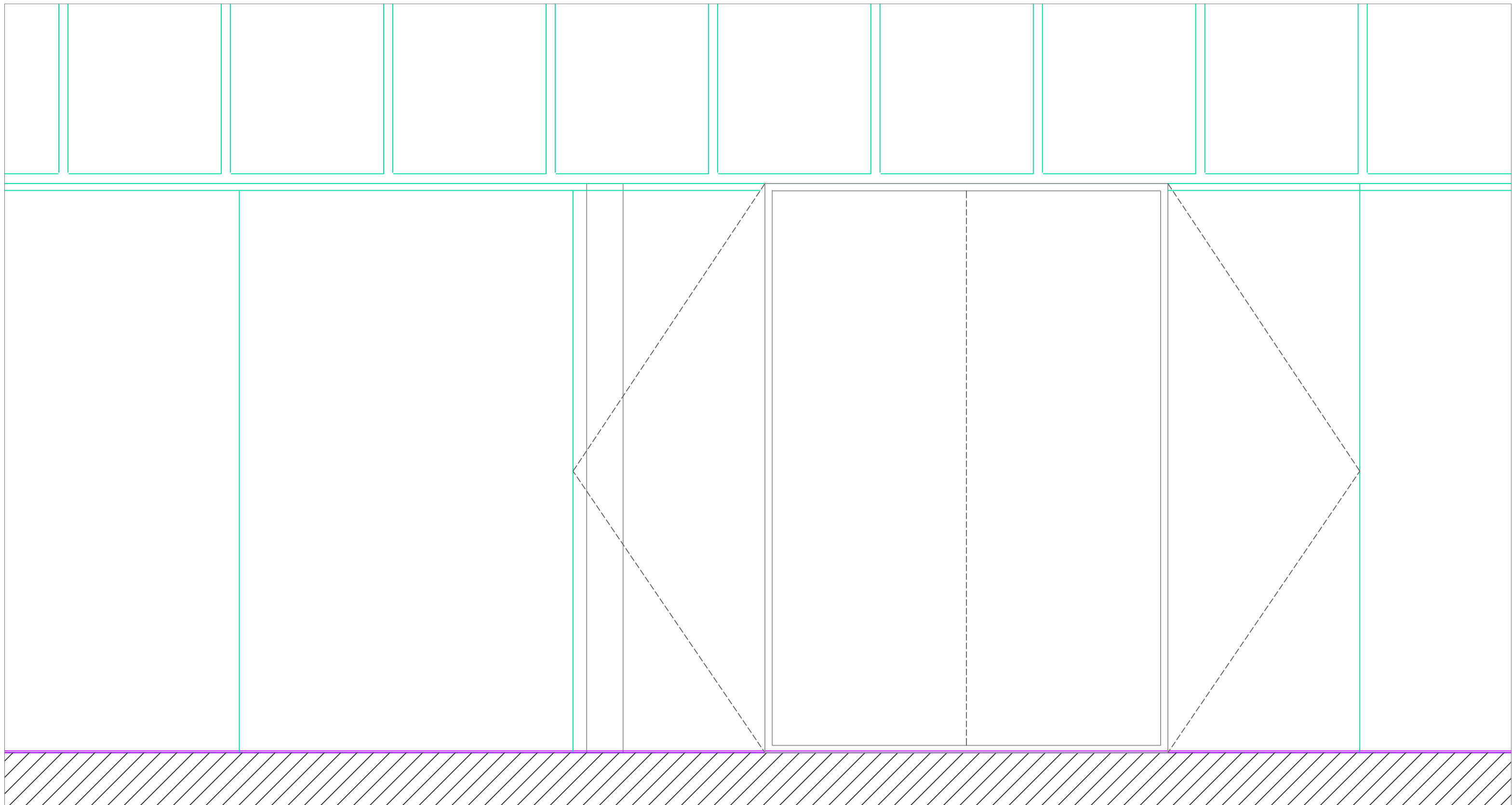

Section CC
1:20

Ground Floor - Proposed Sections

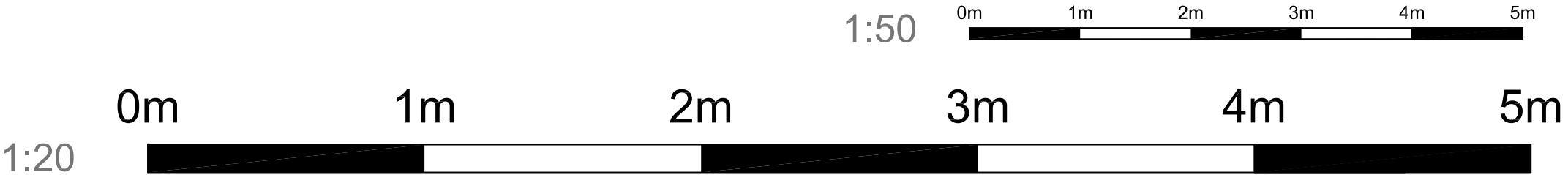

NOTES:

- All dimensions are in millimeters unless stated otherwise.
- All contractors are to check dimensions on site.
- Do not scale from this drawing.
- Check survey under taken only.
- Subject to local authority approval.
- This drawing is the property of Space Workplace

©Copyright is reserved and the drawing is issued on the condition that it is not copied, reproduced, retained or disclosed by any unauthorised person, wholly or in part, without the consent in writing of Space Workplace.

Rev	Details	Date
.	.	.

NOTE:
We do not use revisions letters I, O or Q to avoid confusion with numbers 0 & 1 or between the letters O & Q



Client:
MSC Cruises

Drawing:
**Proposed Sections
Ground Floor**

Property:
**5 Roundwood Avenue, Stockley
Park, Hayes, Uxbridge, UB11 1AF**

Drawing No: 2139_00_E07	
Date created: 06.05.25	Revision: .
Scale: Varies @ A1	Drawn by: DG

Golderbrock House
15-19 Great Titchfield St
London W1W 8AZ

020 7636 0525
www.spaceworkplace.com