

PROPOSED EAST ELEVATION 01  
1:100

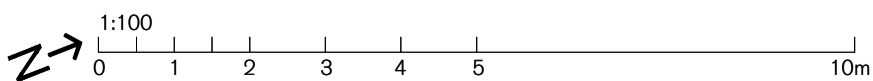
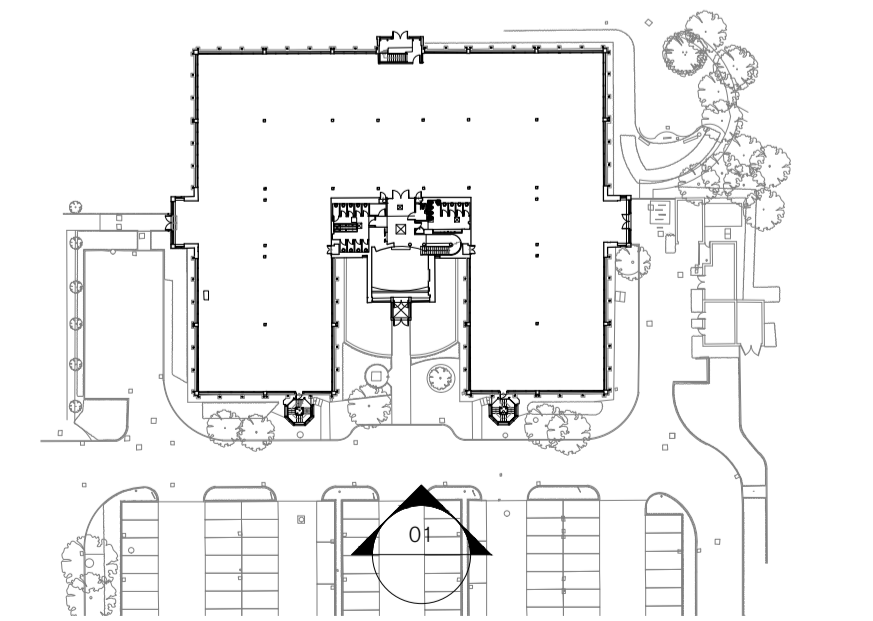

SPRATLEY & PARTNERS  
7 CENTENARY BUSINESS PARK, STATION ROAD, HENLEY-ON-THAMES, OXFORDSHIRE RG9 1DS. 01491 411277  
ISSUED ONLY FOR THE PURPOSE INDICATED. THIS DRAWING TO BE READ IN CONJUNCTION WITH ALL CONSULTANTS  
INFORMATION. ALL DIMENSIONS TO BE CHECKED ON SITE. DO NOT SCALE. THIS DRAWING IS COPYRIGHT.

REV.	ISSUED	DESCRIPTION	DRAWN	CHECKED
-	-	-	-	-
-	-	-	-	-
-	-	-	-	-

PROJECT	DESCRIPTION
ROUNDWOOD STOCKLEY PARK	PROPOSED EAST ELEVATION
CLIENT	CURVE

DATE	SCALE AT A1
MAR '23	1:100
STATUS	PLANNING
DRAWN	CW
CHECKED	LHB

JOB NO	22.041
DRAWING NO	PL.014
REV	-

S  
& P