

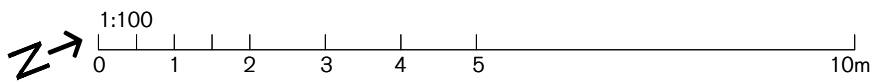

EXISTING EAST ELEVATION 01
1:100

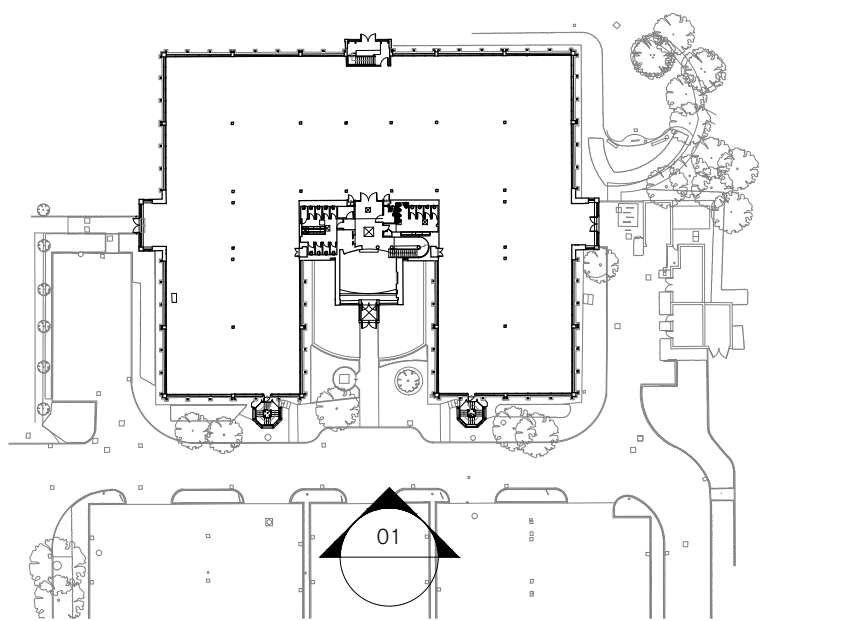

SPRATLEY & PARTNERS
7 CENTINARY BUSINESS PARK, STATION ROAD, HENLEY-ON-THAMES, OXFORDSHIRE RG9 1DS. 01491 411277
ISSUED ONLY FOR THE PURPOSE INDICATED. THIS DRAWING TO BE READ IN CONJUNCTION WITH ALL CONSULTANTS
INFORMATION. ALL DIMENSIONS TO BE CHECKED ON SITE. DO NOT SCALE. THIS DRAWING IS COPYRIGHT.

REV.	ISSUED	DESCRIPTION	DRAWN	CHECKED
-	-	-	-	-
-	-	-	-	-
-	-	-	-	-

PROJECT	DESCRIPTION
ROUNDWOOD STOCKLEY PARK	EXISTING EAST ELEVATION
CLIENT	
CURVE	

DATE	SCALE AT A1	JOB NO
MAR '23	1:100	22.041
STATUS	DRAWING NO	
PLANNING	PL.008	
DRAWN	CHECKED	REV
CW	LHB	-

S
& P