

Legend: New proposals

1.

New leveled floor.
2.

New raised stage.
3.

New white timber stained floor and level access.
4.

New white timber ramp.
5.

New white stained timber steps and floor level to match existing entrances.
6.

New shadow gap detail between wall, skirting and new floor.
7.

New curved wooden landing and steps with metal handrail.
8.

New feature staircase to new mezzanine.
9.

Relocated organ and collected samples from debris. Exact design TBC.
10.

New mezzanine lower tier to sit over existing mezzanine.
11.

New upper mezzanine.
12.

Refurbished BOH spaces.

B

F

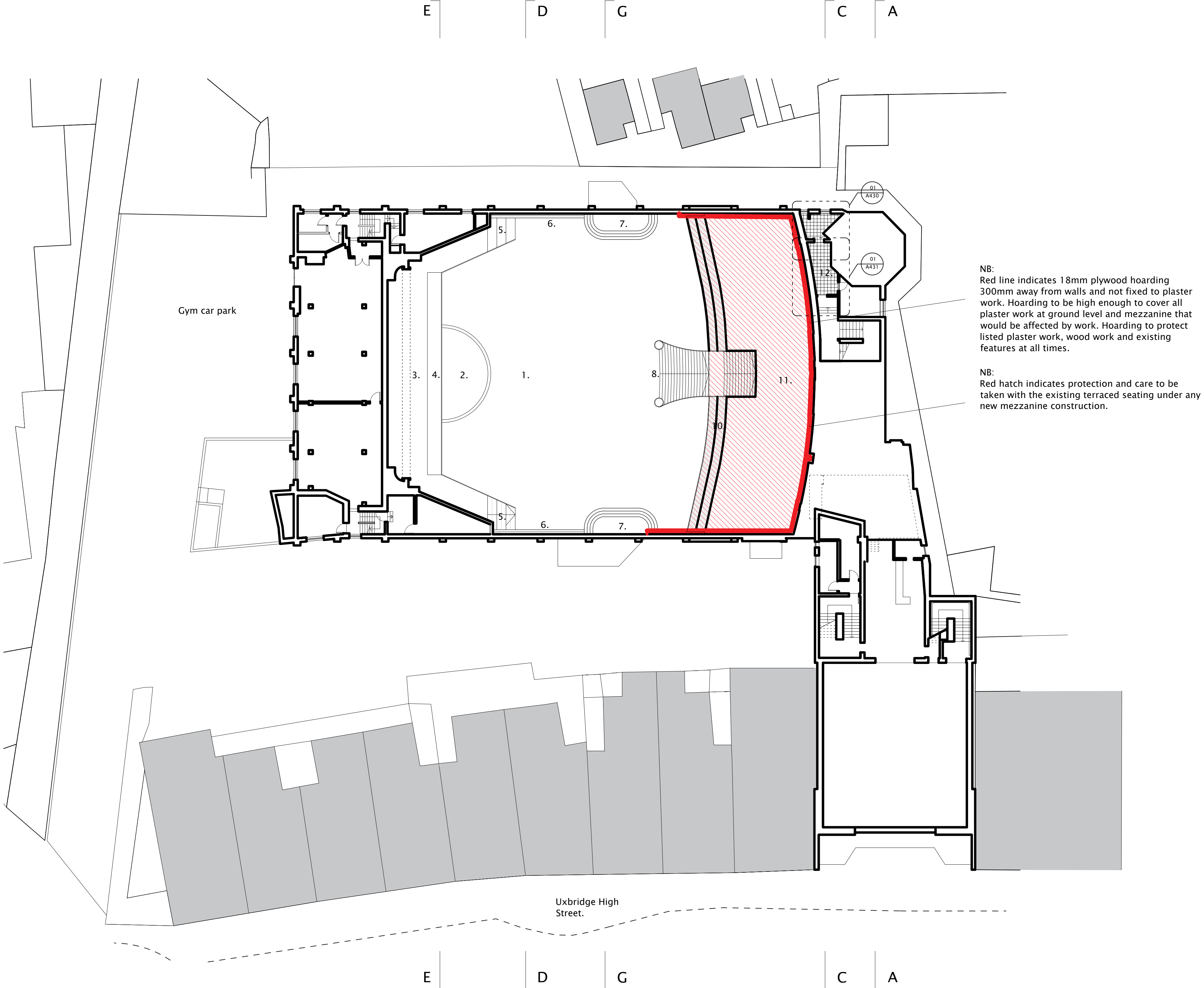

B

F

NB:
Red line indicates 18mm plywood hoarding 300mm away from walls and not fixed to plaster work. Hoarding to be high enough to cover all plaster work at ground level and mezzanine that would be affected by work. Hoarding to protect listed plaster work, wood work and existing features at all times.

NB:
Red hatch indicates protection and care to be taken with the existing terraced seating under any new mezzanine construction.

Notes:

All dimensions to be confirmed by contractor on site.

Scale 1:200

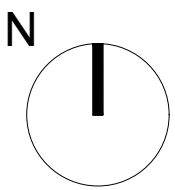
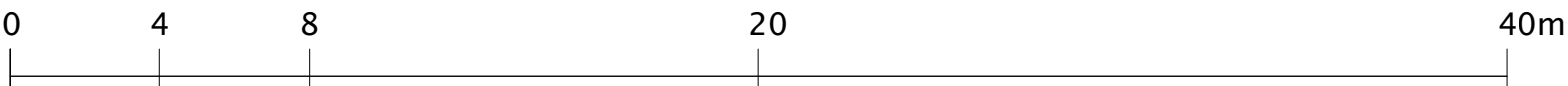

01	250501	Conditions info	cad	nw
Rev	Date	Description	By	Ck

Project
233 High Street,
Uxbridge,
London,
UB8 1LD

Title
Proposed 1st Floor Plan

Project description
Cinema Conversion

Stage
Listed building
application

Scale
1:200@A1

Drawing No
A202

Job No

0242

Rev

01