

Revision
A

Drawn By
-

Checked By
MM

0

Scale Bar 1:100

5

7 m

First Design Solution Ltd.

1 Ockendon Road, Corbets Tey
Upminster, RM14 2DN

T: 01708 60 69 60
W: www.firstdesignsolution.co.uk
E: admin@firstdesignsolution.co.uk

FDS

FIRST
DESIGN
SOLUTION

Project -

Drawing Title -

Scale -

Status-

Date Issued

1 Hale End Close, Ruislip, HA4 8EQ

Site Location Plan & Block Plan

1:1250 & 1:200 @ A3

For Comments /Approval ☐ Planning Issue ☒ Revision ☐

December 2022

Drawing No

2022.98-00



Site Location Plan
Scale 1:1250 @ A3

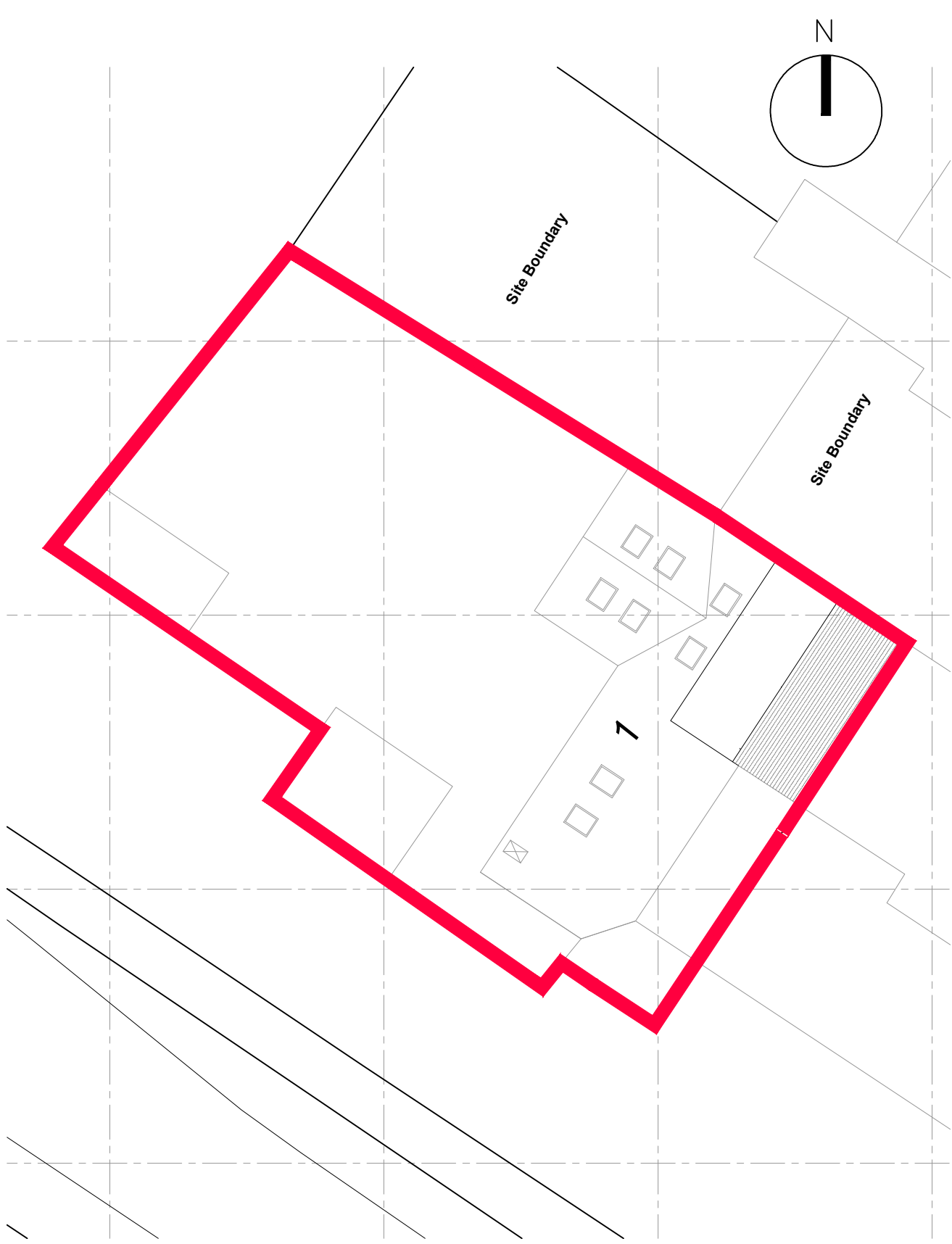
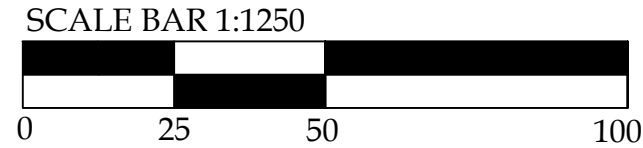

Proposed Block Plan
Scale 1:200 @ A3

GENERAL NOTES :

- ALL DIMENSIONS TO BE CROSS CHECKED ON SITE PRIOR TO WORKS. ANY DISCREPANCIES ON THIS DRAWING TO BE REPORTED BACK.
- PLEASE DO NOT SCALE - USE ONLY DIMENSIONS STATED ON THE DRAWING.
- THE CONTRACTOR IS TO CHECK AND VERIFY ALL DIMENSIONS AND LEVELS STATED ON THE DRAWING, AND CROSS REFERENCE SAME WITH SITE CHECKS. FDS ARE TO BE INFORMED OF ANY CONTRADICTIONS AND DISCREPANCIES.
- THE CONTRACTOR IS TO CHECK THE DRAWING AGAINST ALL OTHER RELEVANT DRAWINGS, SPECIFICATIONS AS ISSUED AND APPROPRIATE. FDS ARE TO BE INFORMED OF ANY CONTRADICTIONS AND DISCREPANCIES. IF IN DOUBT ASK!
- ALL DIMENSIONS SHOWN ON OUR DRAWINGS ARE APPROXIMATE AND ARE SUBJECT TO SITE TOLERANCES.
- DIMENSIONS ON OUR DRAWINGS ARE NOT TO BE USED FOR THE FABRICATION OF STRUCTURAL STEELWORK.

COPYRIGHT:
Written consent must be obtained from First Design Solution for reproducing or copying this drawing in part or in whole.