

1

Revision A - Proposed Elevation B

1:100 @ A3

Discharge of Condition 4 – Obscure glazing (min Level 3) and non-opening below 1.7m FFL

This drawing is submitted to discharge Condition 4 Of planning permission:
Appeal Ref: 600270
Site: 48 Raleigh Avenue

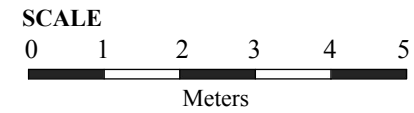

GENERAL NOTES

COPYRIGHT
This drawing has been produced by Shammie Kohli, and is not to be used or reproduced by any other party for any purpose.

Recommended Site Survey to be conducted before any building works initiated.

This drawing must be read in conjunction with all other relevant documentation and drawings.

This document is a 'Layout Drawing' which focuses on the overall structure focusing on the arrangement and placement of elements with a space, providing a general overview of design, used as a base for construction purposes, NOT for building regulations and for building contractor for construction.

Do not scale from this drawing, check all dimensions to be checked on site before fabrication

Contractor is obligated to check measurements prior to construction and report all errors and omissions to the architect, designers and structural engineers. Also contractor is responsible for the engagement of a building control officer as permitted by lawful development.

All drawings are subject to any variation required or recommended by any statutory authority, or for the better carrying out of the work

LEGEND

ELEVATION B

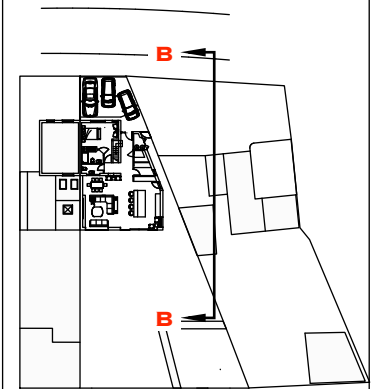

1

Revision A - Proposed Elevation D

1:100 @ A3

Discharge of Condition 4 – Obscure glazing (min Level 3) and non-opening below 1.7m FFL



ELEVATION D

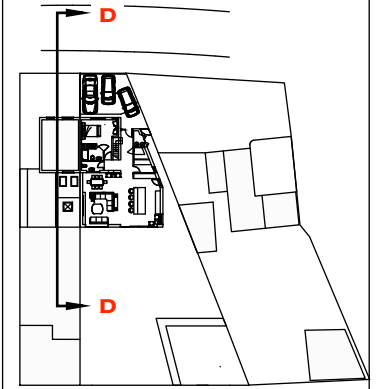

SK

PROJECT TITLE:
PROJECT 48 RA

CLIENT:
MR. VP KHANNA

Drawing Title:
Proposed Elevation B & D - Obscure Glazing & Opening Restrictions - Condition 4

ISSUE DATE: 17.03.26	RE-ISSUE DATE	REVISIONS: A	DRAWN BY: SK
ISSUED FOR: HOUSEHOLD PLANNING APPLICATION - CONDITIONS DISCHARGE SUBMISSION		DRAWING NO.: 03.2025.050	ADDRESS: 48 RALEIGH AVENUE, HAYES, UB4 OEE