

TOPOGRAPHICAL & MEASURED BUILDING SURVEYS

ABBREVIATIONS & SYMBOLS

AH	Arch Head Height	FH	Fire Hydrant	RSJ	Rolled Steel Joist
AR	Assumed Route	FBD	Floor Board Direction	SI	Sign Post
AV	Air Valve	FH	Fire Hydrant	SP	Arch Spring Point Height
BB	Bellisha Beacon	FL	Floor Level	SV	Stop Valve
BH	Bore Hole	FP	Flag Pole	SW	Surface Water
BL	Bed Level	FW	Foul Water	SY	Stay
BO	Bollard	GG	Gully Grate	Tac	Tactile Paving
BP	Brace Post	GV	Gas Valve	TC	Telecom Cover
BS	Bus Stop	HH	Head Height	TH	Trial Pit
BU	Bush	IC	Inspection Cover	THL	Threshold Level
B/W	Barbed Wire Fence	IL	Invert Level	TL	Traffic Light
BX	Box (Utilities)	I/R	Iron Railings	ToW	Top of Wall
C/B	Close Board Fence	KO	Kerb Outlet	TP	Telegraph Pole
CH	Cill Height	LP	Lamp Post	TV	Cable TV Cover
CL	Cover Level	MH	Manhole	UB	Universal Beam
CL	Chain Link Fence	MP	Marker Post	UC	Unknown Cover
C-Lev	Ceiling Level	NB	Name Board	UK	Unknown Tree
Col	Column	OHL	Overhead Line (approx)	USB	Under Side Beam
C/P	Chestnut Paling Fence	Pan	Panel Fence	UTL	Unable To Lift
CR	Cable Riser	PB	Post Box	VP	Vent Pipe
DC	Drainage Channel	PM	Parking Meter	WB	Waste Bin
DH	Door Head Height	PO	Post	WH	Weep Hole
DP	Down Pipe	P/R	Post & Rail Fence	WL	Water Level
DR	Drain	P/W	Post & Wire Fence	WM	Water Meter
EL	Eaves Level	P/Wall	Partition Wall	WO	Wash Out
EP	Electric Pole	RE	Rodding Eye	⊗	Floor to Ceiling Height
ER	Earth Rod	RL	Ridge Level	⊗/x	F/C Floor to False Ceiling HT
ET	EP-Transformer	RP	Reflector Post	⊗	Survey Control Station
FB	Flower Bed	RS	Road Sign		
FBD	Floor Board Direction	RSD	Roller Shutter Door		

DRAWING NOTE

Topographical Surveys

Trees are drawn to scale showing the average canopy spread. Descriptions and heights should be used as a guide only.

All below ground details including drainage, voids and services have been identified from above ground and therefore all details relating to these features including; sizes, depth, description etc will be approximate only. All critical dimensions and connections should be checked and verified prior to starting work.

Detail, services and features may not have been surveyed if obstructed or not reasonably visible at the time of the survey.

Measured Building Surveys

Measurements to internal walls are taken to the wall finishes at approx 1m above the floor level and the wall assumed to be vertical.

Cill heights are measured as floor to the cill and head heights are measured from cill to the top of window.

General

The contractor must check and verify all site and building dimensions, levels, utilities and drainage details and connections prior to commencing work. Any errors or discrepancies must be notified to Survey Solutions immediately.

The accuracy of the digital data is the same as the plotting scale implies. All dimensions are in metres unless otherwise stated.

The survey control listed is only to be used for topographical surveys at the stated scale. All control must be checked and verified prior to use.

© Land Survey Solutions Limited holds the copyright to all the information contained within this document and their written consent must be obtained before copying or using the data other than for the purpose it was originally supplied.

Do not scale from this drawing.

REV	DESCRIPTION	DRAWN	APPR	DATE



Ipswich Coventry Yeovil Norwich Perth Nottingham Brentwood

Tel No: 0845 0405 969 Fax No: 0845 0405 970
www.survey-solutions.co.uk enquiries@survey-solutions.co.uk

LAND SURVEYING BUILDING SURVEYING UNDERGROUND SURVEYING

PROJECT TITLE
TAVISTOCK WORKS, WEST DRAYTON,
UB7 7QX.

DRAWING DETAIL
TOPOGRAPHICAL SURVEY
Sheet 1 of 1

CLIENT LINEA HOMES	SCALE 1:200
SURVEYOR SB	SURVEY DATE 2/11/2018
CHECKED BY MB	APPROVED BY JM
DRAWING NUMBER 23121se-01	REVISION ISSUE DATE 14/11/2018

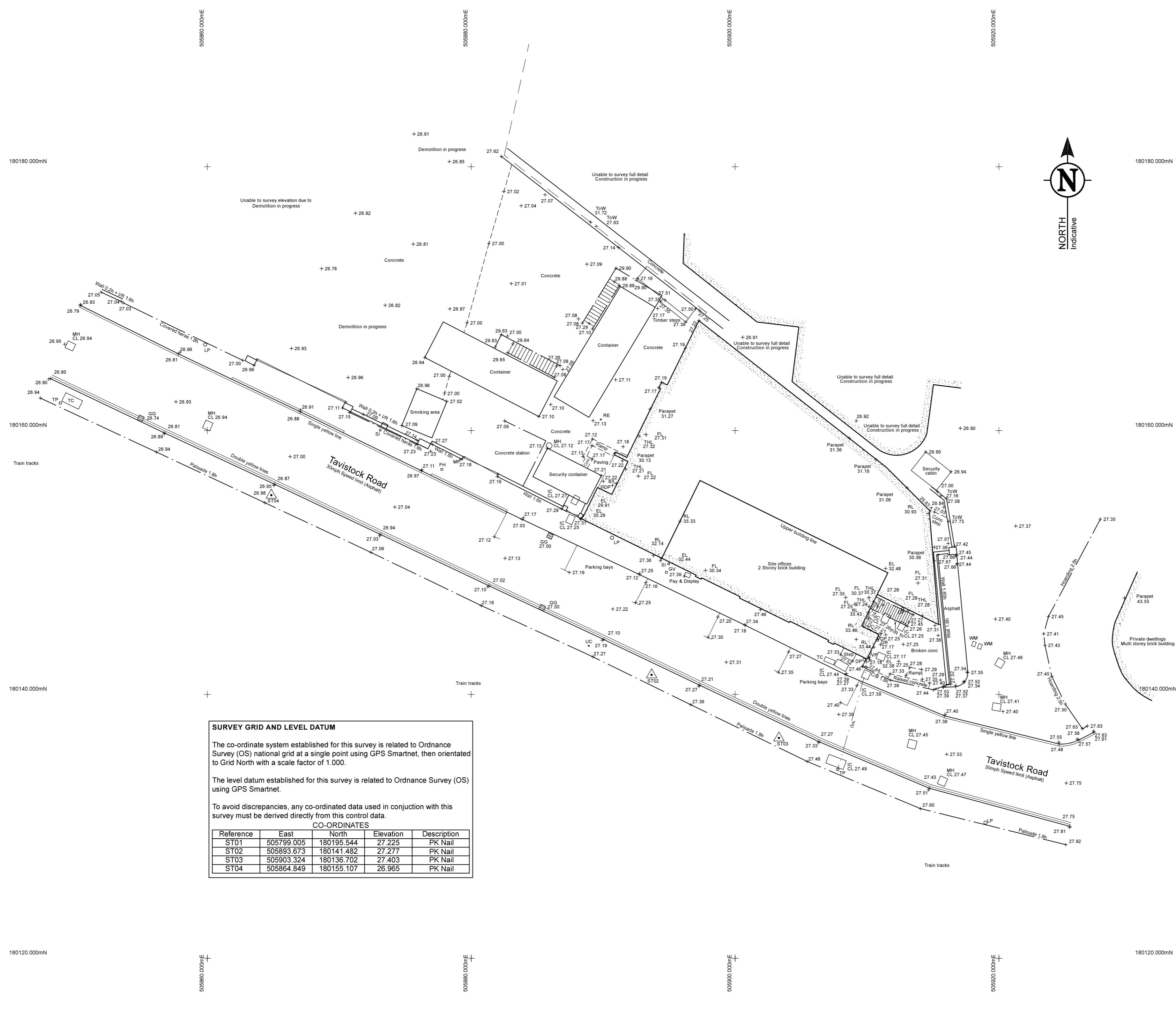

SURVEY GRID AND LEVEL DATUM

The co-ordinate system established for this survey is related to Ordnance Survey (OS) national grid at a single point using GPS Smartnet, then orientated to Grid North with a scale factor of 1.000.

The level datum established for this survey is related to Ordnance Survey (OS) using GPS Smartnet.

To avoid discrepancies, any co-ordinated data used in conjunction with this survey must be derived directly from this control data.

CO-ORDINATES

Reference	East	North	Elevation	Description
ST01	505799.005	180195.544	27.225	PK Nail
ST02	505893.673	180141.482	27.277	PK Nail
ST03	505903.324	180136.702	27.403	PK Nail
ST04	505864.849	180155.107	26.965	PK Nail