

EXISTING MATERIALS
ROOF: BROWN PLAIN TILES
WALLS: RED FACING BRICK

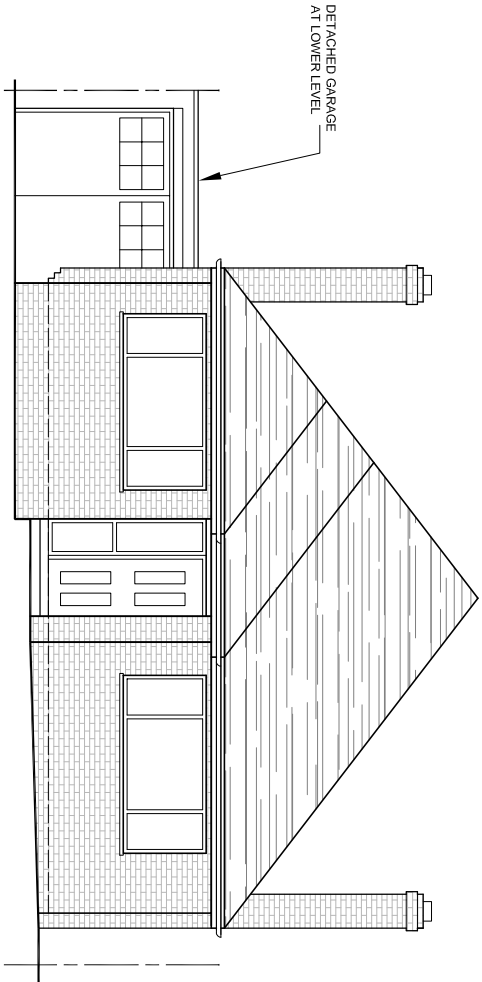

NORTH ELEVATION

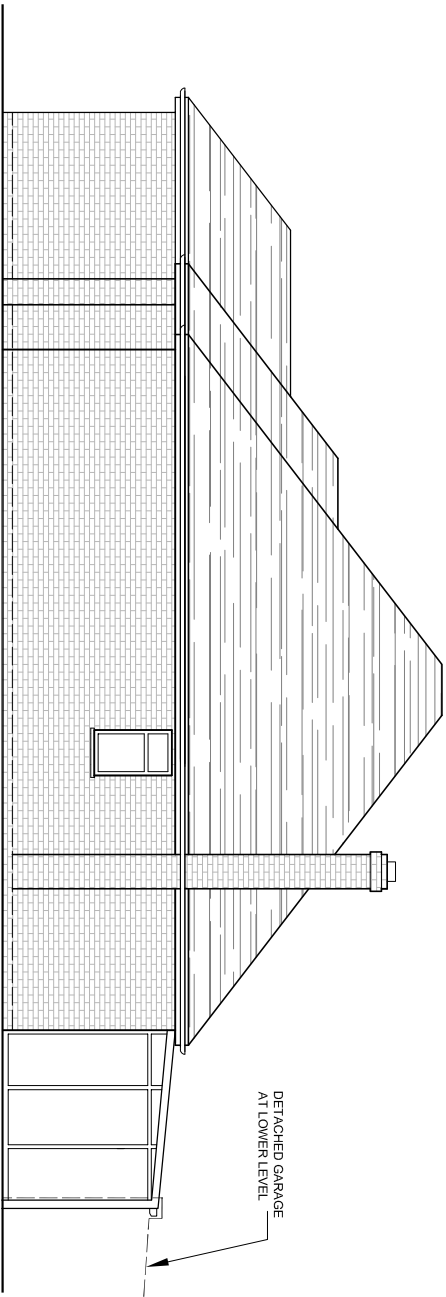

WEST ELEVATION

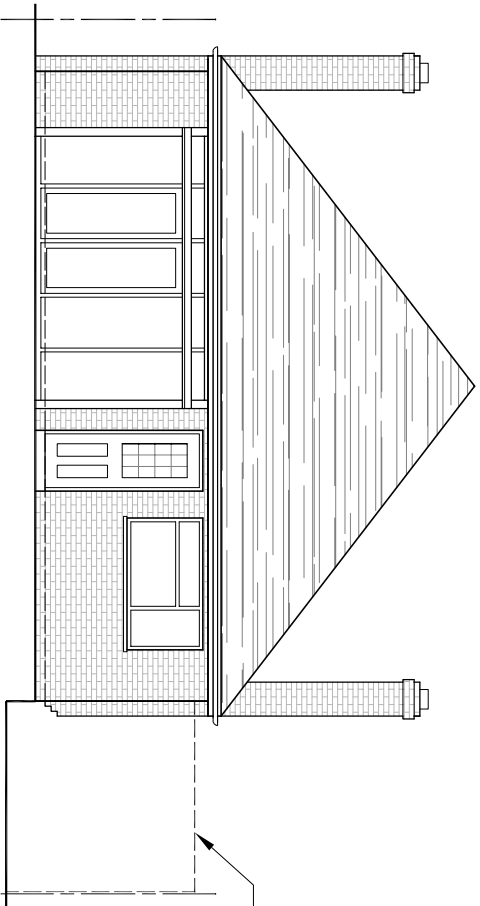

SOUTH ELEVATION

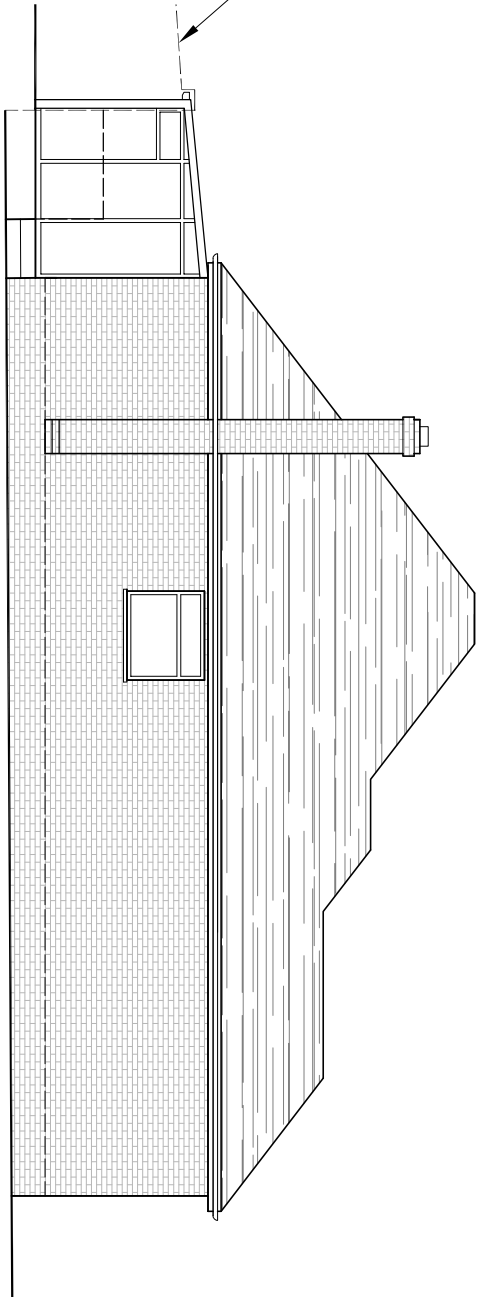

EAST ELEVATION



AMENDMENTS

DATE

REV.

All dimensions are to be finished unless stated otherwise. Dimensions are to be taken from the centre of the wall unless otherwise stated. Dimensions are to be taken from the centre of the wall unless otherwise stated. Dimensions are to be taken from the centre of the wall unless otherwise stated. Dimensions are to be taken from the centre of the wall unless otherwise stated.



bernard murray design
chartered architect

WWW.BMURRAYDESIGN.CO.UK
78 BRIDGE ROAD, UXBRIDGE, MIDDLESEX UB8 3QW
TEL: 07958 477174 EMAIL: BMURRAYDESIGN@YAHOO.CO.UK

PROJECT
10 WOODSTOCK DRIVE
ICKENHAM
UB10 8EE

CLIENT
JERRY FAHY

DRAWING
EXISTING ELEVATIONS

SCALE	1:100 @ A3	DRAWING NUMBER	REV.
DATE	DEC 2022	1182-4	
DRAWN	BM		