

NOTES

1. All dimensions are to be checked on site prior to the commencement of work and any discrepancy is to be reported to the construction manager before construction.
2. All work is to comply with current Building Regulations and all legislation.
3. All contractors and sub-contractors must ensure that they have the latest issue of this specification and details before the commencement of work on site.
4. All materials are to be used and installed in strict compliance with the relevant manufacturers instructions and recommendations.
5. All works on site, managed and implemented as a result of the designs included on this drawing, are to be given full compliance for compliance with the Health and Safety (CDM) Regulations in respect of design and implementation on site and where works are to be undertaken it is considered that compliance with the Building Regulations cannot be achieved.
6. All dimensions shown in millimetres.

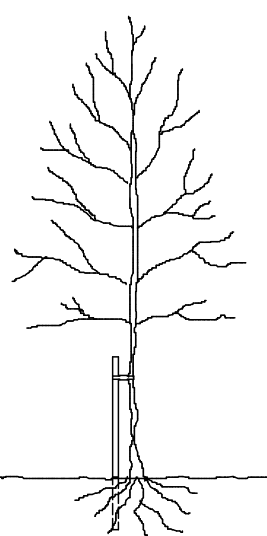

TREE STAKING DETAIL

TREE STAKING SPECIFICATION

For selected standard trees o/a height 3.0-3.5m. Support using stakes extending to 1.0-1.2m above ground and 0.6-0.75m below ground level (depending on ground conditions).

Supported by single non reinforced tie 75mm from top of stake.

Remove stake on onset of or during the second growing season after planting.

LANDSCAPE SPECIFICATION

Landscaping generally to be carried out in accordance with BS.4428. All new trees to be supplied as selected standards unless otherwise noted.

Overall height 3.0-3.5m and 1.8-2.1m, straight stem to BS.3936 Part 1 1992. Trees supplied with bare roots with polythene wrapping or as noted otherwise, and planted in a min of 3.0 litres peat. Planting beds to be excavated and lined with screened topsoil enriched with peat free compost/fertiliser or similar manure 50mm deep, top dressed with 75mm deep forest bark mulch.

Site to be cleared of all builders rubble and rotavated levelled and tilled before planting commences. Front gardens to be turfed and rear gardens seeded.

All turfing to BS.3936 1990.

Pernicious weeds are to be treated with translocated herbicide during growing season (spot treated).

Tree and shrub planting to BS.3936 Part 1 1992.

Sub-soil areas below planting to be de-compacted before planting commences.

Tree protection to be carried out in accordance with B.S.5837 2012.

DRIVEWAY SPECIFICATION

Driveway to be finished with permeable concrete pavers,
finished with a permeable 6mm joint filled with clean crushed stone.

Below the above you need a laying course of a 50mm depth of 6mm clean crushed stone, followed with a sub-base of a 200mm depth of 20mm clean crushed stone with well defined edges.
(depth depending on soil conditions)



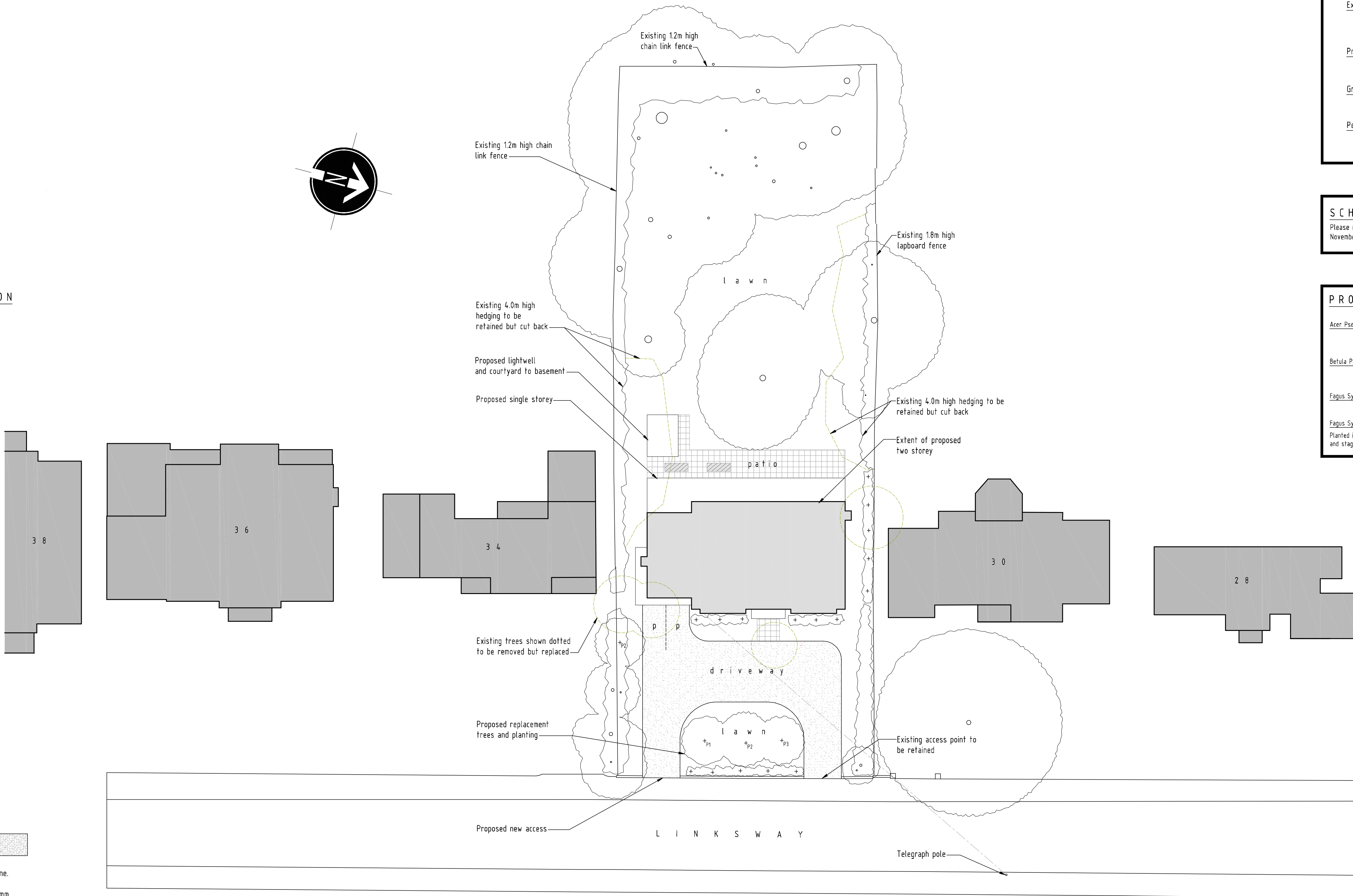

Pavers to be finished with compatible edgings

Crossover to be finished in permeable black tarmac. Construction specification in accordance with local authorities requirements.



SITE LAYOUT PLAN - SCALE 1:250

LEGEND

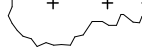
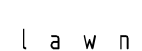
- | | |
|--|---|
| <u>Extent of proposed building</u> |  |
| <u>Existing trees & planting to be removed</u> |  |
| <u>Existing trees & planting to remain</u> |  |
| <u>Proposed new trees & shrubs</u> |  |
| <u>Grassed areas</u> |  |
| <u>Permeable concrete pavers</u> |  |

SCHEDULE OF IMPLEMENTATION

Please note ALL new planting is to be implemented between the months of November to March in the first planting season following the completion of works

PROPOSED PLANTING LEGEND

- Acer Pseudoplatanus - Sycamore
- Betula Pendula - Silver Birch
- Fagus Sylvatica 'Purpurea' - Copper Beech
- Fagus Sylvatica - Common Beech Hedging
- Planted in double rows at 600mm c/c and staggered, height 500-750mm

rev:	date:	description:	
scale:	1 : 250	A1	date: 21 / 01 / 2022
drawing no:	1278 / P / 6		drawn: FJ

drawing: PLANNING PROPOSALS
LANDSCAPING LAYOUT

project: LAND AT 32 LINKSWAY,
NORTHWOOD, MIDDLESEX, HA6 2XB

client: MR K PANKHANIA



DUSEK DESIGN ASSOCIATES LTD
ARCHITECTURE + PLANNING

01895 831 103
info@dusek.co.uk
www.dusek.co.uk

print history: Monday, 24 January, 2022 11:07:02

S:\HOUSE\WORK\1251-1300\1278 32 LINKSWAY\PL1278-P-LIN

SCALE BAR (m)

