



FLAT ROOF LIGHT
VELUX or similar
slim line aluminium
roof light

To be double glazed + to meet 'U' value of
min. 2.0W/m sq.K. All roof lights to be A-A
fire rated.

Fully thermally broken construction.

Double up rafters on the side of opening,
supporting double trimmers above & below
opening.
Bolt together with M12 bolts at 450 c/s.

Fixed in accordance with the
manufacturers instructions.

PATIO ENCLOSURE
NEW EXTERNAL STAIRS & BALUSTRADING

External staircase.
Max. rise - 200mm
Min. going - 230mm
Max. pitch to be 42 deg.
Handrail fixed at 1000mm above patio.
Glass guarding to be of laminated glass,
minimum 30 min. fire resistance.

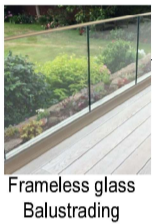

Frameless glass
Balustrading

ALL TO MEET APPROVED DOC. K1.



Conifer Leaf Screening Hedging
to be **1.8m** high from patio level

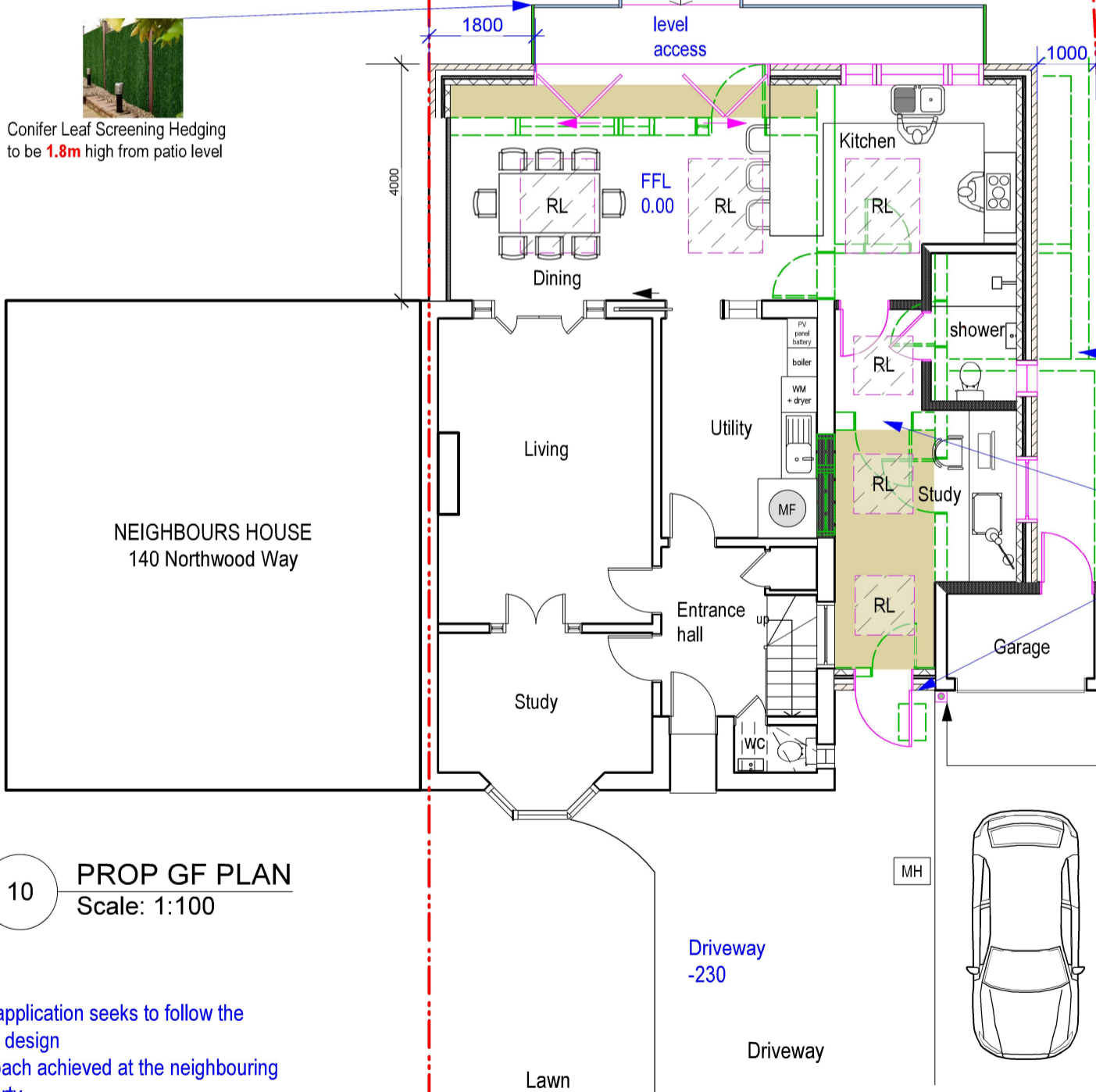

- New internal walls
- New external walls
- Walls to be demolished
- New doors/windows
- Proposed work shaded
- Rooflight

NEIGHBOURS RASIED
GF EXTENSION

NEIGHBOURS HOUSE
136 Northwood Way

NEIGHBOURS HOUSE
140 Northwood Way

New side
access created.
Existing
structure
reduced in width

original second
front access
door moved
forward

EV charging port
installed and specified by a specialist
min. 7kW of power
All to be in line with
Building regulations part S.



MH

MH

Driveway
-230

Driveway

Lawn

10 **PROP GF PLAN**
Scale: 1:100

This application seeks to follow the
same design
approach achieved at the neighbouring
property
[136 Northwood Way - REF
1402/APP/2015/3061](#)
Side to rear wrap around extension
taken from raised patio level



tel : 0796 222 3141
email : sandeep@sskarchitects.co.uk

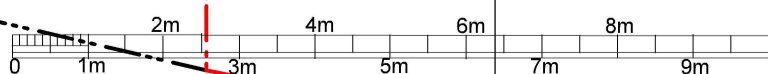

scale - 1 : 100 @ A3

Rev A - 01/05/2026
Screening note amended to 1.8m

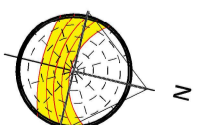

Purpose - Householder planning application

All dimensions to be checked on site. All omissions & discrepancies to be reported to the designer. © SSK architects owns the copyright of this drawing which must not be reproduced in whole or part without the written permission.	PROJECT: 138 Northwood Way, HA6 1RE	DATE: 25/10/2025
	DWG NO: PROP GF	REVISION: 10

PROPOSED