

Scale 1:500

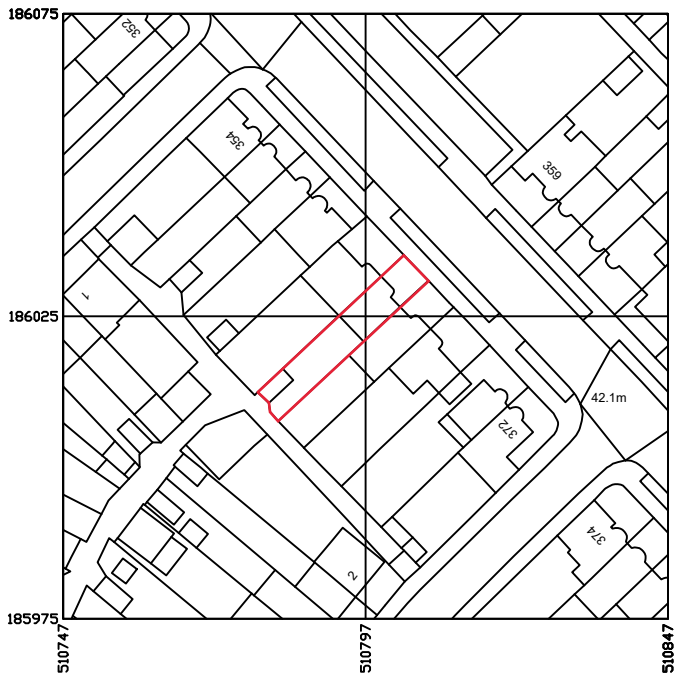

Produced on 02 September 2024 from the Ordnance Survey National Geographic Database and incorporating surveyed revision available at this date. This map shows the area bounded by 510747 185975, 510847 185975, 510847 186075, 510747 186075, 510747 185975. Crown copyright and database rights 2024 OS 100054135. Supplied by copla ltd trading as UKPlanningMaps.com a licensed Ordnance Survey partner (OS). Data licence expires 02 September 2025. Unique plan reference: v1f//1144224/1539117

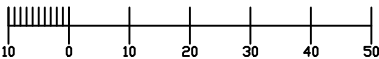

1

Site Location Plan

SCALE: 1:1250

2

Proposed Block Plan

SCALE: 1:500

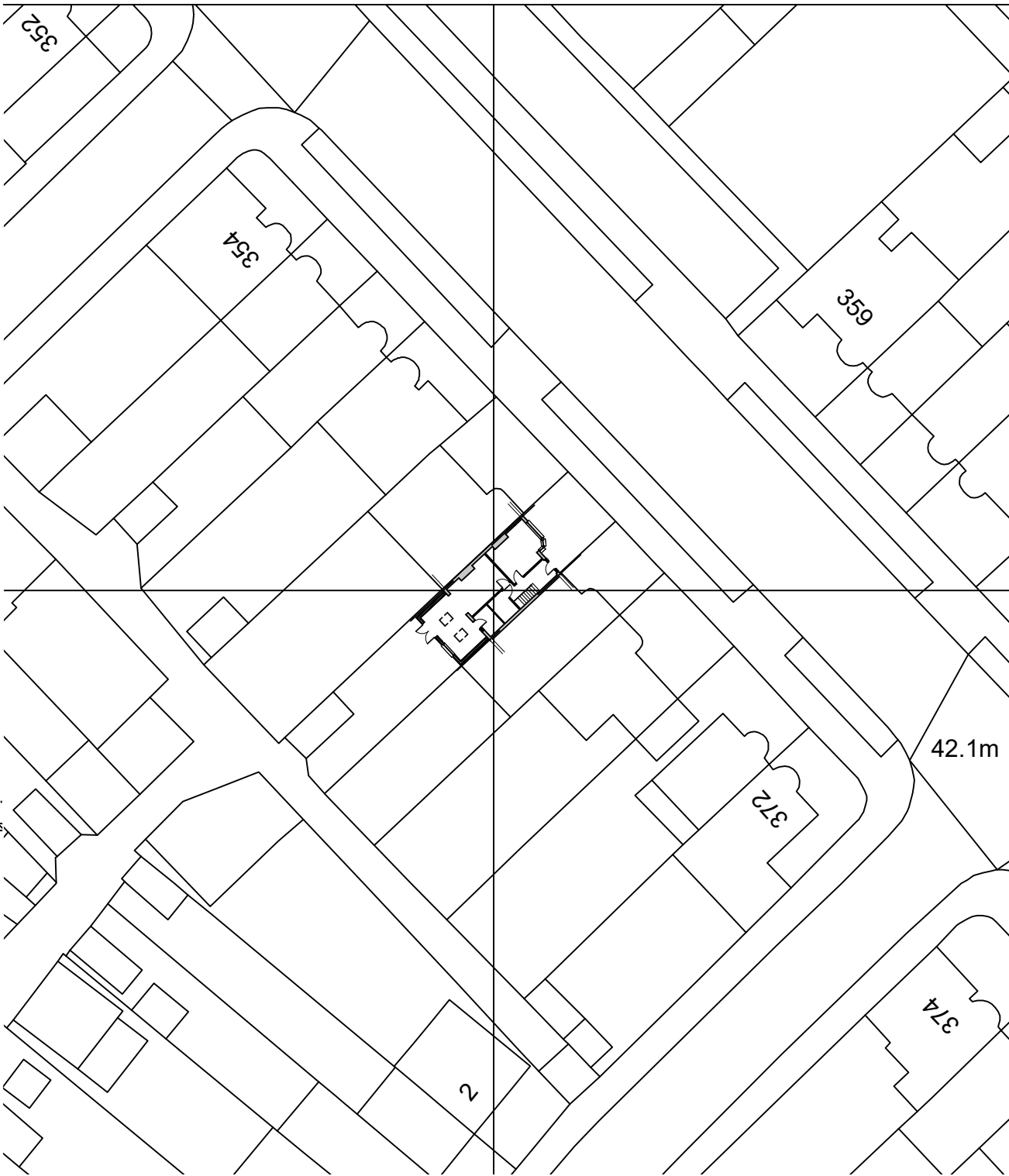

Notes:

1. THIS DRAWING IS COPYRIGHTED AND IT MAY NOT BE REPRODUCED IN WHOLE OR PART OR USED FOR THE MANUFACTURE OF ANY ARTICLE WITHOUT THE EXPRESS PERMISSION OF THE COPYRIGHT HOLDERS.
2. WORK TO FIGURED DIMENSIONS ONLY.
3. THIS DRAWING IS TO BE READ IN CONJUNCTION WITH ALL RELEVANT ARCHITECT'S AND ENGINEER'S DRAWINGS AND SPECIFICATIONS.
4. ALL PROPOSED MATERIALS ARE TO MATCH THE EXISTING. BRICKWORK TO MATCH AS CLOSELY TO THE EXISTING, ROOF TILES TO MATCH EXISTING, GLAZING TO MATCH EXISTING.
5. GLAZING SHOWN ON THE BOUNDARY IS TO CONTAIN OBSCURED GLASS

REV:	DESCRIPTION:	BY:	DATE:
------	--------------	-----	-------

STATUS:	Planning
---------	----------



CLIENT:	Mrs Rajal Shah 364 Victoria Road Ruislip HA4 0ET
---------	---

ARCHITECT:	SM London Construction Ltd 198 Field End Road, Ruislip, HA5 1RF T: 07961817505 E: info@smconstructionltd.com
------------	---

SITE:	364 Victoria Road Ruislip
-------	------------------------------

TITLE:	SLP & Proposed Block Plan
--------	---------------------------

SCALE AT A3:	DATE:	DRAWN:	CHECKED:
1:100	Aug 2024	HD	HD

PROJECT NO:	DRAWING NO:	REVISION:
364VR	364VR/001/PL	A