

All Facing Materials to Match the Existing Finishes

PARTY WALL ACT 1996
OWNER/S MUST ENSURE ALL
PARTY WALL AGREEMENTS ARE
IN PLACE BEFORE ANY BUILDING
WORKS ARE TO COMMENCE

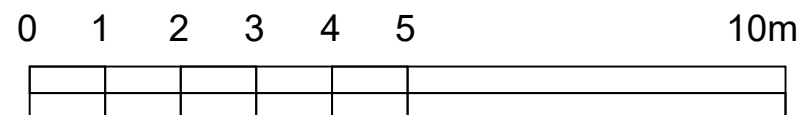
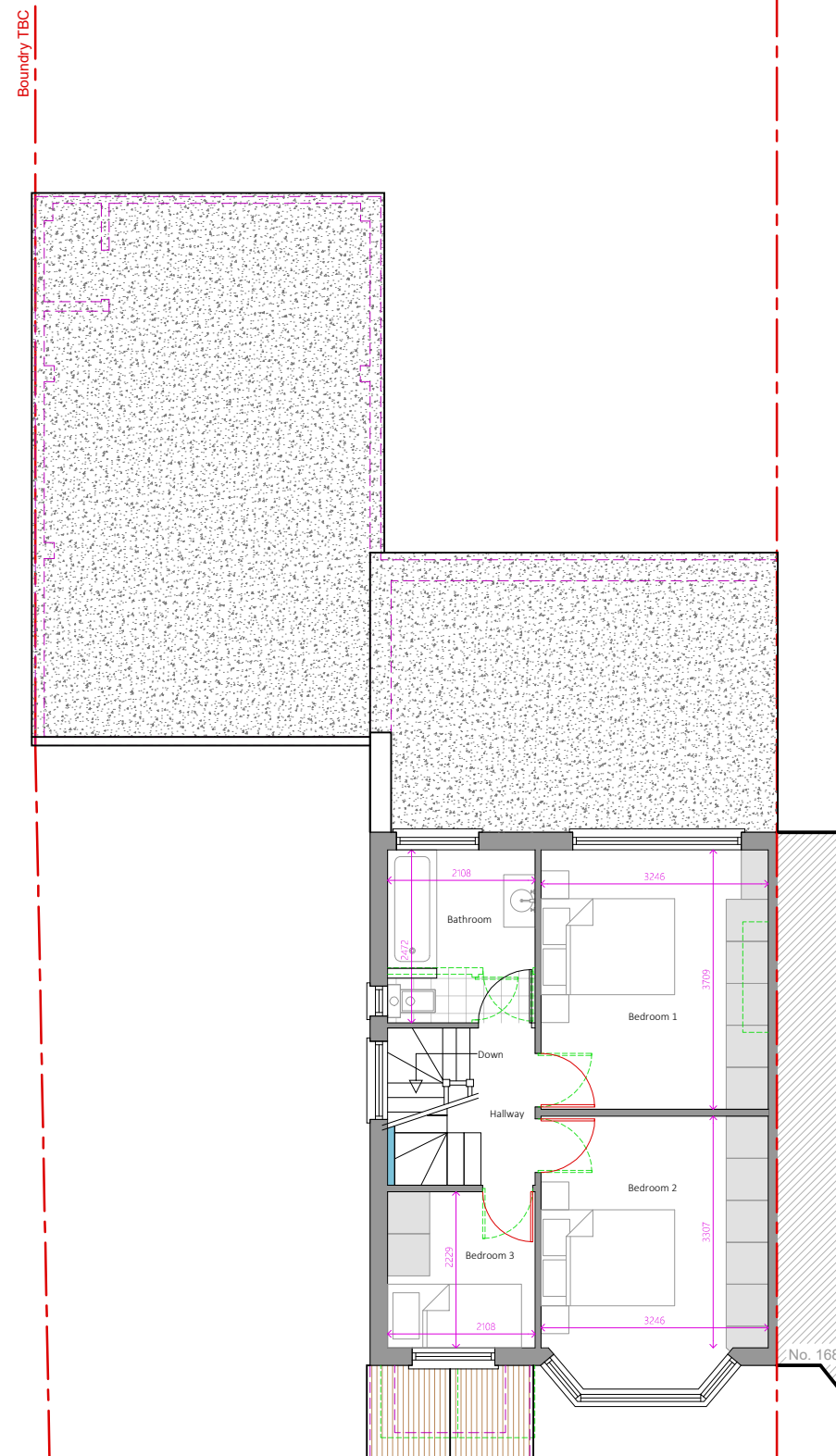

IMPORTANT GENERAL NOTE
The specification is to be read in conjunction with the plans/section details, and other associated Structural details as may be provided.
All work is to be carried out to the Local Authority Planning and Building Regulations and the Codes of Practice and Regulations as necessary.
All dimensions, levels, sizes, positions and locations of particulars as indicated on drawings are to be verified by the appointed Contractor on site prior to engaging in works. Any discrepancies must be reported to the Architect/Surveyor/Engineer or responsible person's immediately.
The Contractor is responsible for ensuring compliance with the CDM Regulations, and appropriate Health & Safety on site precautions.
The Client/Building owner is responsible for obtaining any necessary PARTY WALL AGREEMENTS, prior to engaging in the works on site.

Revision	Date	Description

Page Size	Drawn By	Checked By
A3	RA	AP
Scale	Drawing Status	
1:100	Planning Issue	
Revision	Date	
1st	Mar-24	

 DontMoveExtend.com [®] <i>Planning Permission Specialists</i>	
Project 170 Ryefield Avenue Uxbridge UB10 9DD	Title Proposed Plans
	Drawing No. RA170-01-1004

DontMoveExtend.com and the Red Box are Registered Trade Marks Of Construct 360 Ltd

COPYRIGHT © 2024