

RETROSPECTIVE PLANNING APPLICATION
FOR THE EXISTING OUTBUILDING TO BE
USED AS AN ANCILLARY HOME GYM AND
STORAGE

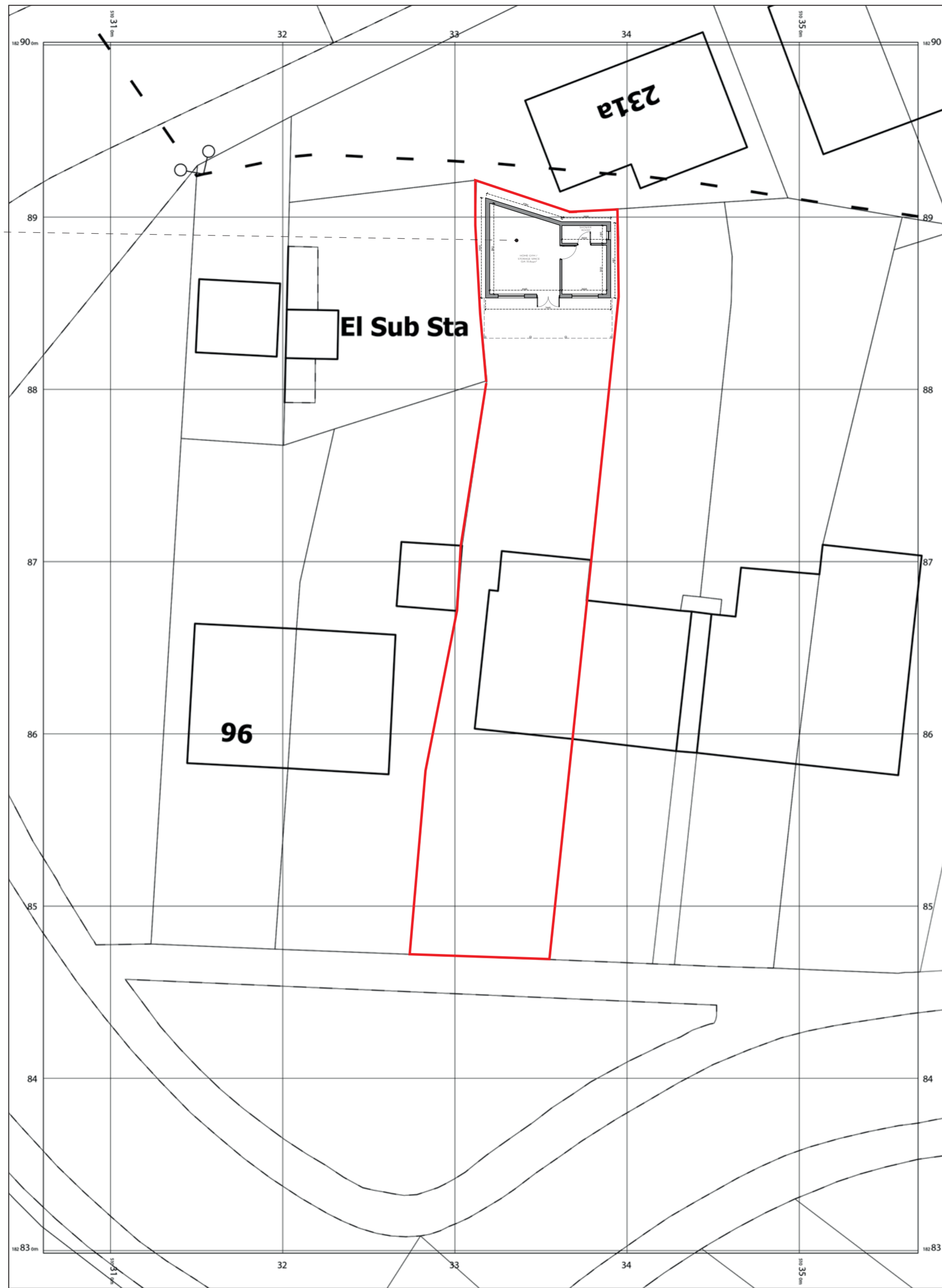

NOTES:

1. DO NOT SCALE FROM THIS DRAWING, ANY DIMENSIONS SHOWN ARE INDICATIVE ONLY AND ARE SUBJECT TO VERIFICATION ON SITE. THE CONTRACTOR IS TO SET OUT, CHECK AND COORDINATE ALL DIMENSIONS ON SITE DURING THE COURSE OF THE WORKS. THIS DRAWING IS TO BE READ IN CONJUNCTION WITH ALL OTHER ARCHITECTURAL PLANS, STRUCTURAL CALCULATIONS AND SPECIFICATIONS.
2. PRIOR TO COMMENCEMENT OF ANY WORK ON SITE, LOCAL AUTHORITIES APPROVAL MUST BE ACHIEVED.
3. ALL TEMPORARY WORK TO BE CLIENT / CONTRACTORS RESPONSIBILITY.
4. ALL WORKS TO BE CARRIED OUT IN ACCORDANCE WITH THE LATEST APPROPRIATE CODES OF PRACTICE.
5. VERIFY THE LOCATION AND THE DETAILS OF ALL THE SERVICES PRIOR TO ANY EXCAVATION WORK.
6. WHERE WORKS AFFECT A PARTY WALL OR INVOLVE EXCAVATIONS WITH IN 3m OF ADJOINING BUILDINGS, PARTY WALL AGREEMENT SHALL BE IN PLACE PRIOR TO COMMENCEMENT OF ANY WORKS.
7. TILL TECHNICAL APPROVAL HAS BEEN OBTAINED FROM THE RELEVANT TECHNICAL AUTHORITIES OR STATUTORY BODIES, IT SHOULD BE UNDERSTOOD THAT ALL DRAWINGS ARE ISSUED AS PRELIMINARY AND NOT FOR CONSTRUCTION.

PROPOSED SITE BLOCK PLAN
SCALE 1:200

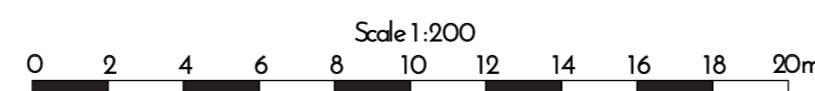

SITE BOUNDARY :

STAGE:	PLANNING		
CLIENT:	SONU THIND 92 ATTLEE ROAD, HAYES, UB4 9JS		
PROJECT:	RETROSPECTIVE PLANNING APPLICATION FOR THE EXISTING OUTBUILDING TO BE USED AS AN ANCILLARY HOME GYM AND STORAGE		
FILE:	EXISTING BLOCK PLAN		
DRAWN:	VP	REVISION:	B
DRAWING NO.	92AR/UB49JS/102		
SCALE:	1:200/A2	DATE:	22/04/2026
SHEET:	102		