

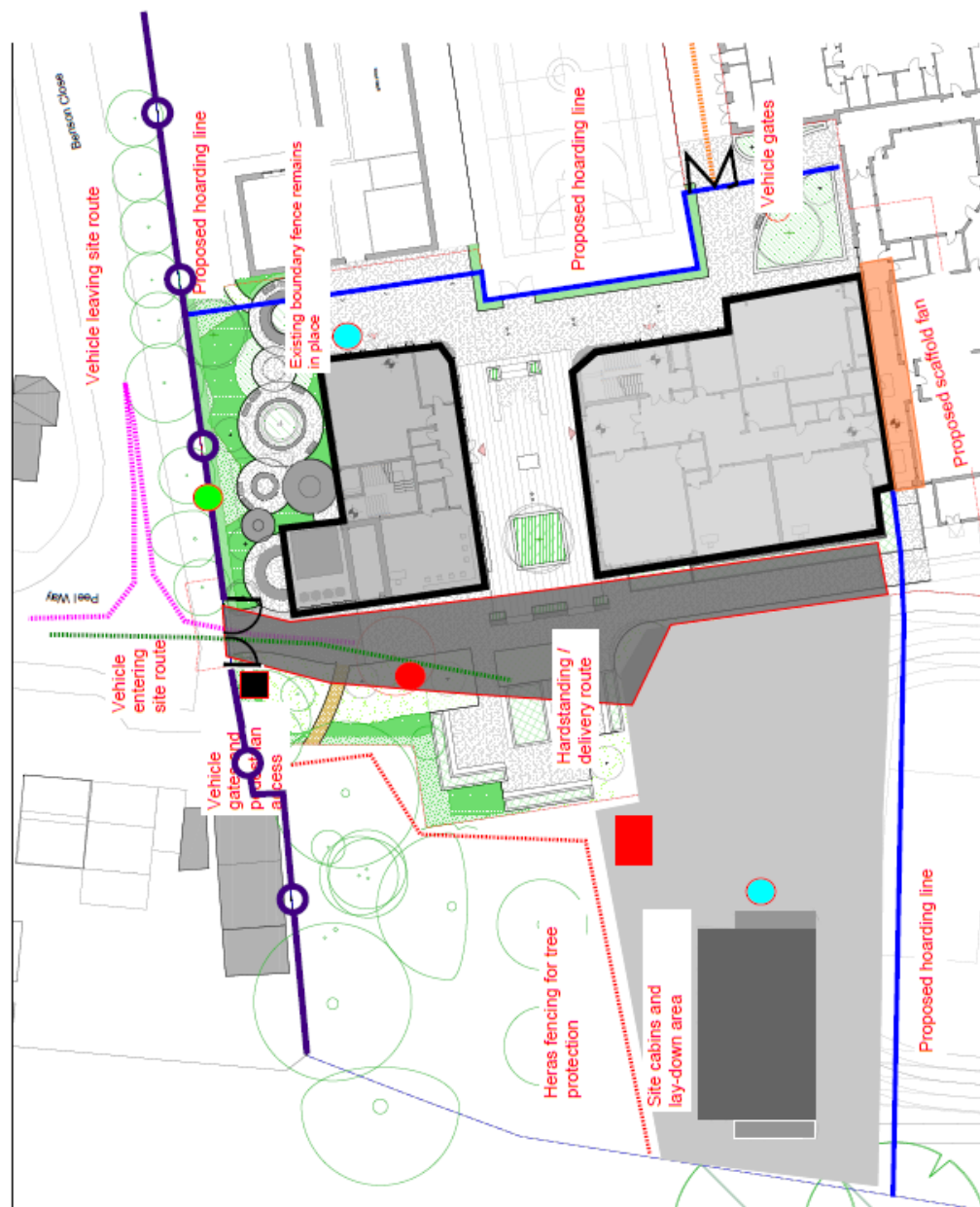

# ISG – Meadow High School – Demolition and Construction Logistics Plan



Meadow High School  
Royal Lane  
Uxbridge

Detailed Logistics Drawing - Peel Way  
101 - V1 - June 23

- Existing boundary fence remains
- New enlarged vehicle gates
- Site hoarding - solid panels
- Site hoarding - heras fencing
- Handstanding for site deliveries / material storage
- Wheel wash location
- Traffic Marshal / Delivery Manager
- Noise monitor
- Water points
- Fuel storage

**Construction logistics – Modular cabin phase**

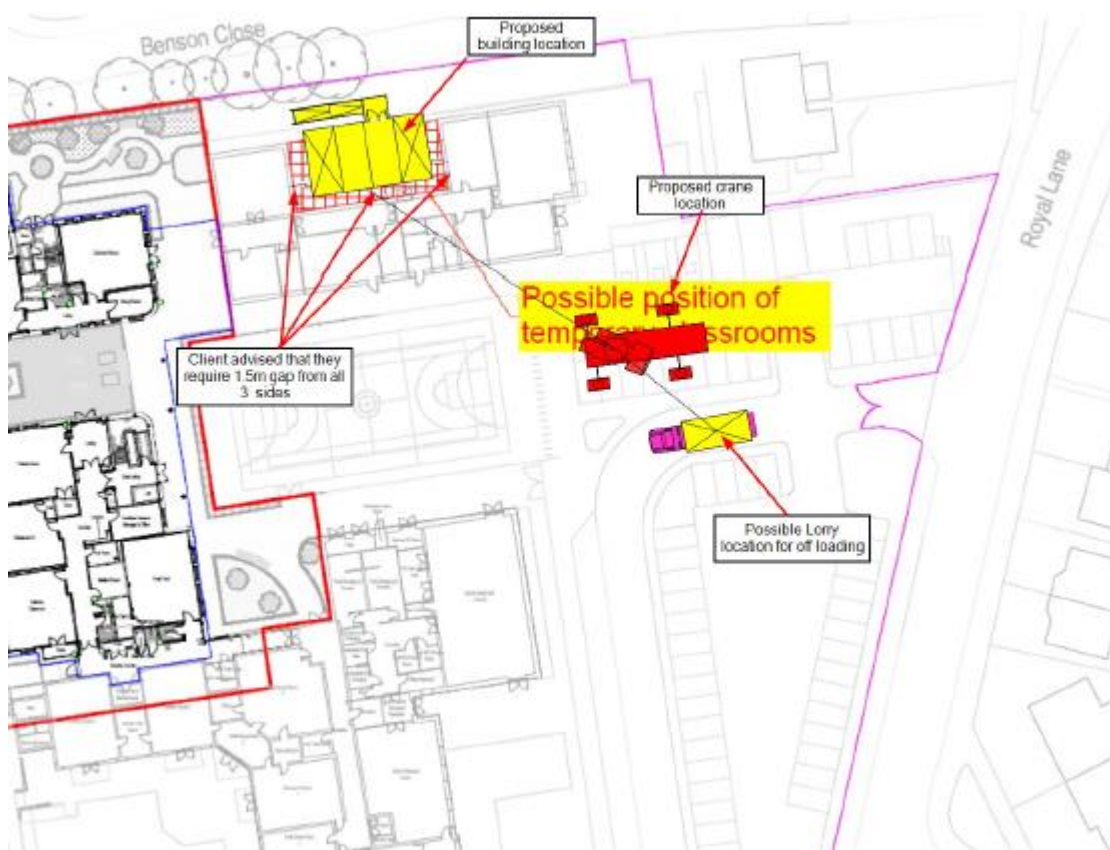

**Note: Modular installation expected to last 3 days. During installation work force and any other deliveries will continue to access main site via main site entrance on Peel way and use current welfare facilities.**