

Notes:

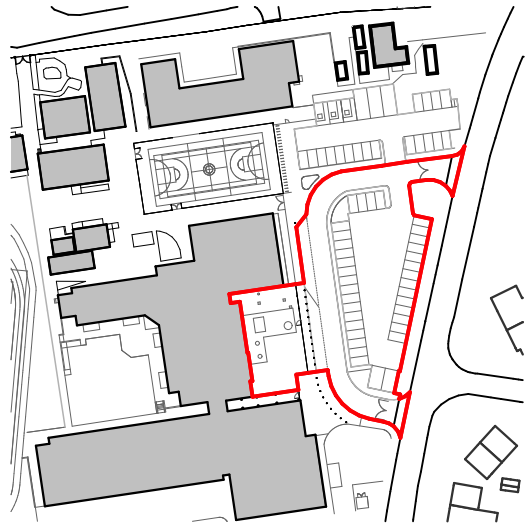

- 01 Teaching block
- 02 Library
- 03 Sports Hall
- 04 Mesh fence
- 05 Pedestrian gate
- 06 Play equipment
- 07 Safety surfacing
- 08 Black tarmac
- 09 Covered walkway
- 10 Pedestrian footpath
- 11 Car park drop off

B	14/02/2023	Revised red line	JH	RD
A	13/02/2023	PLANNING ISSUE	JH	RD
-	08/02/2023	Preliminary Issue	JH	RD
Rev	Date	Issue	Drawn	Check

## CDC Studio

Studio. 17 Comberton Rd, Cambridge CB23 7BA  
5-7 Tanner St, London, SE1 3LE  
info@cdcstudio.co.uk T. 01223 262413

**Project :**  
Meadow School Temporary Classrooms

**Client :**  
London Borough of Hillingdon

**Address :**  
Royal Ln Uxbridge UB8 3QU

**Date :** 08/02/2023  
**Scale @ A3 :** 1:100

**Drawing Title :**  
Existing Ground Floor Plan

**Drawing No. :** 4286 CDC XX 00 DR A (EX) 100  
**Rev. :** B

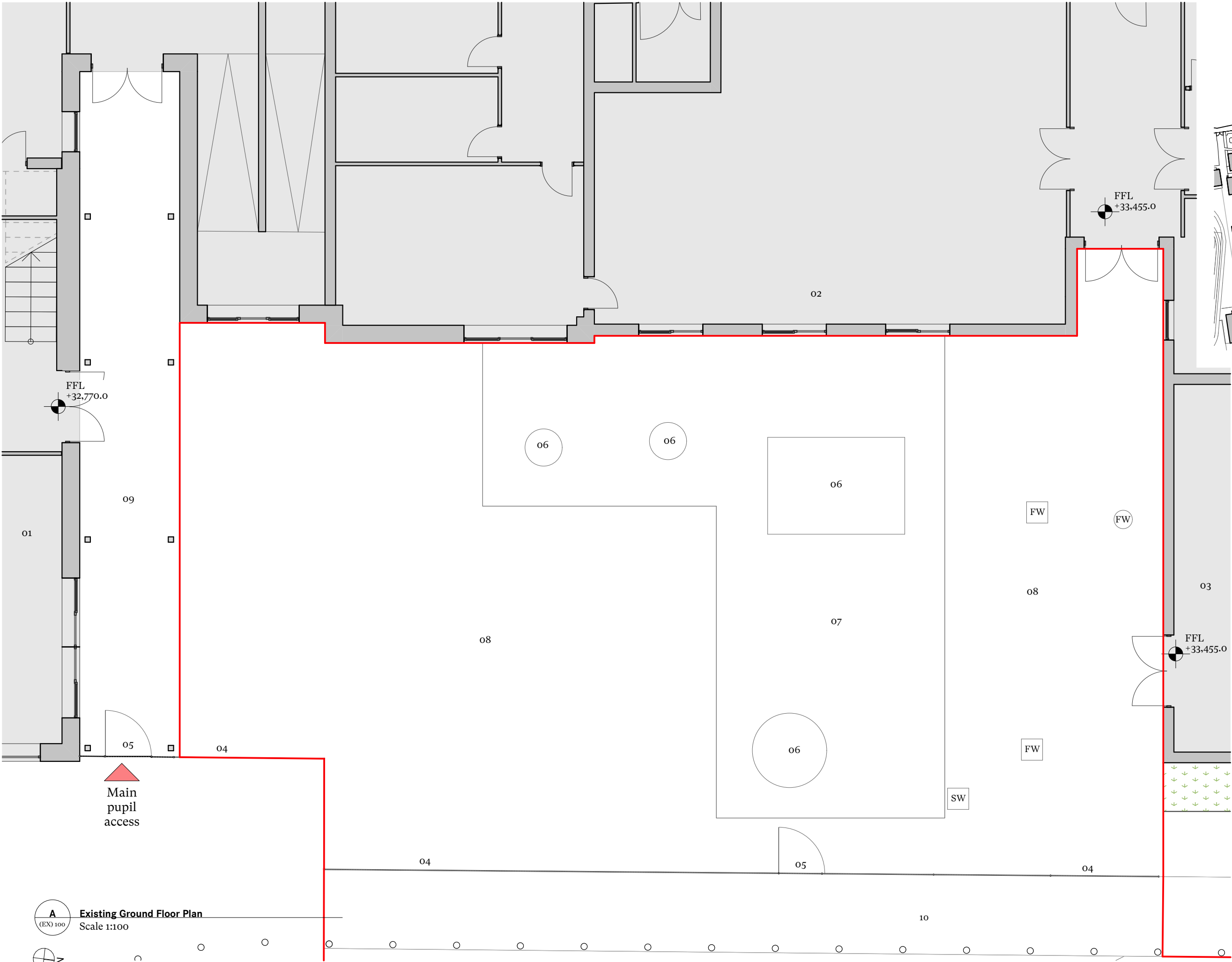

Note: Topographical survey not available for application area.  
Existing context based on Record Information provided by Meadow High School:  
MHS-POZ-01-GF-DR-A-2010 - Phase 2 - GA Proposed Ground Floor Plan-CR-Construction Record-Co3-o  
MHS-POZ-02-GF-DR-A-2021 - Phase 4 - EFAA EFAB EFAC Adaptations-CR-Construction Record-Co3-o  
MHS-POZ-03-GF-DR-A-2230 - Phase 4 - 5 - Ground Floor Fire Strategy-CR-Construction Record-Co4-o  
MHS-GIL-04-XX-DR-L-0102-0102 - Landscape General Arrangement-CR-Construction Record-Co4-o