

- Application Boundary
- Ownership Boundary
- Existing school building

- 01 Existing Science block
- 02 Existing Sports Hall block
- 03 Existing Sixth Form block
- 04 Corridor link to new teaching block
- 05 Covered external link and seating area, see landscape drawings
- 06 External seating area with accessible plant beds, see landscape drawings
- 07 External quiet sensory space, see landscape drawings
- 08 Existing sports field and running track
- 09 Existing Mixed-Use Games Area (MUGA)
- 10 Maintenance access to sports field via Peel Way
- 11 Existing incoming electrical cabinet
- 12 Proposed sprinkler tank with screening
- 13 Planted verge to boundary, see landscape drawings
- 14 Air source heat pump

A	13/01/2023	PLANNING SUBMISSION	JH	RD
-	12/12/2022	Facade Update	AK	RD
Rev	Date	Issue	Drawn	Check

CDC Studio

Studio, 17 Comberton Rd, Cambridge CB23 7BA
5-7 Tanner St, London, SE1 3LE
info@cdcstudio.co.uk T: 01223 262413

Project:
Meadow School New Building

Client:
London Borough of Hillingdon

Address:
Royal Ln Uxbridge UB8 3QU

Date:
12/12/2022

Scale @ A1:
1:100

Drawing Title:
Proposed Ground Floor Plan

Drawing No.:
4267 CDC XX GF DR A (GA) 102

Rev.:
A

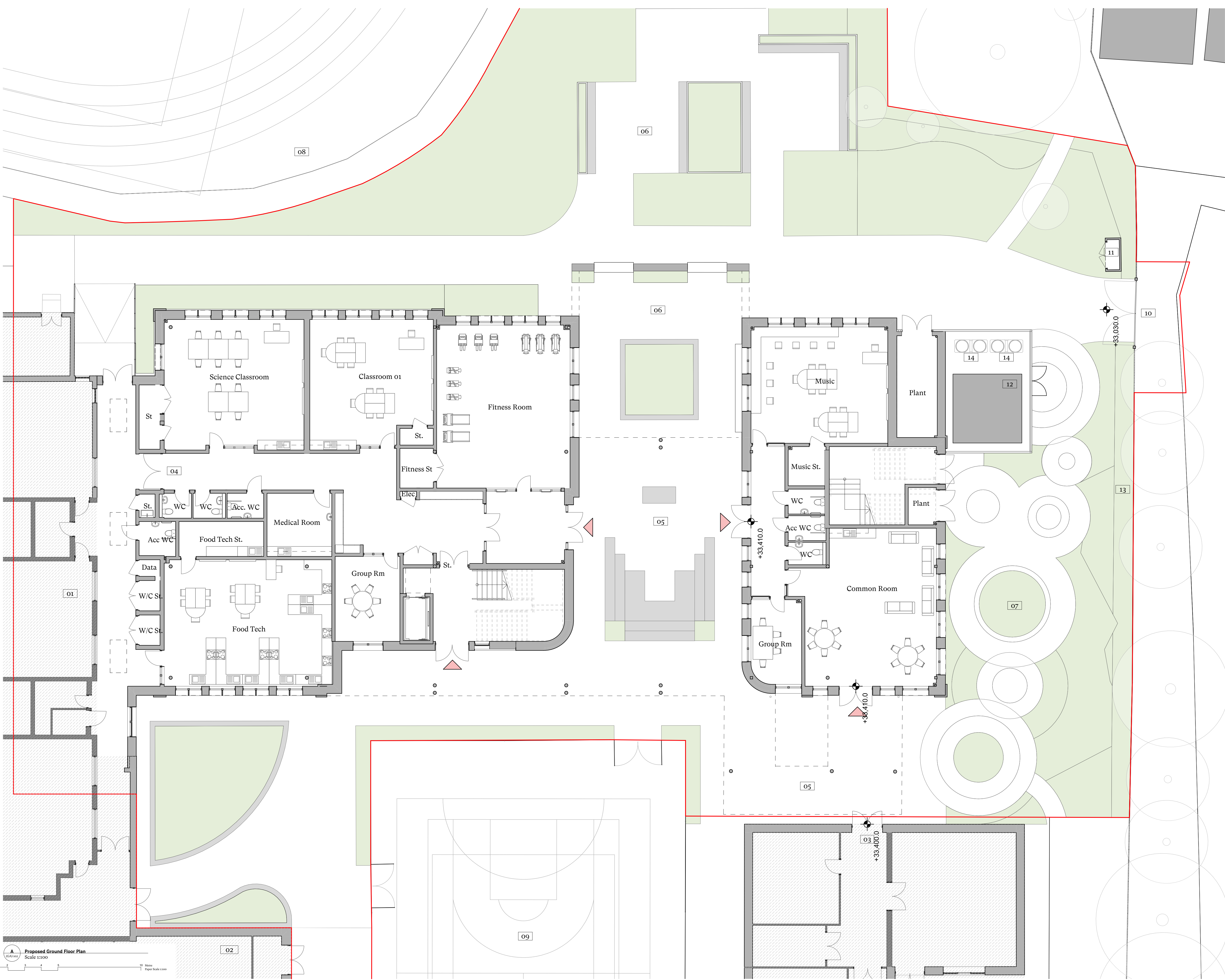

Proposed Ground Floor Plan
Scale 1:100