

- Key
- Demolition
 - Existing Structure
 - New Structure

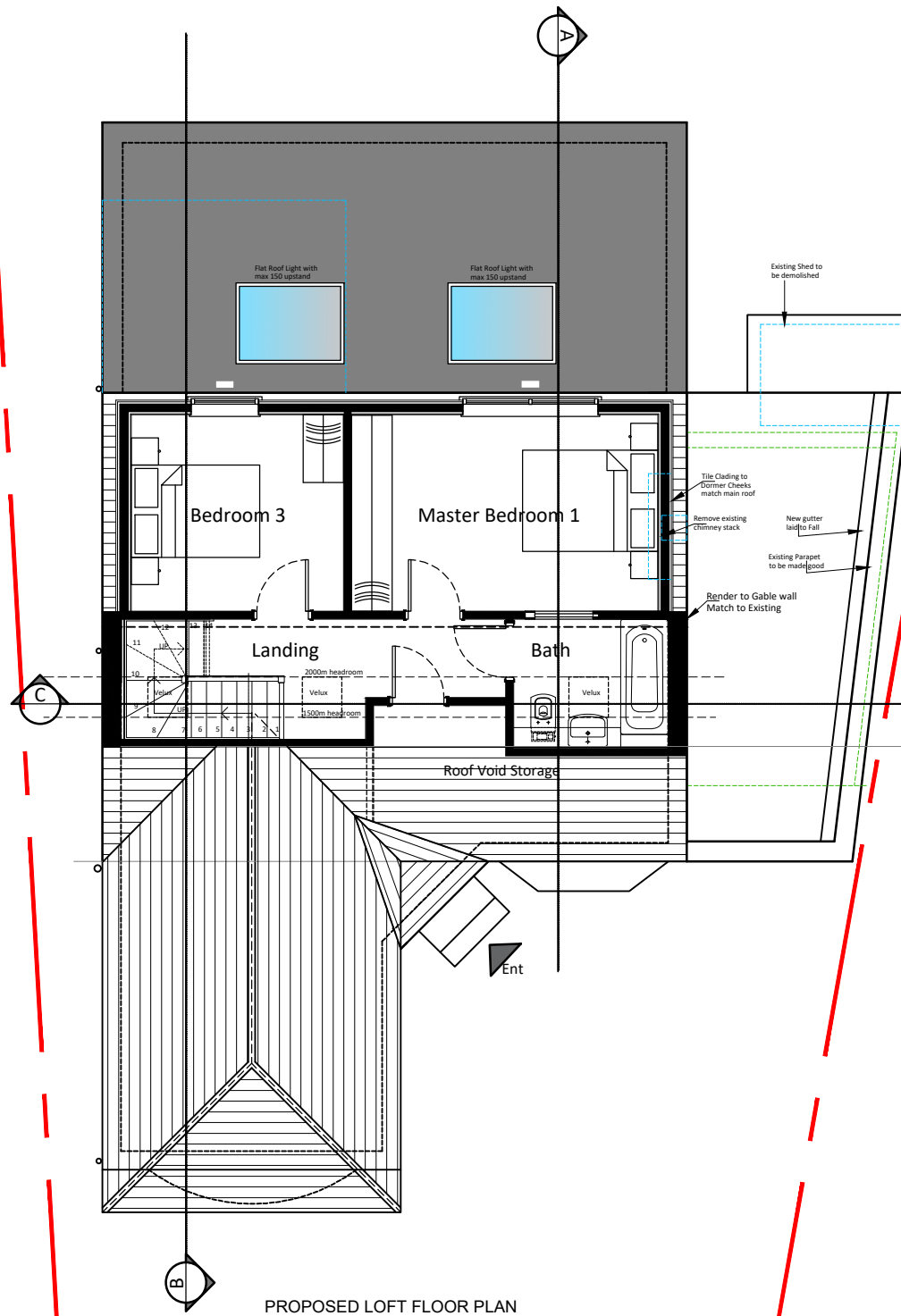

GENERAL NOTES			
Rev	Date	Description	By

Scale @ 1:100

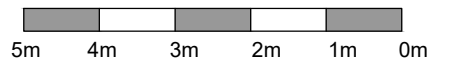

T: 07305 174448
E: info@rs2architects.co.uk
W: www.rs2architects.co.uk



85 Tottenham Court Road
London W1T 4TQ

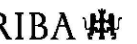

Client

Mr and Mrs Divakar

Project

34 Hillside Gardens Northwood
HA6 1RL

Drawing Title

Proposed Ground and Loft Plans

Drawn MH	Date Jun 2024	Scale @ A3 1:100
Job No 2024.004	Drawing No PL005	Revision

Planning

GENERAL NOTES

The Scheme Design and Proposals is subject to Town Planning and all other necessary consents. All feasibility studies are subject to full site survey. All dimensions, areas and levels given are only approximate and subject to site survey. All dimensions are to be checked on site. This drawing is to be read in conjunction with all other consultants and/or specialists drawings/documents and any discrepancies or variations are to be notified to the architects in writing before the affected work commences. Queries relating to design of structural element to be referred to the structural engineering consultant for confirmation and approval. The workmanship and materials and implementation to comply with the recommendations of British Standard (BS)8000 parts 1-16 inclusive and with Approved Document to support Regulation 7 1999 edition (incorporating 2000 amendments) of the Building Regulations 2010. All design and construction is to be in accordance with the Construction (Design and Management) Regulations 2015.

© RS2 Ltd

Note