

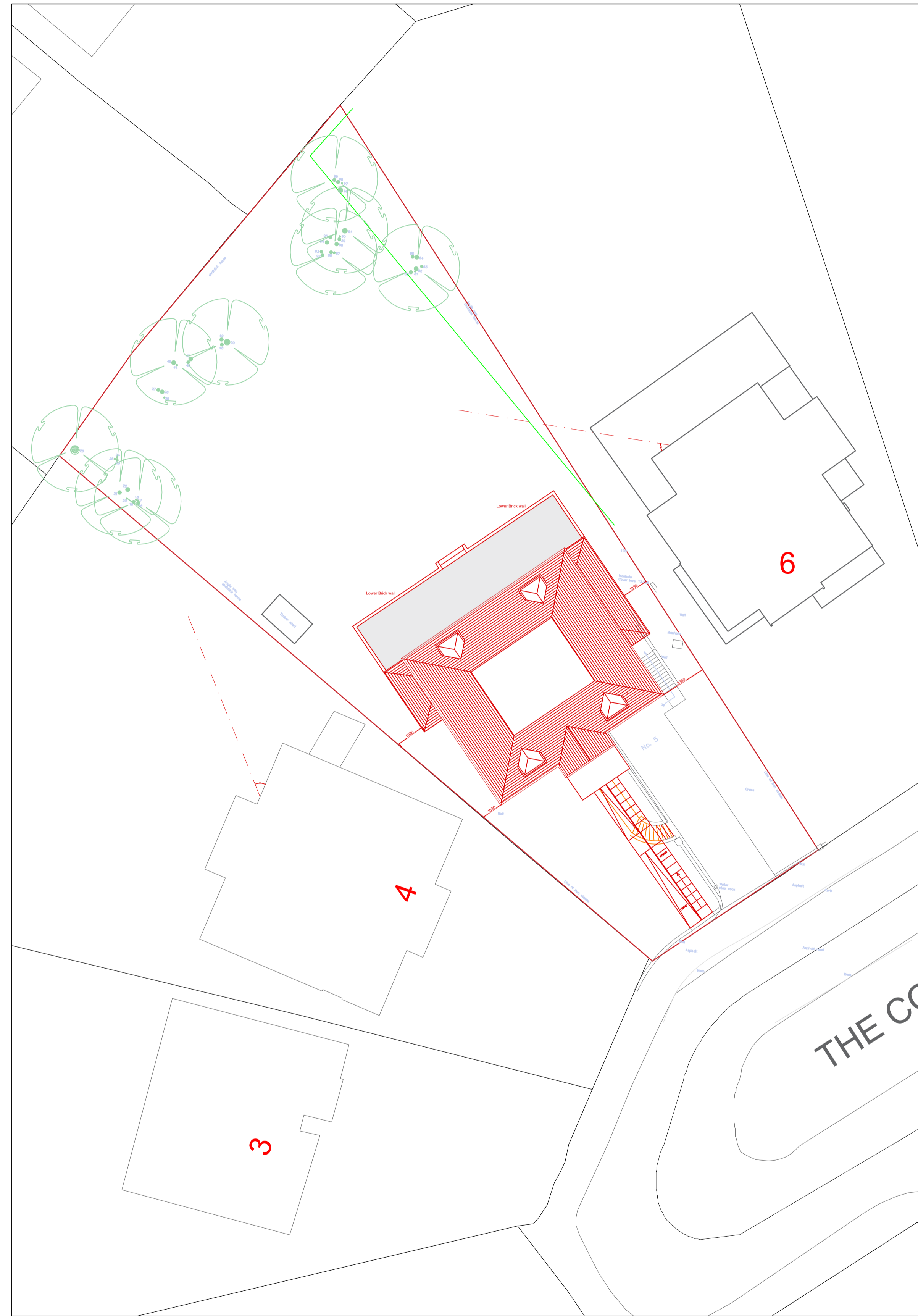

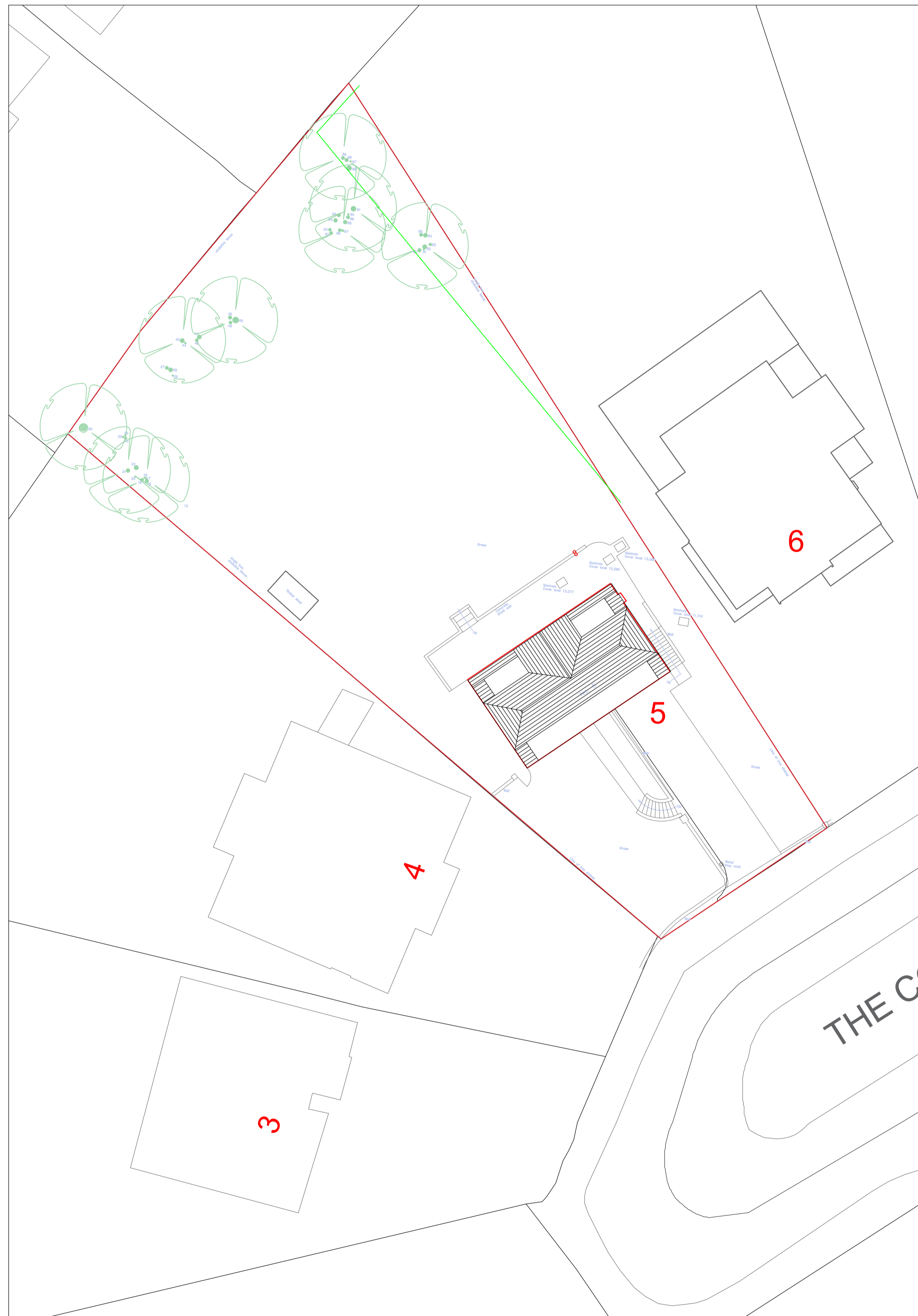

Amendments/Notes			
Rev.	Detail	By	Date
A	Minor amendments	AW	30.07.25
B	General amendments	CV	06.11.25
C	Front hardstand removed	CV	06.11.25
D	General updates	CV	12.01.26



KEY

	Removed
	Existing wall
	Proposed/New

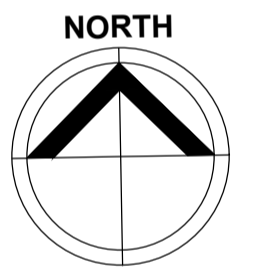

All dimensions and levels to be checked on site by contractor prior to preparation of shop drawings and commencement of work on site.  
 This drawing and the copyrights and patents therein are the property of the Architect and may not be used or reproduced without consent.  
 This drawing is to be read in conjunction with all relevant consultants and/or specialist's drawings/documents and any discrepancies or variations are to be notified to the Architect before the affected work commences.  
 All works on site are to be carried out fully in accordance with current CDM regulations and recommendations, current Building Regulations, British Standards and Codes of Practice as appropriate.

Project  
**5 THE COVERT  
 NORTHWOOD  
 HA6 2UD**

Drawing  
**EXISTING AND PROPOSED  
 SITE PLAN**

**SEABROOK  
 ARCHITECTS**  
 CHARTERED ARCHITECTS  
 Unit17, Chiltern Court, Ashridge Road,  
 Chesham, Bucks, HP5 2PX  
 Tel: 01494 778918  
 e-mail: info@gsarchitects.co.uk

Drawn By	AW	Date	07.07.25
Checked By	Checked by	Date	Checked date
Approved By	Approved	Scale	1:200@A1
Drawing No.	4629-PL001	Rev.	D



EXISTING SITE PLAN

PROPOSED SITE PLAN