

UNADOPTED REAR ACCESS

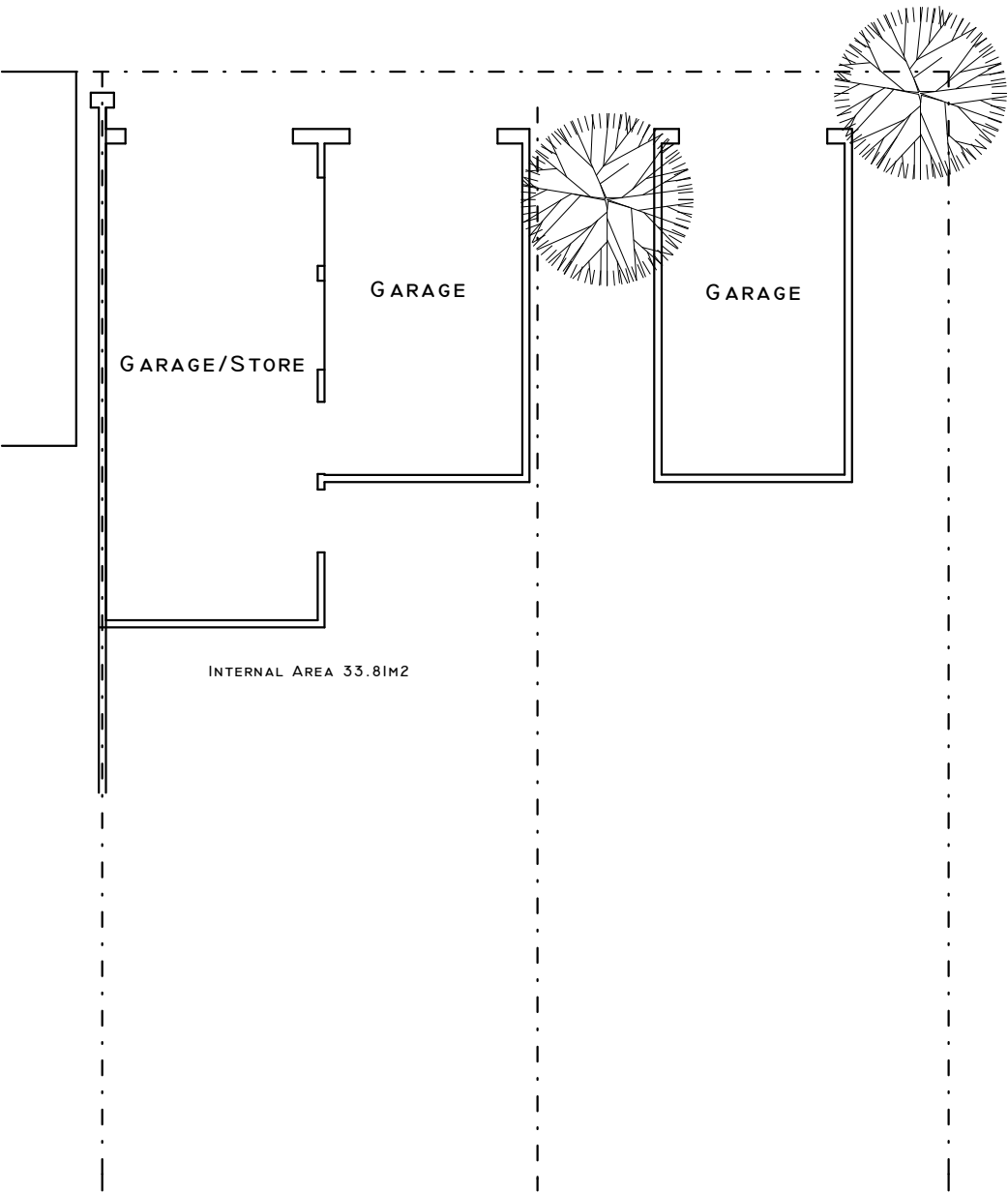

EXISTING PLAN

UNADOPTED REAR ACCESS

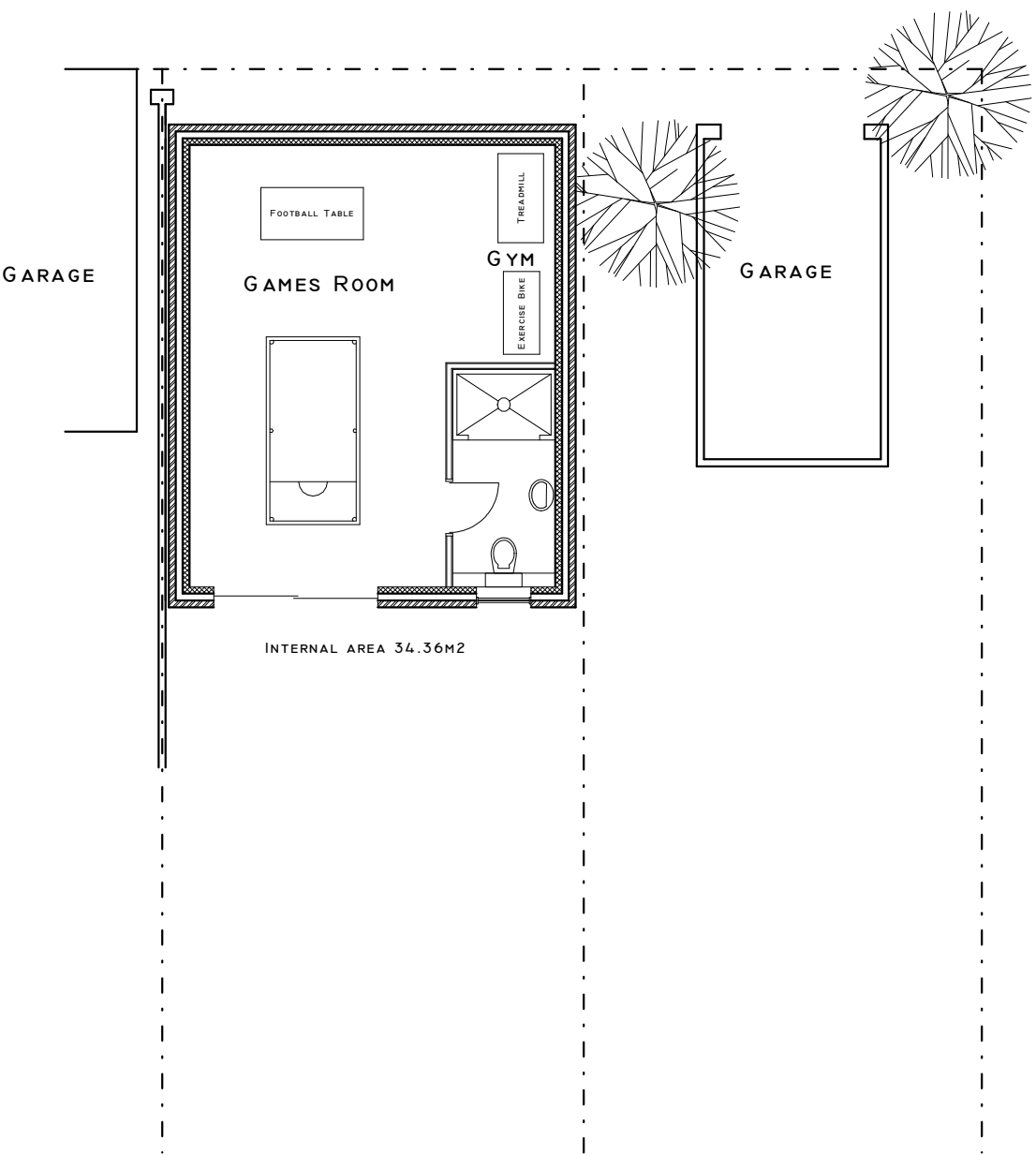

PROPOSED PLAN

21 PARKFIELD AVENUE
HILLINGDON
UB10 0DF

| | |
|--|--|
| | |
| REV A - INTERNAL WALLS FORMING GYM AREA REMOVED FROM PLANS | |
| | |
| | |
| | |
| | |
| | |
| | |
| | |
| | |

PLAN Plans and elevations
PROJECT

General Notes:
1. All dimensions to be checked on site prior to construction any discrepancies should be reported to the highford design.
2. All drawings are indicative of architects visual requirements only and show design intent only.
All this is a computer drawing scale of drawings can vary on printing check on site for setting-out.
Copyright: Highford Design 2016
This drawing should not be used to calculate areas for the purpose of valuations. All dimensions to be checked on site by contractor and such dimensions to be their responsibility. Do not scale drawing.

DWG No

01

Rev: - A

Date: April 2016
Project: 21 Parkfield Avenue
Scale 1:50 @ A1
Checked: AW
Drawing Title: Plans and Elevations
Status: Planning
Job No: 181

HIGHFORDDESIGN
27 BELLAMY CLOSE, ICKENHAM, MIDDLESEX, UB10 8SJ
email: info@highforddesign.co.uk - web: www.highforddesign.co.uk
telephone: 01895 622575 - mobile: 07557 390205