

UNADOPTED REAR ACCESS

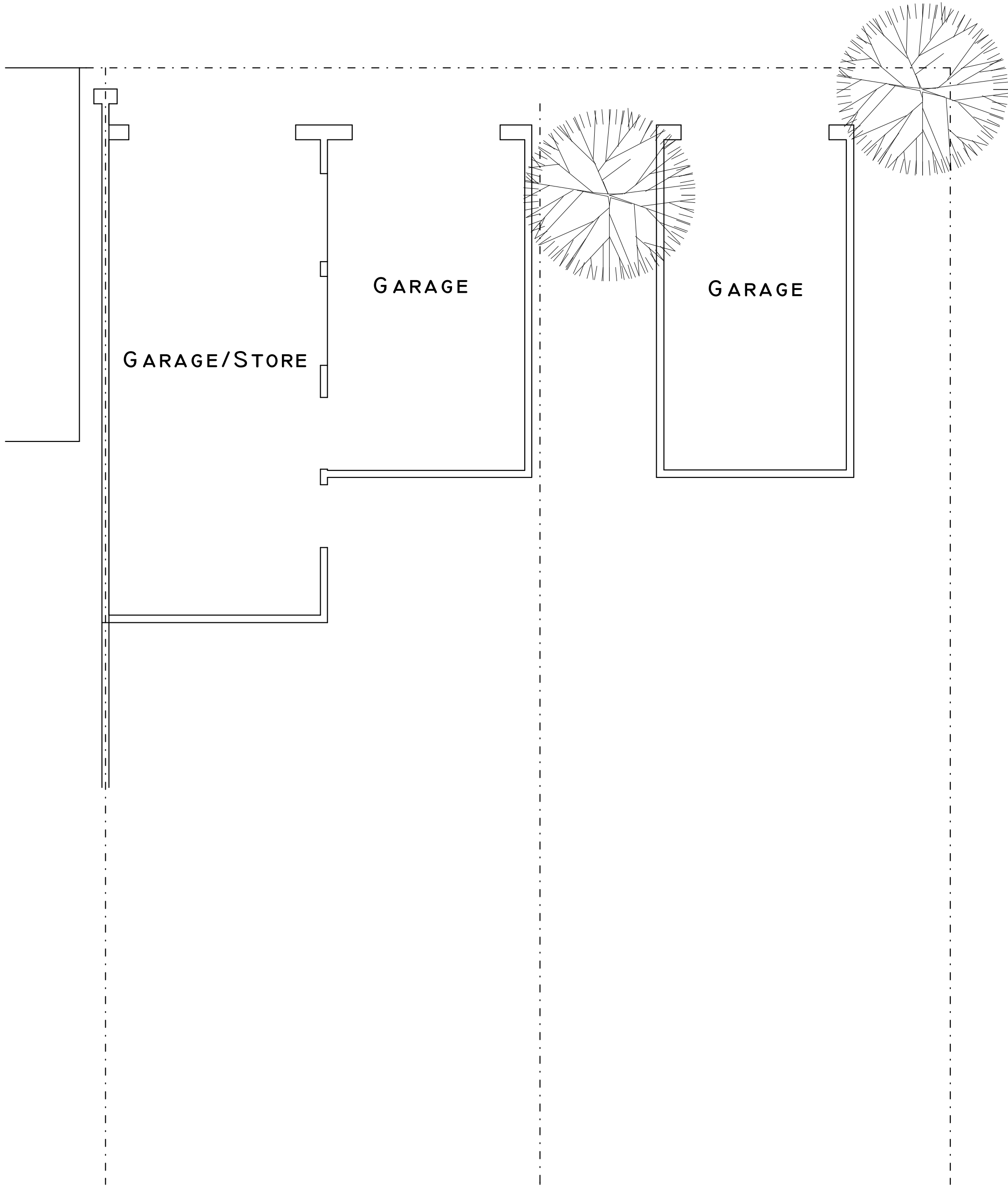

EXISTING PLAN

UNADOPTED REAR ACCESS

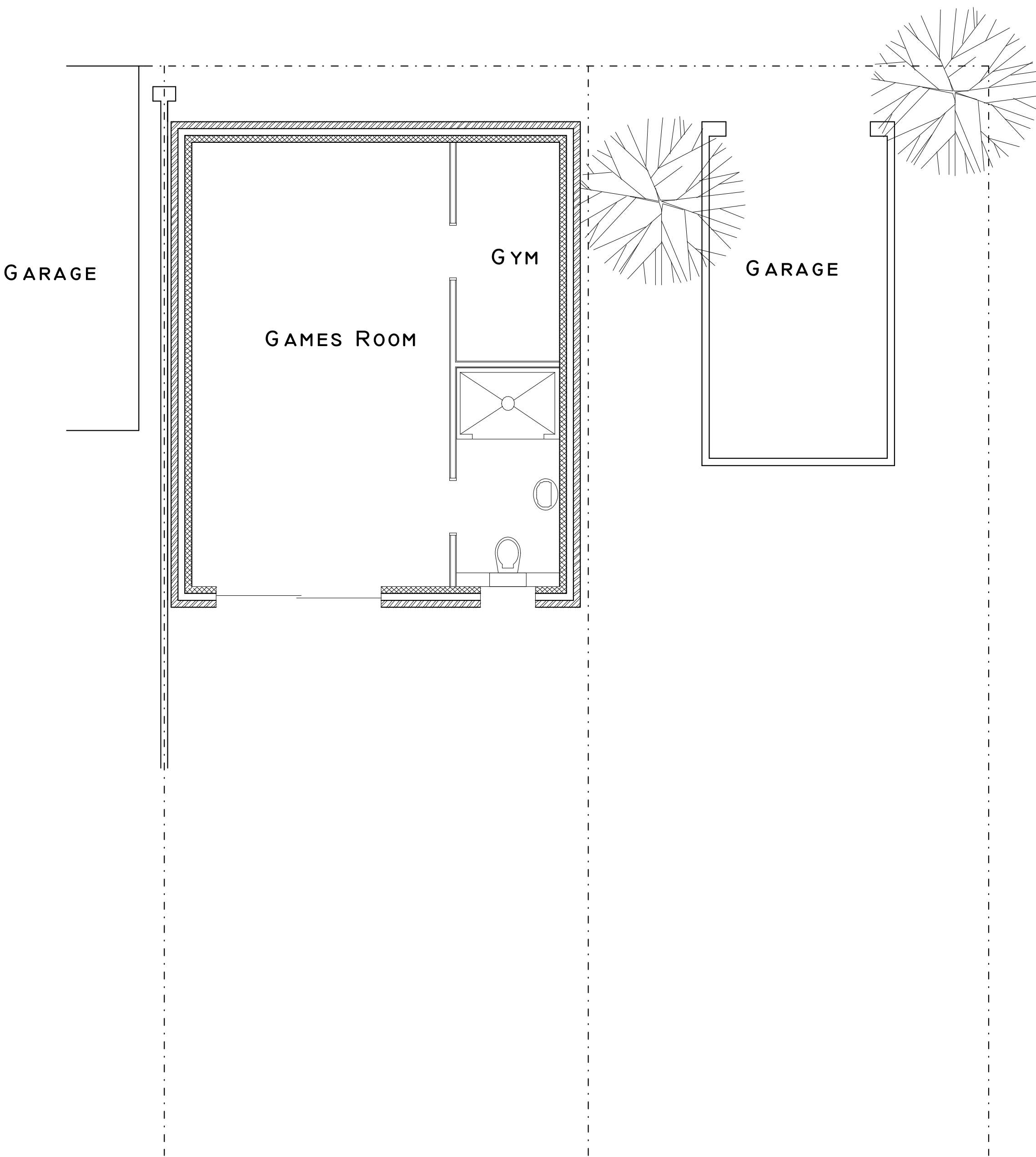

PROPOSED PLAN

17.28M2

21 PARKFIELD AVENUE
HILLINGDON
UB10 0DF

PLAN	Plans and elevations
PROJECT	
	<p>General Notes:</p> <p>1. All dimensions to be checked on site prior to construction any discrepancies should be reported to the highford design</p> <p>2. All drawings are indicative of architects visual requirements only and show design intent only</p> <p>As this is a computer drawing scale of drawings can vary on printing check on site for setting-out</p> <p>Copyright: Highford Design 2016</p> <p>This drawing should not be used to calculate areas for the purpose of valuations. All dimensions to be checked on site by contractor and such dimensions to be their responsibility. Do not scale drawing</p>

DWG No	
Date: April 2016	
Project: 21 Parkfield Avenue	
Scale 1:50 @ A1	
Checked: AW	
Drawing Title: Plans and Elevations	
Status: Planning	
Job No: 181	

01
Rev: -

HIGHFORDDESIGN
27 BELLAMY CLOSE, ICKENHAM, MIDDLESEX, UB10 8SJ
email: info@highforddesign.co.uk - web: www.highforddesign.co.uk
telephone: 01895 622575 - mobile: 07557 390205