

2nd Dimension

As the hooks are thrown by a circular action within the hook housing, it is imperative that there be sufficient room for this action to occur.

As a general rule there should be a 4mm gap between the lock faceplate and the face of either, the compression adjustment plate or the flat face of the hook keep where no adjuster is present (figure 4).

3rd Dimension

The curved face of the hooks¹ have been designed to come into contact with the inner edge of the hook keep or adjuster plate so as to offer compression of the door onto the gasket or sealing surface of the frame. Once again the keeps have been designed to suit specific applications, so any adjustment² made is purely to accommodate site or fitting tolerances (figure 4).

¹Winkhaus Cobra™ and Trulock™ brands

²Torx T-15 driver required

Figure 4

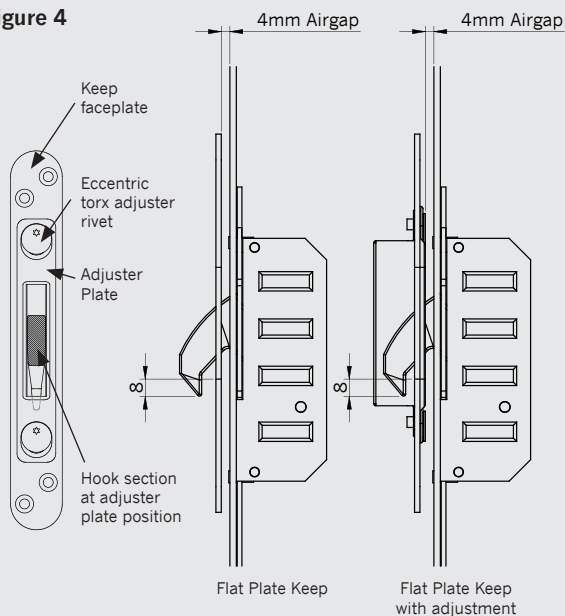

Maintenance and Lubrication Guide

Your door is designed to give you minimal maintenance, the requirement for maintenance is totally dependent on usage and environment.

We therefore recommend that a light application of PTFE spray be used into the apertures of the Hooks, Dead-bolt and latch and into both sides of the cylinder.

In normal usage Bi-annual application would be more than sufficient.

To prevent any damaging effect to the corrosion protection of Winkhaus fittings, only PER neutral cleaning and care agents should be used, which do not contain any abrasives.

Hallmark Group Products Ltd.

Valletta House, Valletta Street,
Kingston-upon-Hull, East Yorkshire
HU9 5NP

Tel: +44 (0)1482 781 111

www.hallmarkpanels.com

Always precise **WINKHAUS**

Door Installation Guide For Single Rebate Composite And Timber Doors



United
Kingdom

 **Hallmark
Panels Ltd**

Door Installation Guide For Single Rebate Composite And Timber Doors

Many problems experienced today with prefabricated door-sets can be due to incorrect installation. Below are a few tips to aid installation and enhance the operation and performance of the door-set thereby helping to promote years of trouble free operation.

Tips

- ✓ Check aperture size against the door set. It is recommended that there be at least a 5mm gap all the way around the frame to enable correct installation.
- ✓ Place a 5mm packer beneath both sides of the door where the frame is to sit (figure 1).
- ✓ Place the door and frame in position and open the door leaf to 90 deg. Position a suitable packer beneath the opening edge of the door leaf to bring the hinge side of the frame plumb.
- ✓ Using suitable fixings, fix the hinge side of the door-set checking for plumb in both planes. (Fixings should be placed at approximately 150mm from the frame corners using 4 or 5 equally spaced). Make sure with a long straight edge that there is no bow, again in both planes. Increase or decrease packing where necessary (figure 1).

Figure 1

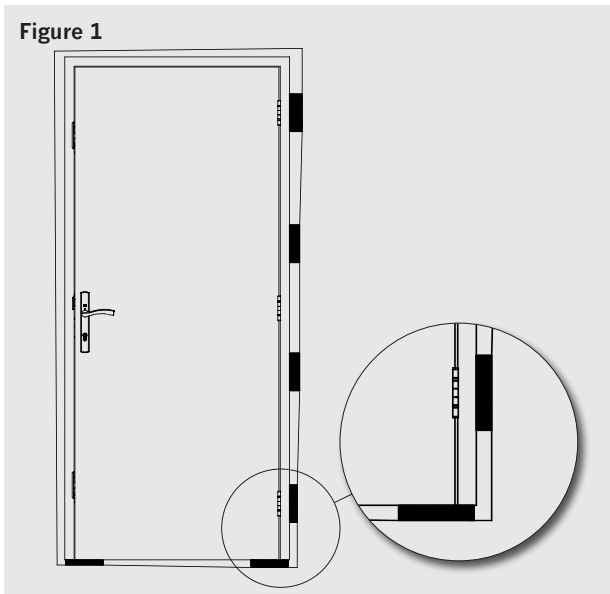

- ✓ At this stage bring the door leaf to the closed position and adjust the packing beneath the frame lock-side to achieve a consistent gap between the leaf and frame at the top and bottom of the leaf.
- ✓ As a guide align the bottom edge of the latch strike to the line on the lock face-plate below the latch.
- ✓ Fix the frame at the top of the lock side first.
- ✓ Next bring the door leaf to the almost closed position and align the frame at the next fixing point so as to achieve an even gap as shown, repeat this at every fixing point so as to accommodate any bow or twist in the door leaf.
- ✓ When all fixings are made bring the door leaf to the closed position DO NOT ATTEMPT TO OPERATE THE LOCK UNTIL THE FOLLOWING HAS BEEN CARRIED OUT! Check and adjust the packing behind the fixings to achieve a consistent 4mm gap between the face of the lock and the face of the keeps (figure 2).
- ✓ Finally pack or point beneath the cill, and seal to Brick-work around the frame.

Figure 2

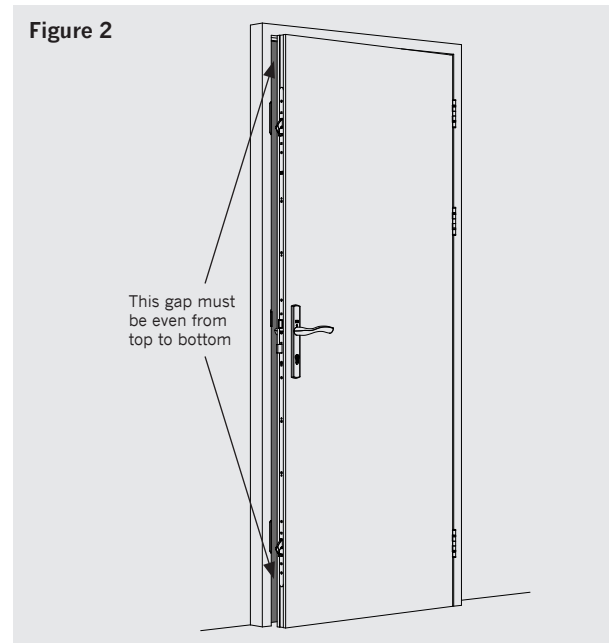

Winkhaus Multi-point Lock Guide

1st Dimension

Winkhaus full length keep sets are self-aligning so if correctly installed should not need moving up or down. However, a visual check of alignment is as below. The centre line of the lock face-plate should correspond with the line with the strike on timber / composite keep (figure 3).

Winkhaus single pocket keeps again should not need adjustment up or down once correctly fitted. A simple check for the hook keeps is as follows; throw the hooks with the door open and mark the tip of the thrown hook on the face of the door frame ensuring that the tip of each hook is no more than 8mm below the aperture of the hook keep (figure 4).

Figure 3

