

TRIMMER T1 :2NO.50x200 C24 GRADE TIMBER
 TRIMMER T2 :2NO.50x200 C24 GRADE TIMBER
 BEAM R1 :152x152x37UC ON 100x450x215 PADS
 BEAM C1, C2 :152x152x30 UC CONNECTED TO BEAM F1 AND F2
 WITH 2NO.90x90x8 ANGLE CLEATS AND 6M12 BOLTS
 BEAM F1,F2,F3 :203x203x52 UC ON 100x600x20 PLATES

DOUBLE UP RAFTERS AROUND ROOF LIGHTS

DOOR FRAMES RECEIVING FD30 DOORS ARE TO HAVE 25x25MM
 DOOR STOPS AND FD30 DOORS ARE TO BE HUNG ON 3NO.
 HEAVY DUTY STEEL HINGES

LEAD FLASHING TO HAVE 150MM UPSTAND

DORMER TILES TO BE PLAIN CONCRETE

WINDOW AREA TO BE 1/10TH OF THE FLOOR
 AREA AND OPENABLE AREA EQUAL TO 1/20TH
 OF THE FLOOR AREA

COPYRIGHT
 CONTRACTOR MUST CONFIRM SITE DIMENSIONS BEFORE COMMENCEMENT
 OF WORK.
 THIS DRAWING OR DESIGN IS THE COPYRIGHT AND MAY NOT BE
 REPRODUCED WITHOUT WRITTEN CONSENT OF THE DESIGNER.
 CONTRACTOR RESPONSIBLE FOR CORRECT SETTING OUT ON SITE. ANY
 DISCREPANCIES TO BE NOTED TO THE DESIGNER IMMEDIATELY.

| MARKED | REVISION | DATE |
|--------|----------|------|
| | | |
| | | |
| | | |
| | | |

FLOOR JOISTS TO BE WEDGED TIGHT INTO NEW STEEL SUPPORTS

BOLT TOGETHER DOUBLE JOISTS / RAFTERS WITH M10 BOLTS
 WITH 50 DIA TOOHE PLATE CONNECTORS AND WASHERS AT 900 C/C

STEEL BEAMS TO BE PAINTED WITH INTUMASCANT PAINT -
 TO MANUFACTURERS INSTRUCTIONS

ALL NEW WINDOWS TO BE DOUBLE GLAZED WITH TOUGHENED GLASS
 TO BS 6206, IF WITHIN 800MM OF FLOOR

ALL INTERNAL STUD WALLS BETWEEN THE W.C./BEDROOM AND
 STAIRS TO BE FILLED WITH 100MM MINERAL WOOL
 DENSITY 15KG/M3

STUD WALLS TO STAIRS ENCLOSURE TO BE HALF HOUR FIRE
 RESISTING 50x100 STUDS AT 400c/c VERTICALLY AND
 HORIZONTALLY LINE BOTH SIDES WITH 12.5MM PLASTER BOARD
 AND SKIM, FILL VOIDS WITH 100MM MINERAL WOOL DENSITY 15KG/M3

SOFFIT OF NEW STAIRS TO BE LINED WITH 12.5MM PLASTER
 BOARD AND SKIM

PROVIDE CODE 4 LEAD FLASHING BETWEEN THE DORMER CHEEKS
 AND THE ROOF

BASIN AND SHOWER WASTE TO BE 38MM WITH 75MM UPVC DEEP
 SEAL TRAP, W.C. TO HAVE TURNED P TRAP MULTIKWIK
 CONNECTOR-DISCHARGE INTO THE EXISTING SOIL AND VENT PIPE,
 IN ACCORDANCE WITH BS5572

PROVIDE RODDING ACCESS IN WASTE PIPES AT CHANGE IN DIRECTION

PROVIDE ELECTRIC FAN TO W.C./SHOWER ROOM TO GIVE
 15 LITRES PER SECOND AIR EXTRACT RATE WITH 15 MINUTE
 TIMER

PROVIDE AT EACH LANDING SELF CONTAINED SMOKE
 DETACTORS PERMANANTLY WIRED TO A SEPARATELY
 FUSED CIRCUIT AT THE DISTRIBUTION BOARD WITH
 BATTERY BACK UP,
 SMOKE ALARMS TO BE LINKED AND DENOTED THUS:- Ø
 SMOKE ALARMS TO COMPLY WITH BS 5446;PART 1

ANCHOR GABLE WALLS TO ROOF AND FLOOR
 JOISTS WITH 30x5x1200 LONG GALVANISED MILD
 STEEL STARPS AT 1200 C/C

STEEL BEAMS TO AVOID BEARING ON TO BRICK WORK THAT
 PREVIOUSLY FORMED PART OF THE CHIMNEY BREAST

PROVIDE 10MM GAP TO WC DOOR FOR AIR INTAKE

FLUSHING DEVICES TO W.C. TO BE PROVIDED WITH PROVISION
 OF WHOLESOME WATER FROM THE MAINS

BASIN/SHOWER TO BE PROVIDED WITH HEATED WHOLESOME
 WATER OR SOFTENED WATER

ALL ELEMENTS OF HOT WATER SYSTEM TO BE DESIGNED,
 CONSTRUCTED AND INSTALLED TO RESIST EFFECTS OF
 TEMPERATURE DURING NORMAL USE AND IN THE EVENT OF A
 MALFUNCTION. SYSTEM TO BE ADEQUATELY SUPPORTED AND
 COMPLY WITH APPROVED DOCUMENT G (G3)

HOT WATER STORAGE VESSEL REQUIRES PRECAUTIONS TO
 PREVENT WATER EXCEEDING 100 DEGREES C. SAFTEY
 DEVICES TO DISCHARGE TO A SUITABLE PLACE OF SAFTEY
 TO PREVENT INJURY TO PEOPLE
 DOUBLE UP FLOOR JOISTS UNDER STUD PARTITIONS
 AND BOLT TOGETHER WITH 10MM BOLTS AT 600c/c

PROVIDE ACCESS FOR RODDING AT BASE OF ALL STACKS

HOT WATER STORAGE VESSEL REQUIRES PRECAUTIONS TO
 PREVENT WATER EXCEEDING 100 DEGREES C. SAFTEY
 DEVICES TO DISCHARGE TO A SUITABLE PLACE OF SAFTEY
 TO PREVENT INJURY TO PEOPLE

PROVIDE 8000MM2 BACKGROUND VENTILATION
 TO NEW LOFT ROOMS, VIA TRICKLE VENTS
 IN WINDOWS

PROVIDE 10MM GAP TO WC DOOR FOR AIR
 INTAKE

DOUBLE UP FLOOR JOISTS UNDER STUD
 PARTITIONS AND BOLT TOGETHER WITH 10MM
 BOLTS AT 600c/c

PROVIDE ACCESS FOR RODDING AT BASE OF
 ALL STACKS

BEAM F1/F2 AND
 THEIR BEARING
 NOT TO TAKE
 SUPPORT ONTO
 MASONARY
 FORMING PART
 OF THE CHIMNEY
 BREAST

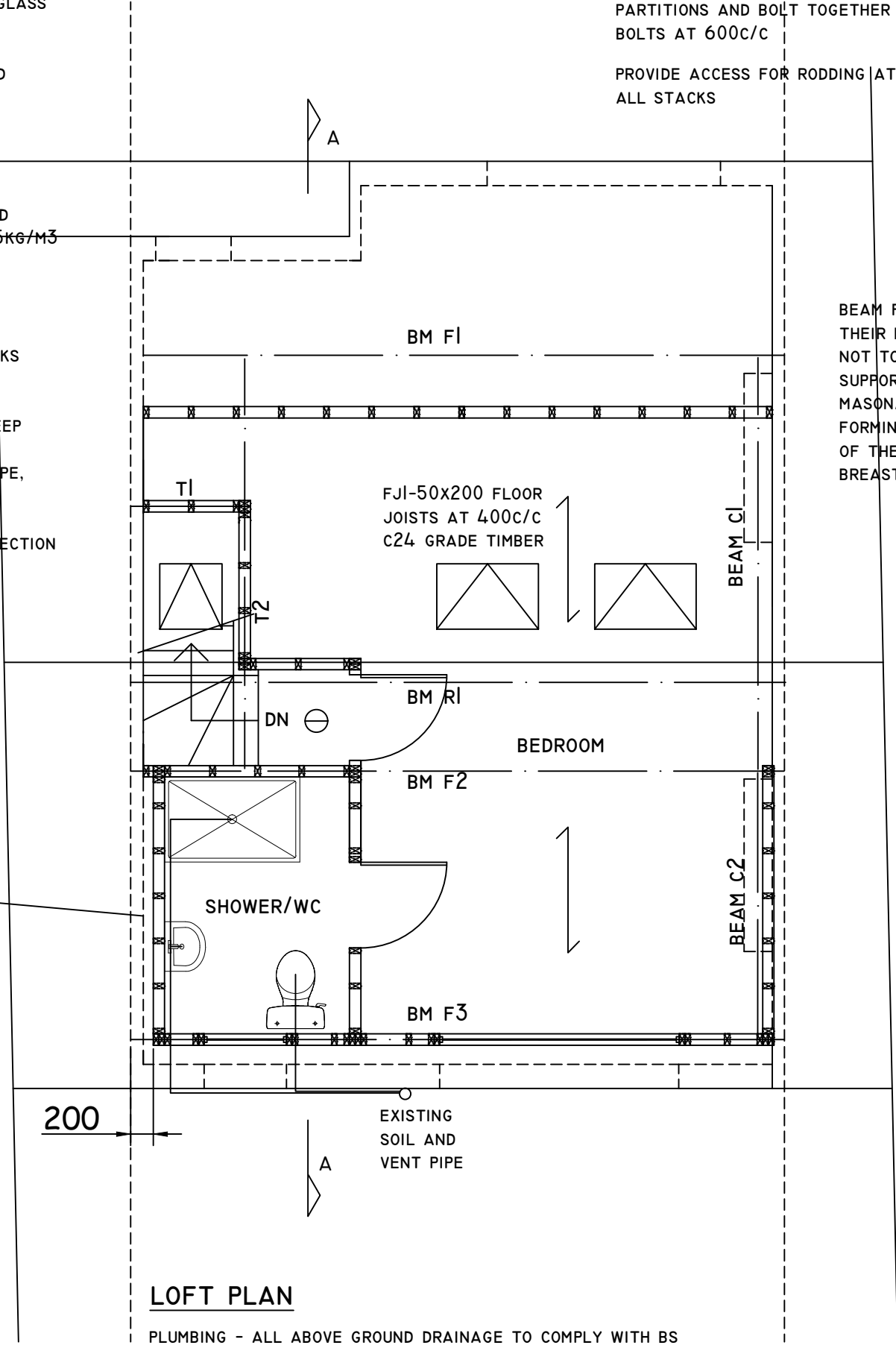

LOFT PLAN

PLUMBING - ALL ABOVE GROUND DRAINAGE TO COMPLY WITH BS
 5572. BASIN/SHOWER - 32MM SLOTTED WASTE AND
 CHAIN WITH PLUG, 75MM UPVC DEEP SEAL TRAP
 W.C. - TURNED P TRAP, MULTIKWIK CONNECTOR
 W.C. WASTE TO RUN SEPARATELY TO THE SOIL AND VENT PIPE
 FROM OTHER WASTES

PROVIDE RODDING ACCESS AT CHANGE IN DIRECTION OF WASTE
 PIPES

W.C. TO HAVE MECHANICAL VENTILATION VIA ELECTRICALLY
 OPERATED FAN TO GIVE 15 LITRES PER SECOND AIR EXTRACT
 FITTED WITH 15MINUTE TIMER AND DUCTED TO OUTSIDE

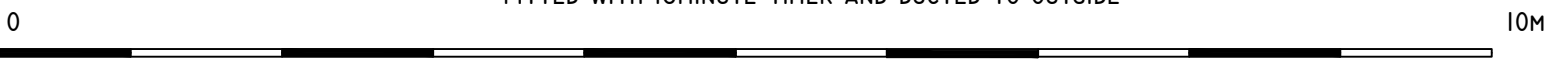

| | |
|------------------------------|----------------|
| CHECKED: | DATE: FEB 2026 |
| DRAWN: | SCALE: 1:50 |
| DRAWING NUMBER: L3 | |

DRAWING TITLE:
PROPOSED LOFT PLAN

PROJECT:
**57 GRANVILLE ROAD
 HILLINGDON
 UB10 9AE**