

LEVEL MONITORING

for SMS (AVI, PRE)

4 Theodora Way, Pinner, HA5 2RA

Client:	SMS (AVI, PRE)
Client Contact:	Ian Domigan
Claim Number:	4502041027
Client Reference:	IFS-AVI-SUB-22-0102007
Policy Holder:	Mr Alan Hutchinson
Report Date:	12 August 2024
Our Ref:	M21369

Level Monitoring Readings

The following table shows the reading levels of the various Level Monitoring Station points.

Date	1	2	3	4	5	6	7
23/05/2023	11.1691	10.9775	10.7948	11.0966	11.0908	11.0969	11.0853
14/07/2023	11.1691	10.9768	10.7937	11.0944	11.0890	11.0945	11.0834
01/09/2023	11.1691	10.9771	10.7949	11.0942	11.0884	11.0941	11.0829
26/10/2023	11.1691	10.9772	10.7959	11.0942	11.0884	11.0939	11.0828
04/01/2024	11.1708	10.9791	10.8006	11.0974	11.0914	11.0966	11.0853
23/02/2024	11.1702	10.9786	10.8017	11.0976	11.0912	11.0964	11.0851
16/04/2024	11.1705	10.9788	10.8027	11.0982	11.0915	11.0968	11.0855
19/06/2024	11.1714	10.9801	10.8053	11.0997	11.0935	11.0985	11.0868
09/08/2024	11.1717	10.9802	10.8049	11.0989	11.0924	11.0973	11.0860

Level Monitoring Difference Graphs

The following graphs display the progressive movement that each Level Monitoring Station recorded at each separate site visit date to give an overall look at how much the property is moving.

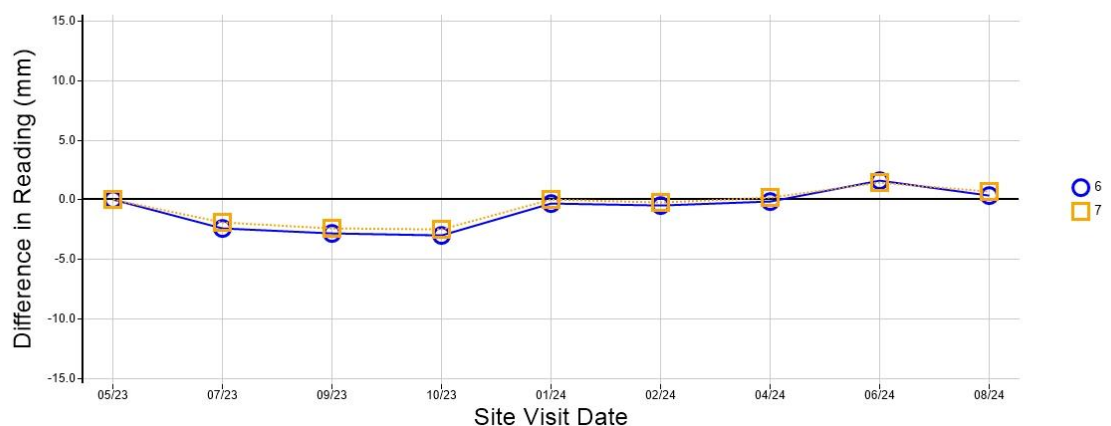
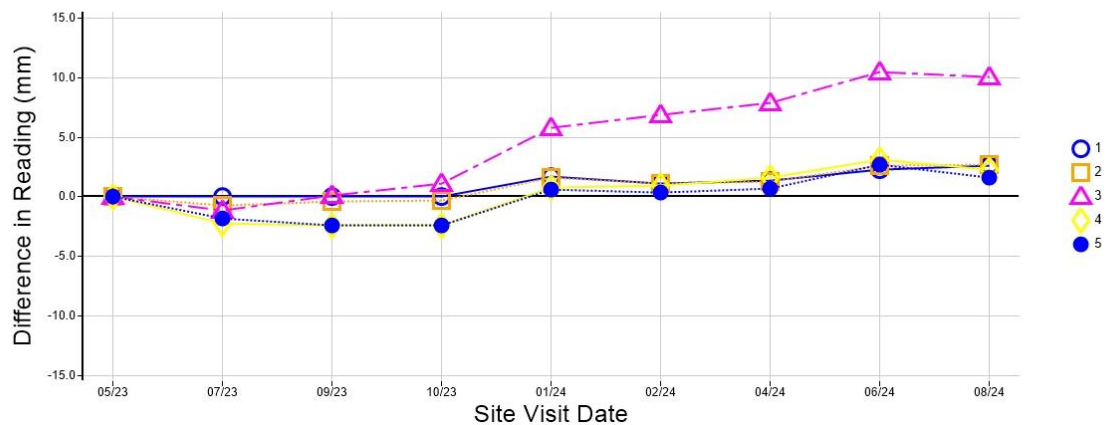

Level Monitoring Displacement Map

The following image shows an isometric representation of the movement of the property, based on the Level Monitoring Stations that were installed.

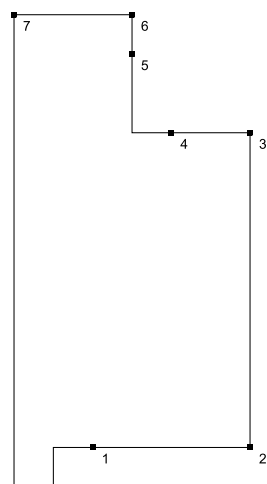
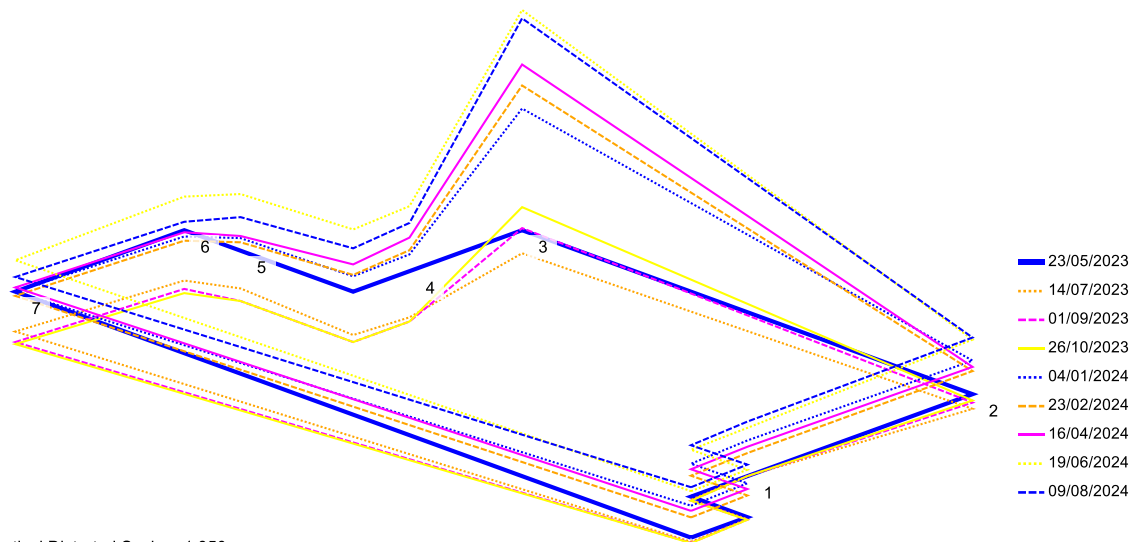

FRONT

Site Visit Notes

TBM is a gully to front of property in road. If this is not suitable, please advise if a deep datum is required.