

1. Scale this drawing for Planning Purposes only
2. Do not scale for working drawings all dimensions shall be checked on site prior to commencing the works and any errors or admissions reported to the Architect
3. This drawing is the copyright of POQ Architects and must not be used or reproduced without their permission

Existing Gross Internal Area (GIA)

126m2 (GF House)
073m2 (1F House)
026m2 (2F House)
225m2 Total GIA

Proposed Gross Internal Area (GIA)

150m2 (GF House)
073m2 (1F House)
026m2 (2F House)
249m2 Total GIA

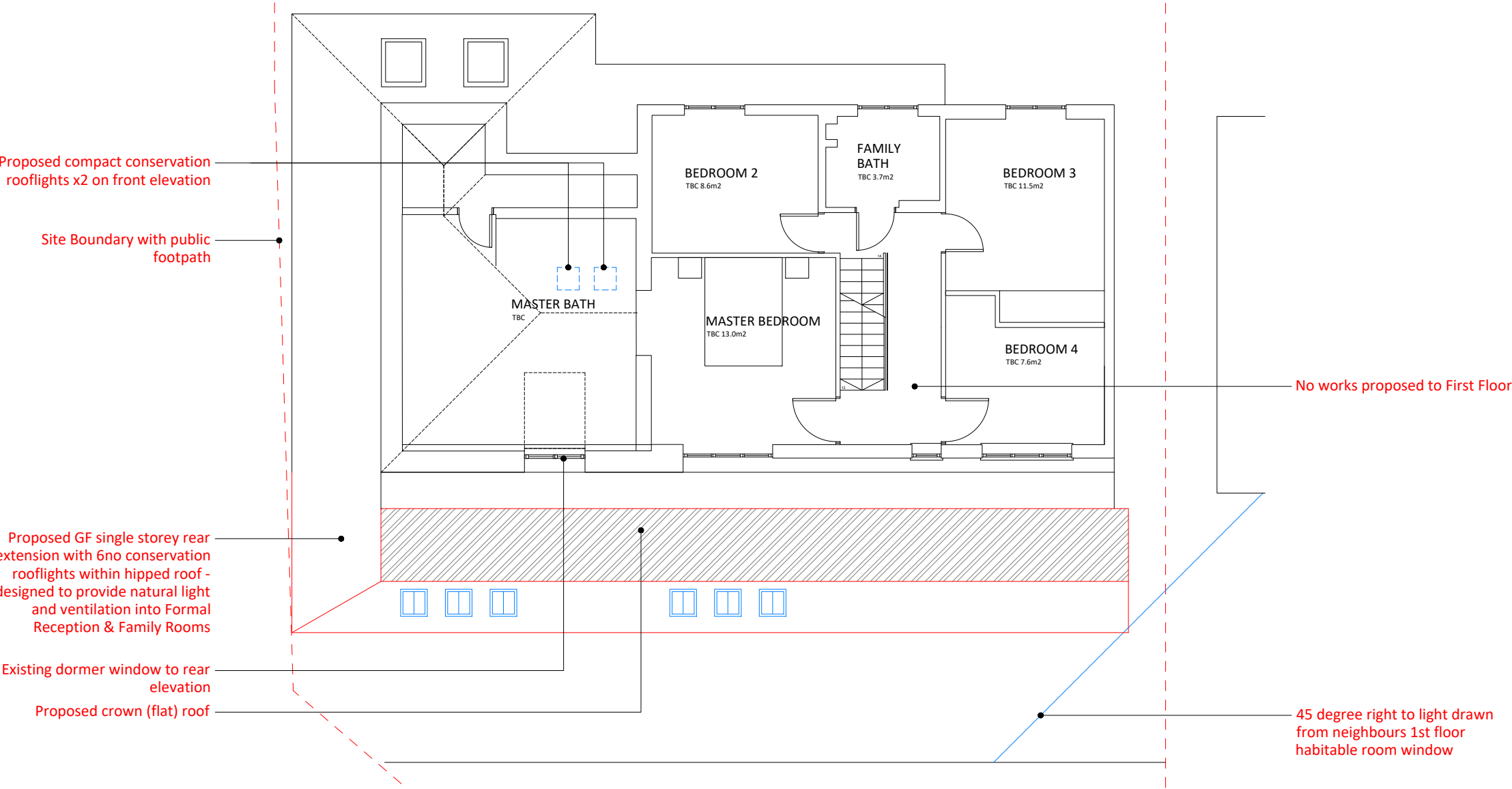

PROPOSED FIRST FLOOR GA PLAN



P10	HAv2 updated issue	26.07.22
P09	HAv2 revised issue	20.07.22
P08	HAv2 Final Issue	13.05.22
P07	HAv2 Updated Issue	27.04.22
P06	HAv2 Issue	27.04.22

Client:
Mr Wijesuriya

Project:
1 Kings Close
Northwood
HA6 3SB

Date:
01.01.22

Scale:
1:100 @A3

Drawing title:
PROPOSED 1F GA PLAN

Drawing number: Revision:

161/101 P10

POQ Architects, The Old PC, Rudolph Road, Bushey WD23 3DU
T: +44 (0)20 8950 1463

